BERTAZZONI OTR

30" OVER THE RANGE MICROWAVE KO 30 PRO X



This 1.5 cubic-foot microwave is cleverly designed to be located above the cooktop or range, saving countertop space and acting as a ventilation hood as well.

Styled to match with the Bertazzoni built-in Design Series and Professional Series, it is finished in stainless steel with a black glass door.

The oven has 11 power levels and controls that include pre-set functions, cooking timer and sensor controls for reheat, defrost and cook. The control display features white digits on a black background. The oven is equipped with a child safety lock.



TO COOK BEAUTIFULLY

BERTAZZONI OTR

30" OVER THE RANGE MICROWAVE KO 30 PRO X

FEATURES

Power levels	11
Preset cooking modes function	yes
Sensor reheat, defrost, cook	yes
Child lock	yes
Oven max power	1000W
Ventilation power	300 cfm

TECHNICAL SPECIFICATIONS

Electrical Requirements	120V, 60 Hz
Capacity	1.5 ft ³
Turn table	yes
Turntable diameter	14" ¹ / ₈
Product weight	85 lbs
Box weight	87 lbs
Certification	CUL
Warranty	2 years parts and labor

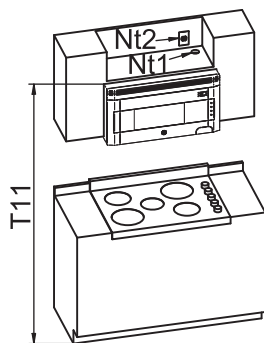
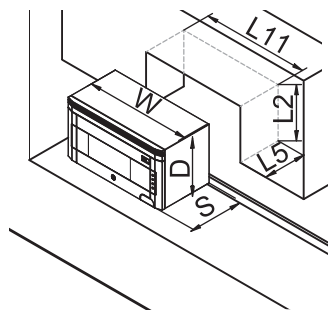

- Nt1** Opening for power cord
- Nt2** Ground receptacle

DIMENSIONS

Ref.	Description	Dimensions	
		Inches	mm
D	Oven height	16 ¹ / ₈	410
L2	Cabinet cavity height	15 ¹ / ₂	394
L5	Cabinet cavity depth	12	305
L11	Cabinet cavity width	30	762
T8 (min)	Clearance between raiper and row bottom	2	51
T9 (min)	Clearance between worktop and row roof	36	914
T11(min)	Clearance between floor and row roof	72	1829
S	Oven depth	14 ⁷ / ₈	378
W	Oven width	29 ¹³ / ₁₆	758

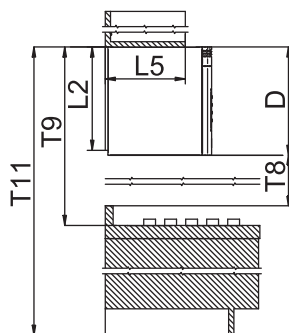

INSTALLATION INSTRUCTIONS

Bertazzoni recommends to operate the appliance after it has been installed in a cabinet. The kitchen cabinets shall be made of materials capable of withstanding temperatures at least 117°F (65°C) above room temperature in order to avoid possible damage to the cabinets during oven usage. For further installation instructions refer to the installation manual.