

# Installation, Connection and Transportation

## Safety information

### **⚠ RISK OF INJURY! ⚠**

The washing machine is heavy. Lift with caution.

### **CAUTION**

Frozen hoses can tear/burst. Do not install the washing machine outdoors or in an area exposed to frost.

Be sure to observe all listed warnings and cautions.

These installation instructions are intended for use by qualified installers. In addition to these instructions the washer shall be installed:

- In the United States, in accordance with the National Electric Code, ANSI/NFPA70 ~ latest edition/State and Municipal codes and/or local codes.
- In Canada, in accordance with the Canadian Electric Code C22.1 ~ latest edition/State and Municipal codes and/or local codes.

If the washing machine is located in a room which will be exposed to temperatures below the freezing point, or if it is located in a cabin that is being shut down for the winter, any residual water in the pump or water inlet hose(s) must be drained.

To drain the pump refer to page 20.

To drain the water hose(s) refer to page 22.

Take care not to damage the washing machine. Do not hold onto protruding parts (e.g. loading door) when lifting.

In addition to the safety information listed here, the local water and electricity supplier may have special requirements.

In case of doubt, have the appliance connected by an authorized technician.

## Factory-supplied equipment

There is a packet of accessory parts supplied with your washer. Check to make sure that all the accessory parts supplied for your model are there. If any parts are missing contact your dealer immediately.

Inside the drum:

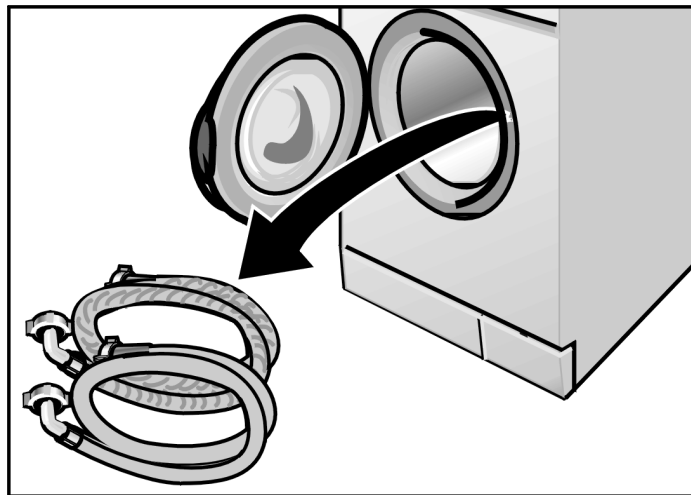

- Water supply hoses (cold and hot water).

Any dampness lift inside the drum was caused by the final testing which every washing machine is subject to before leaving the factory.

On the rear of the appliance:

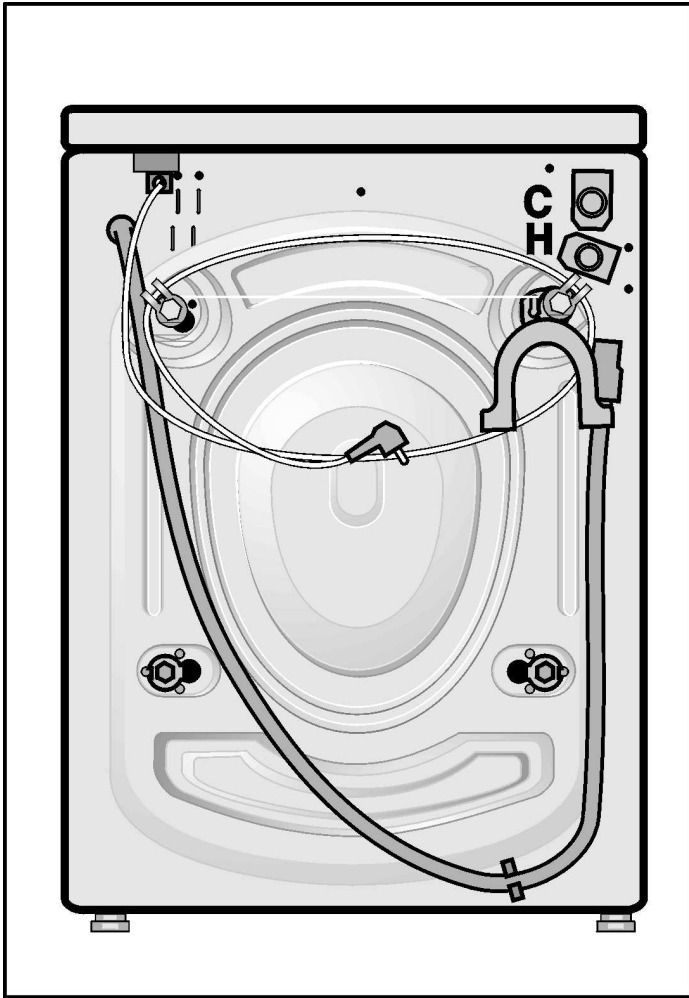

- Water drain hose.
- Mains cable with plug.
- Elbow for attaching the drain hose, e.g. into a wash basin.

**C** = cold water connection

**H** = hot water connection

The bag contains:

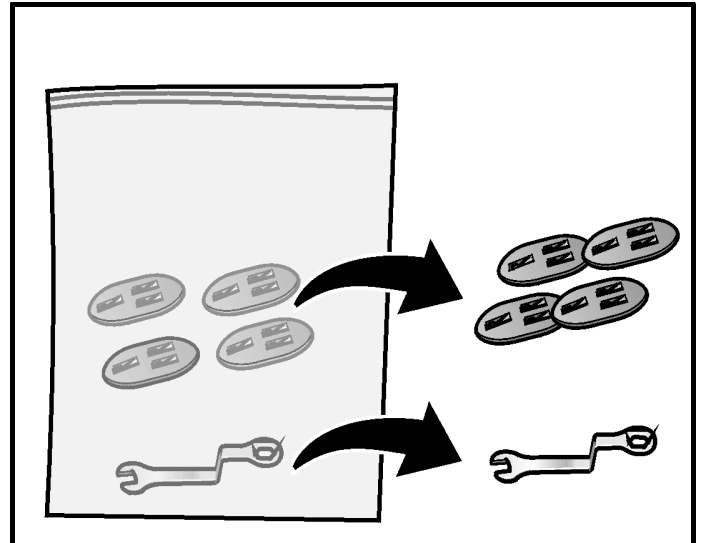

- Covers to be placed over the holes for the transport bolts (after removing it).
- Wrench

Depending on the type of connection, the following may also be required:

- Y-piece (can be obtained from any specialist store) in case there is only a cold water connection possible.

### Useful tools

The following tools are helpful:

- Box cutter.
- Flat screwdriver.
- Ring wrench.
- Spirit level.

## Dimensions

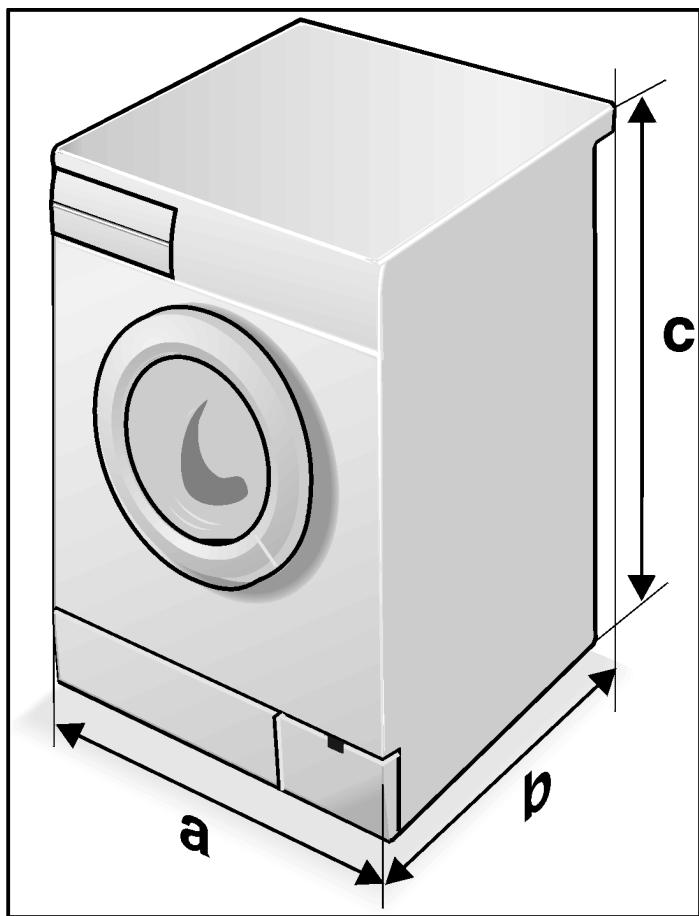

**a** = 600 mm // 23 <sup>5</sup>/<sub>8</sub>"

**b** = 590 mm // 22 <sup>1</sup>/<sub>2</sub>"

**c** = 852 mm // 33 <sup>1</sup>/<sub>2</sub>"

Approx. weight = 69 kg // 152 lbs.

## Installation area

### WARNING

Never ground the washer to plastic plumbing lines, gas lines or hot water pipes.

Appliance stability is important to make sure the washing machine does not "walk" during the spin cycles.

The installation area must be solid and even. Soft floor surfaces, such as carpets or surfaces with foam backing, are not suitable.

If the washing machine is to be installed on a wooden floor:

- If possible, place the washing machine in a corner of the room.
- Screw a water-resistant wooden board (at least 30 mm thick) to the floor.
- Secure the feet of the washing machine using holding brackets \*.

If the washing machine is to be placed on a pedestal:

- Secure the feet of the washing machine using holding brackets \*.

\* Holding brackets (set) can be obtained from the Customer Service (order no. WMZ 2200).

### WARNING

To reduce the risk of fire this washer must be fastened or otherwise secured to an uncovered concrete floor.

#### Pedestal Mounting

For mounting the washer on the Bosch 12" pedestal (accessory No. WTZ 1210) follow the instructions supplied with the pedestal.

## Built-in Installation

The appliance can be built-in; that is, you can install the washing machine under-counter in a kitchen cabinet opening.

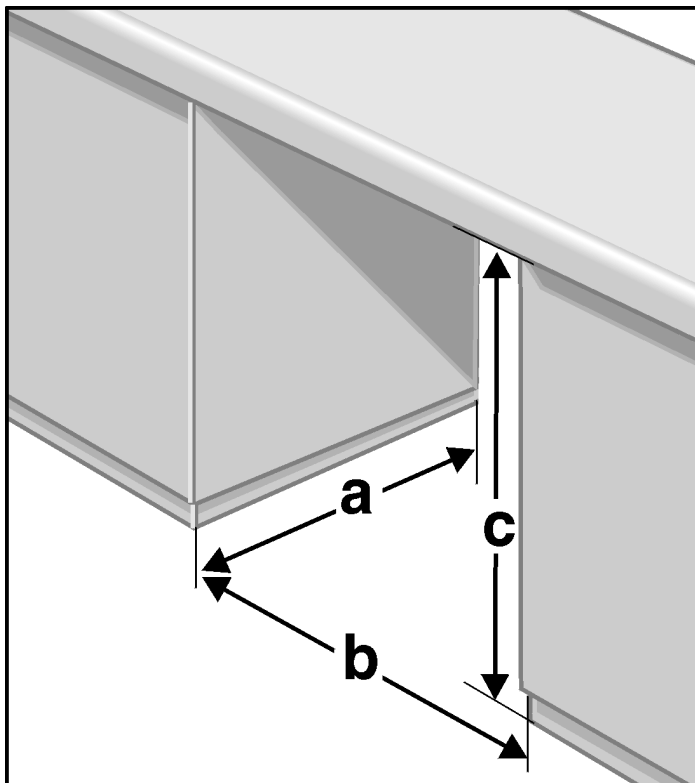

**a** 570 mm minimum // 22 <sup>7</sup>/<sub>16</sub>"

**b** 600 mm minimum // 23 <sup>5</sup>/<sub>8</sub>"

**c** 850 mm minimum // 33 <sup>1</sup>/<sub>2</sub>"

### Minimum Installation Clearances

|              | Alcove or Under Counter |           |
|--------------|-------------------------|-----------|
|              | Counter                 | Closet    |
| <b>Sides</b> | 0" (0 mm)               | 0" (0 mm) |
| <b>Top</b>   | 0" (0 mm)               | 0" (0 mm) |
| <b>Rear</b>  | 0" (0 mm)               | 0" (0 mm) |
| <b>Front</b> | 0" (0 mm)               | 0" (0 mm) |

**Note:** Closet with dryer, please check the openings and ventilation requirements for the used dryer.

## Levelling procedure

All feet of the appliance must be placed firmly on the ground. The washing machine must not wobble.

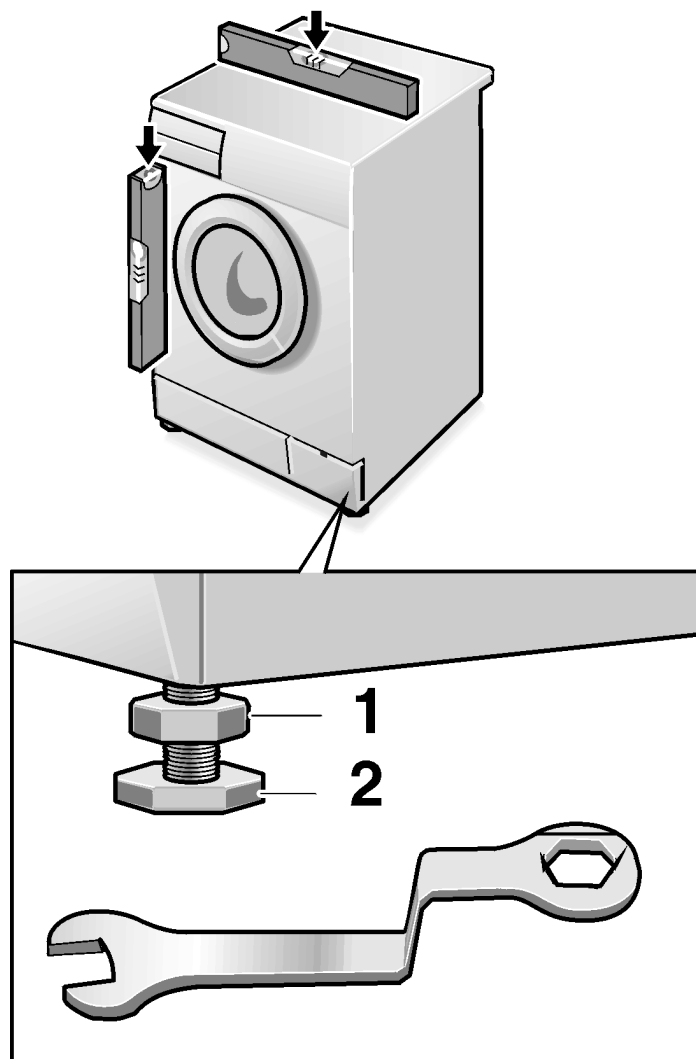

Level the washing machine with the assistance of the four adjustable feet and a spirit level:

- Loosen the counter-nut **1** using the wrench.
- Adjust the height by means of turning the appliance foot **2**.
- Tighten lock nut **1** against the housing.

## Removing the transport bolts

### CAUTION

The transport bolts must be removed before using the appliance for the first time and must be retained for any future transport (e.g. when moving).

#### Preparing

Before removing the transport bolts:

- Take the hoses out of the holders.
- Detach the elbow.

#### Removing

- Release screws **1**, **2**, **3** and **4** using the wrench until they can be moved freely.
- Completely remove all transport bolts by reaching through the open washing machine door and pulling the drum slightly forward.

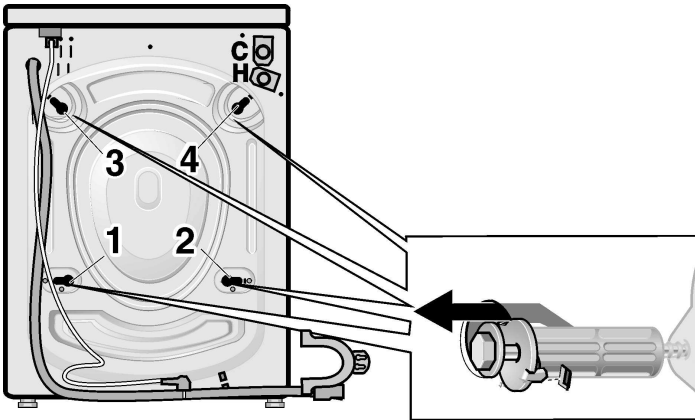

- Insert the covers.

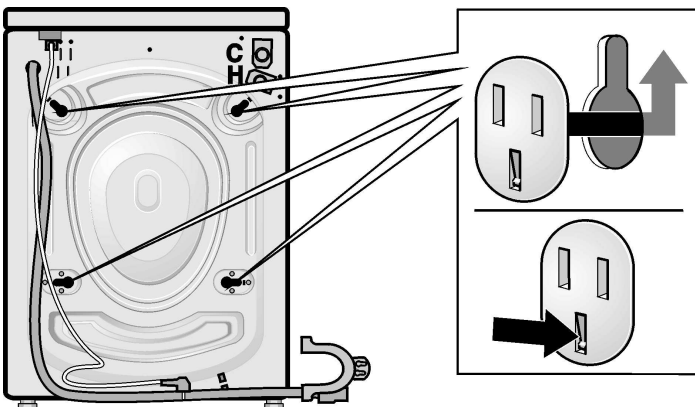

## Storing the transport bolts

Always keep the transport bolts for future transportation of the appliance (e.g. when moving).

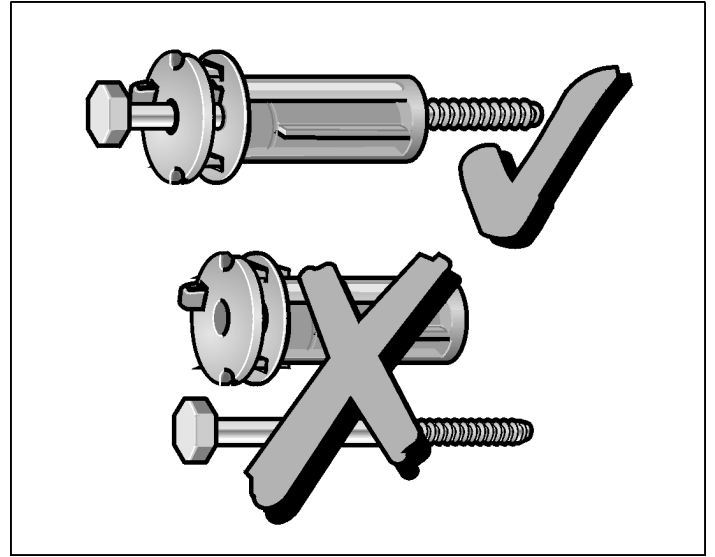

- Store the transport bolts with the washer and bush attached.

## Hose and cable lengths

### Left-hand connection

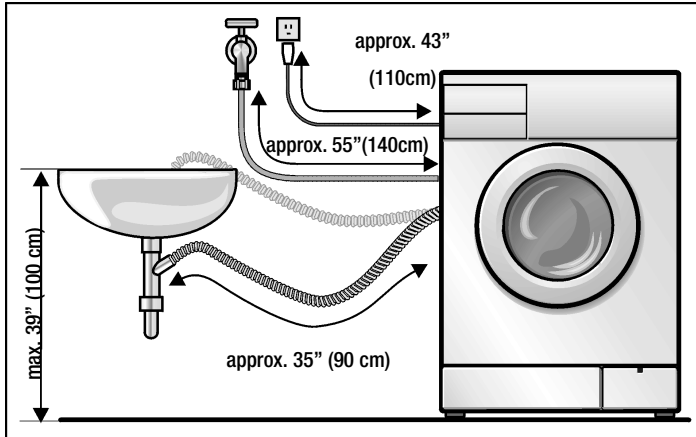

### Right-hand connection

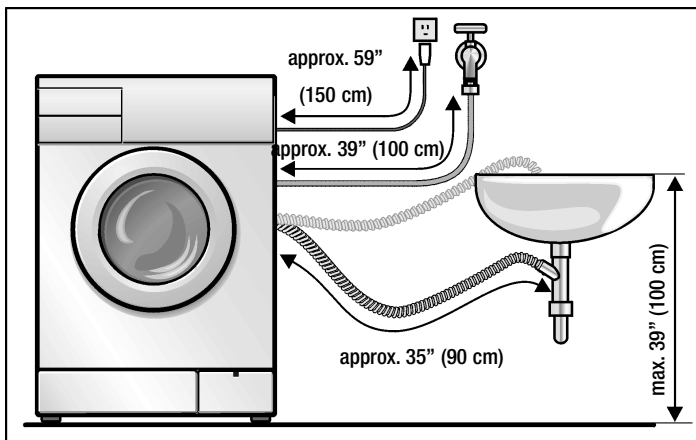

### Other hoses

Available at specialty dealers:

- Extended supply hose (approx. 2.2 m // 86.6 in).

## Water connection

### Water supply

#### CAUTION

The washing machine must only be operated with cold and hot (max. 140 °F // 60 °C) tap water. Do not connect the appliance to the mixer tap of an unpressurized hot-water boiler.

If in any doubt, have the water connection installed by an authorized technician.

The water supply hoses must not be:

- Bent or squashed.
- Modified or cut (stability can no longer be guaranteed).

Plastic threads must only be tightened by hand. Do not remove the strainers from the water supply hoses.

Observe the water pressure in the supply network:

- The water pressure should be between 14.5 to 145 p.s.i. (1 to 10 bars) (when the tap is turned on, at least 2.2 U. S. gallons (8 liters) of water are discharged per minute).
- A pressure reducing valve must be installed if the maximum water pressure is exceeded.

#### CAUTION

To prevent against water damage, the hot and cold water valves should be accessible when the washer is in place and should **always** be turned off when the washer is not in use.

When the washer is being installed in a new building, or a building in which the plumbing system was installed or upgraded recently, the lines must be flushed prior to installing the washer. This must be done to clear the lines of any sand, dirt or residue that may still be in the lines.

## Connection options

**A Cold water connection and  
B Hot water connection** (max. 140 °F // 60 °C)

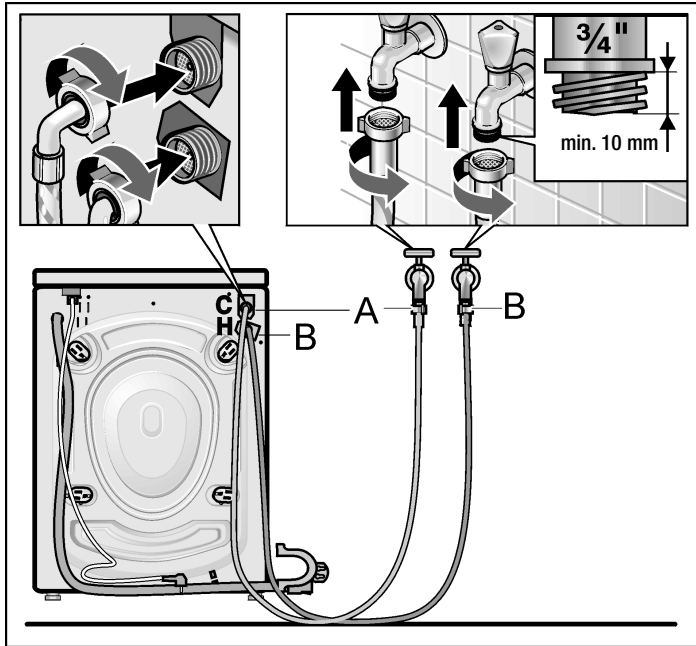

or Cold water connection only with Y-piece

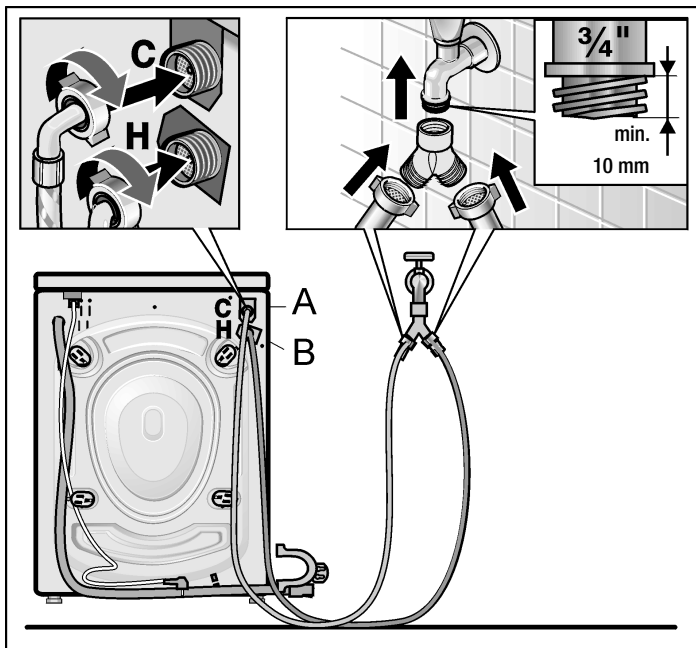

- ❑ After the connection:  
Turn on the water completely, and check whether connection points are watertight.

## CAUTION

The connection points are under full water pressure. Check seal with tap fully open.

## Water drainage

### CAUTION

Do not bend or pull the water drainage hose.

Height difference between the placement area of washer and the drainage point:  
Maximum 110 cm // 43 inches.

### Standpipe or In Wall Installation

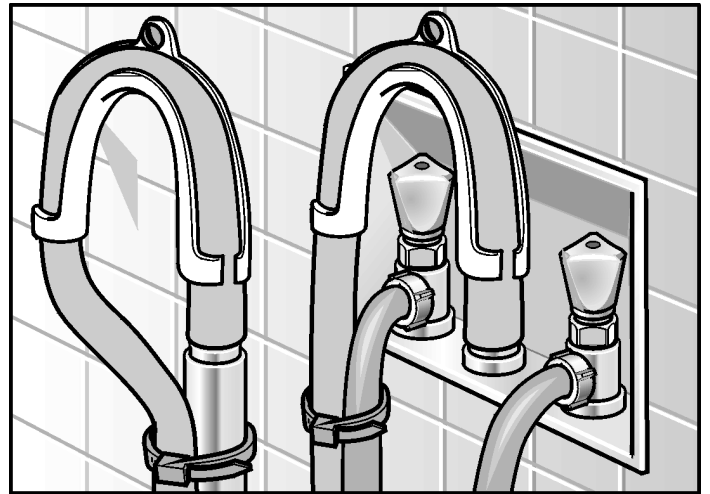

- ❑ Use the U-bracket. Attach the U-bracket to the end of the hose and insert end of hose into standpipe or wall drain.
- ❑ Use a strap or cable tie connected to U-bracket to hold hose in place.

### Drainage into a siphon

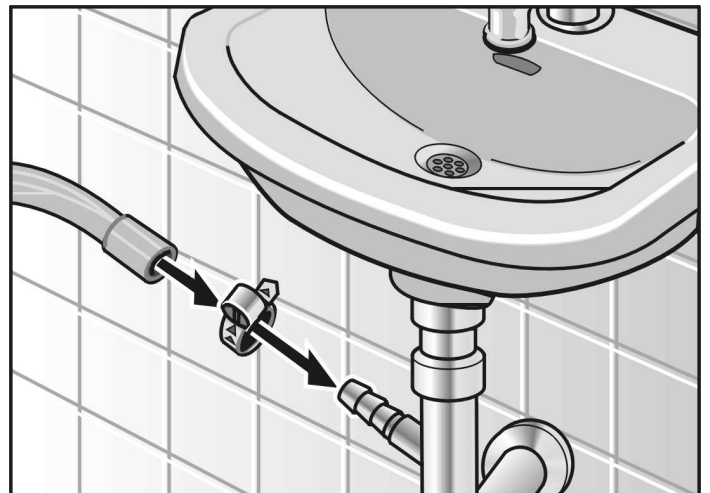

- ❑ Secure the connection point with a hose band clip.

## Drainage into a wash basin

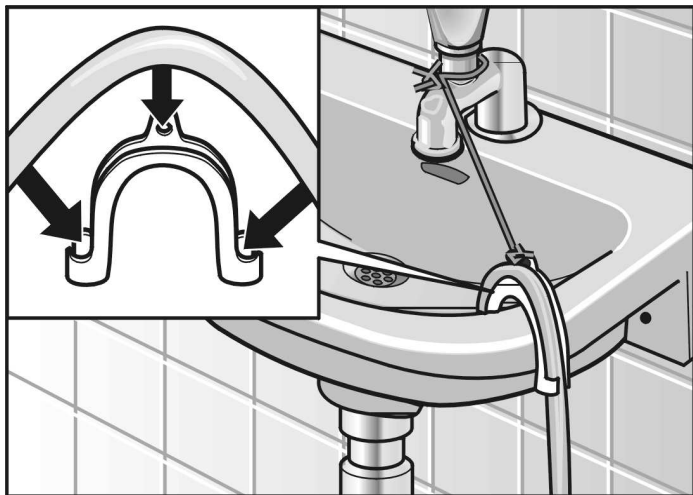

### CAUTION

The plug must not block the drain of the wash basin.

- ❑ Secure the water drainage hose so that it does not slide out.
- ❑ When the water is being drained, check whether the water flow is fast enough.

## Electrical connection

### GROUNDING INSTRUCTIONS

This appliance must be grounded. In the event of malfunction or breakdown, grounding will reduce the risk of electrical shock by providing a path of least resistance for the electric current. This appliance is equipped with a cord having an equipment-grounding conductor and a grounding plug. The plug must be plugged into an appropriate outlet that is properly installed and grounded in accordance with all local codes and ordinances.

### WARNING

Improper connection of the equipment-grounding conductor can result in the risk of electric shock. Check with a qualified electrician or serviceman if you are in doubt as to whether the washing machine is properly grounded.

Do not modify the plug provided with the appliance – if it will not fit in the outlet, have a proper outlet installed by a qualified electrician.

### WARNING

The washing machine must only be connected to an individual branch circuit and using a properly installed socket outlet which is grounded.

The mains voltage must correspond to the voltage specification on the washing machine (nameplate). Connection specifications as well as the required fuses are stipulated on the appliance nameplate.

| Volts | Hertz | Amperes | Watts      |
|-------|-------|---------|------------|
| 120   | 60    | 15      | 1800(max.) |

Make sure that:

- the mains plug fits into the socket outlet.
- the cable cross-section is permissible.
- the grounding system is properly installed.

The mains cable may be replaced by an electrician only.

Replacement mains cables are available from Customer Service.



## WARNING

To reduce the risk of fire or electrical shock, DO NOT use an extension cord or an adapter to connect the washer to the electrical power supply.

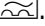
In the event that an earth-leakage circuit breaker is to be used, only use types marked with the following symbol: .

Only this symbol can guarantee compliance with all current regulations.

Do not insert/remove the mains plug with wet or damp hands.

Handle the plug body only when removing the plug from the socket.

## Transport, e.g. when moving

Before transporting the washing machine:

- Turn off the water,
- Drain any remaining water (refer to page 20),
- Release the water pressure in the supply hose (refer to page 22),
- Disconnect the washing machine from the mains.
- Dismantle the supply and drainage hose,
- Install all transport bolts.

Having transported the appliance and ensured proper installation and connection, allow the **Drain** program to run through before starting the first wash program.

### Preparing and inserting the transport bolts

- Remove the 4 covers.
- Prepare the transport bolts:  
Loosen the screw in the sleeve until the end of the screw is level with the end of the sleeve.
- Insert and tighten transport bolts **1,2,3 and 4**.  
The lug on the washing machine must be located in the groove in the rear panel of the housing.

