



Under-Cabinet Hoods

F30WV16E C/S/B

30" Wall Mount



Features

Nominal Width	30"
Installation Type	Wall Mount
Style	Under-Cabinet
Controls	Rocker Switch
Air Discharge	Vertical or Horizontal
Air Delivery (CFM)	160
Blower Type	Fan
Fan Speeds	2
Cooktop Light(s)	1
Dishwasher-Safe Filter(s)	Yes
Exhaust Duct	External
Duct Required	3-1/4" x 10"

Specifications

Product Dimensions -	
Height	6"
Width	30"
Depth	17-1/2"
Voltage Rating	120V / 60Hz / 15A
Connected Load (kW Rating) @ 120 Volts ¹	TBD
Amps @ 120 Volts	2.0
Shipping Weight (Approx.)	13 Lbs.
Sones Rating	6.5

¹For use on adequately wired 120V, dedicated circuit having 2-wire service with a separate ground wire. Appliance must be grounded for safe operation.

NOTE: Always consult local and national electric codes. Check local building codes for installation requirements, as they may vary per locale. Refer to Product Installation Guide for detailed installation instructions on the web at frigidaire.com.

Specifications subject to change.

Available in:



Signature Features

2-Speed Fan

Effectively and quietly removes smoke, vapors and smells from the kitchen.

Cooking Surface Light

Provides ample illumination of the cooking surface.

Dishwasher-Safe Filter

Dishwasher-safe for easy cleaning.

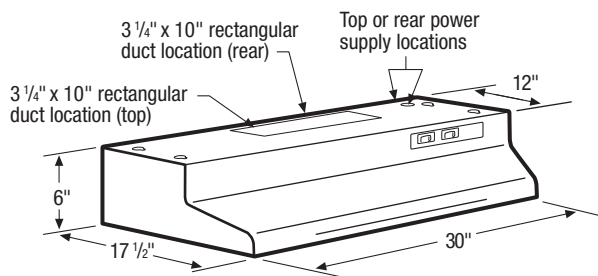
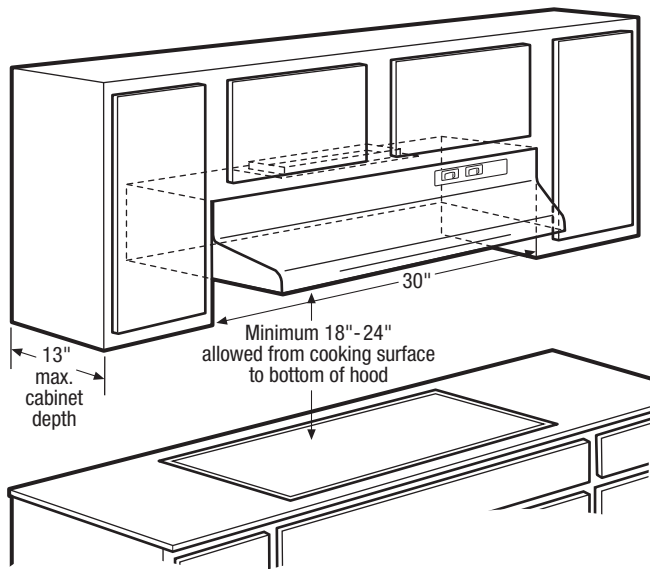

Exhaust Options

Vent hood can be vertically or horizontally ducted outside using rectangular duct.*

For detailed duct preparation and installation specifications, refer to installation instructions on web.

*3 1/4" x 10" to 6" round duct transition required for installation of 6" round duct.

Outside Vertical – 3 1/4" x 10" Rectangular Duct Cabinet Bottom

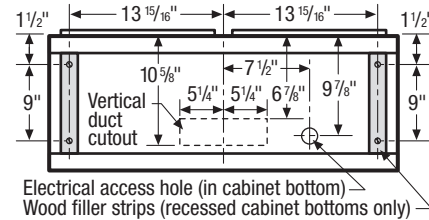

Outside Horizontal – 3 1/4" x 10" Rectangular Duct Cabinet Front

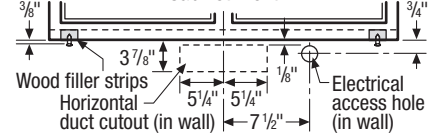

Under-Cabinet Hood Specifications

- Product Shipping Weight (Approx.) – 13 Lbs.
- Wall-Mount Installation – can be ducted vertically or horizontally.
- Sones Rating – 6.5
- Voltage Rating – 120V/60 Hz/15 Amps
- Connected Load (kW Rating) @ 120 Volts = TBD
(For use on adequately wired 120V, dedicated circuit having 2-wire service with a separate ground wire. Appliance must be grounded for safe operation.)
- Amps @ 120 Volts = 2.0 Amps
- Always consult local and national electric codes. Check local building codes for installation requirements, as they may vary per locale.
- Connect vent hood with copper wire only.
- Minimum installation height allowed from bottom of hood to cooking surface is 18" - 24".
- Installation on recessed-bottom cabinets requires attachment of two wood filler strips at each side of recessed area under cabinet.

- For outside ventilation.
- Exhaust Duct Required – 3-1/4"x10" (3-1/4"x10" to 6"-round transition duct can be used if needed)
- For most efficient airflow exhaust, use a straight run or as few elbows as possible.
- Use metallic flex ducting only to connect rigid duct directly to transitions (if allowed by code).
- Thermal breaks such as short section of nonmetallic duct, should be used in areas of extreme cold.
- Cold weather installations should have additional backdraft damper installed.
- Refer to installation instructions on web for detailed duct preparation and converting exhaust vent blower system for exterior exhaust ventilation.

Note: For planning purposes only. Refer to Product Installation Guide on the web at frigidaire.com for detailed instructions.

Accessories information available on the web at frigidaire.com



FRIGIDAIRE

USA • 10200 David Taylor Drive • Charlotte, NC 28262 • 1-800-FRIGIDAIRE • frigidaire.com
CANADA • 5855 Terry Fox Way • Mississauga, ON L5V 3E4 • 1-800-265-8352 • frigidaire.ca

F30WV16E 01/11

© 2011 Electrolux Home Products, Inc.

Specifications subject to change.
Printed in the U.S.A.

Use these dimensions and clearance instructions for planning purposes only. For detailed installation instructions, refer to installation guide, packed with product, or on the web at frigidaire.com.

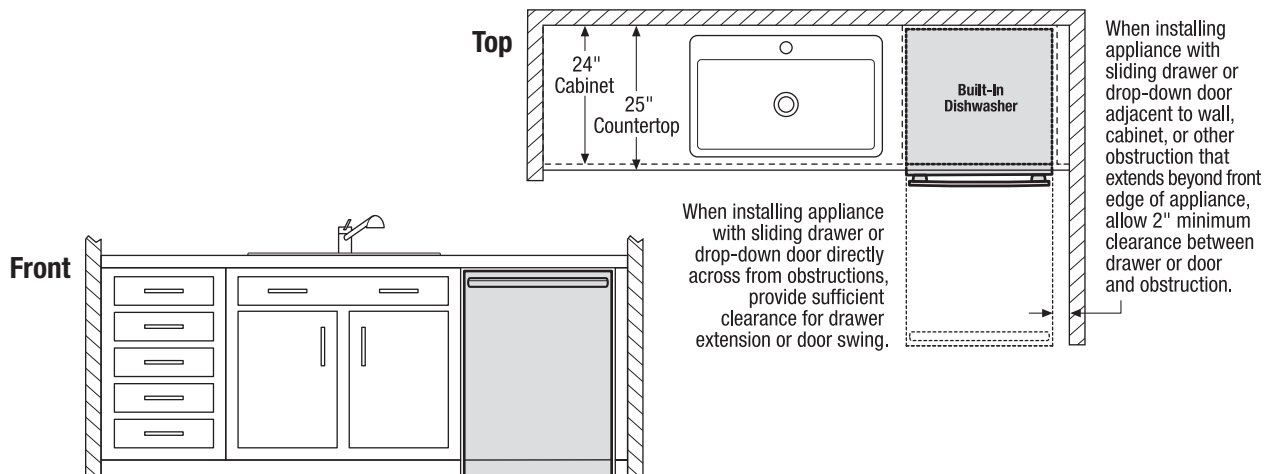
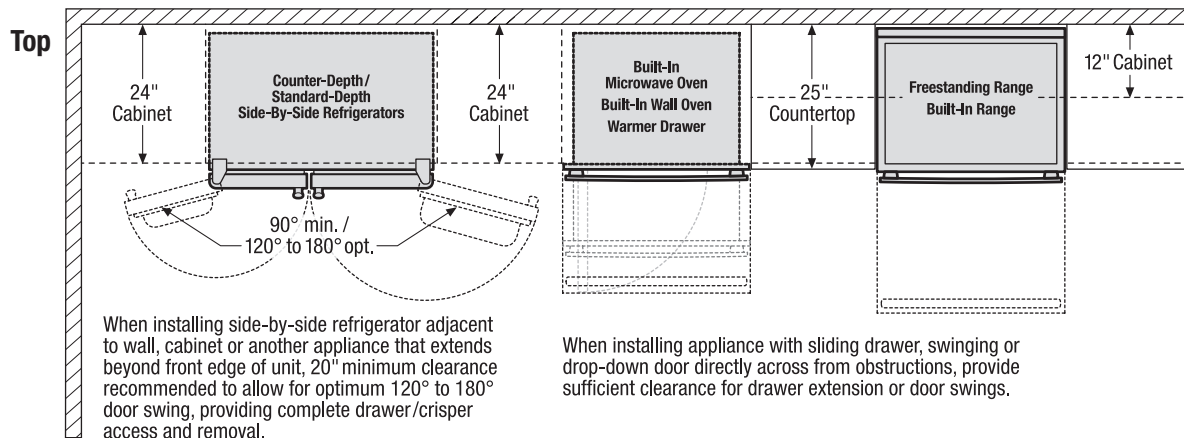
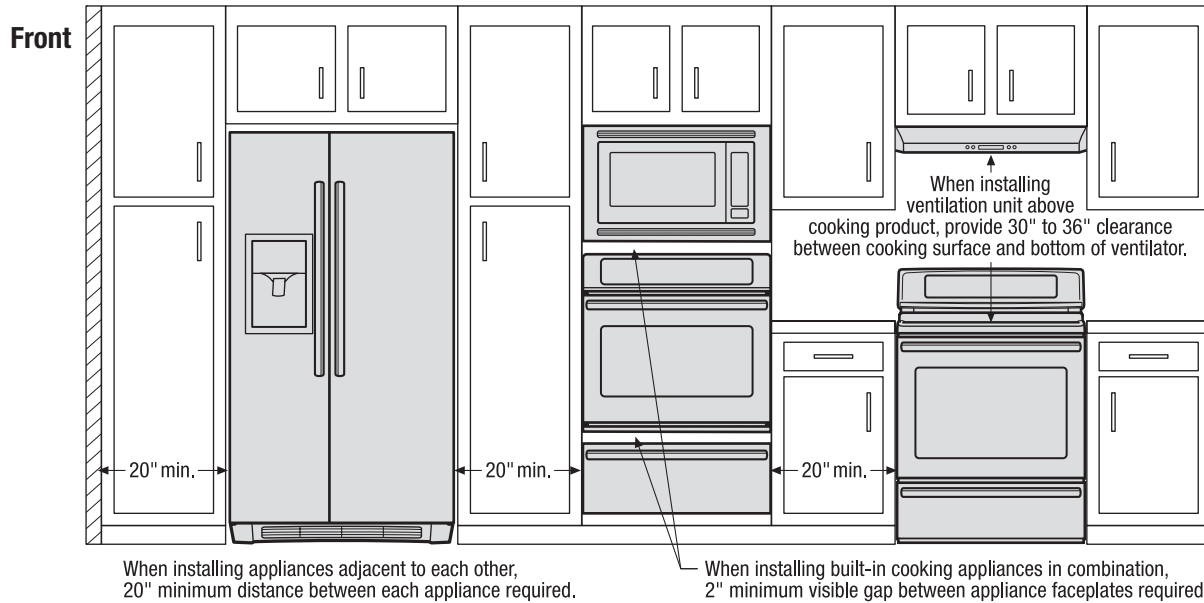

Use these dimensions and clearance instructions for planning purposes only. For detailed installation instructions, refer to installation guide, packed with product, or on the web at frigidaire.com.

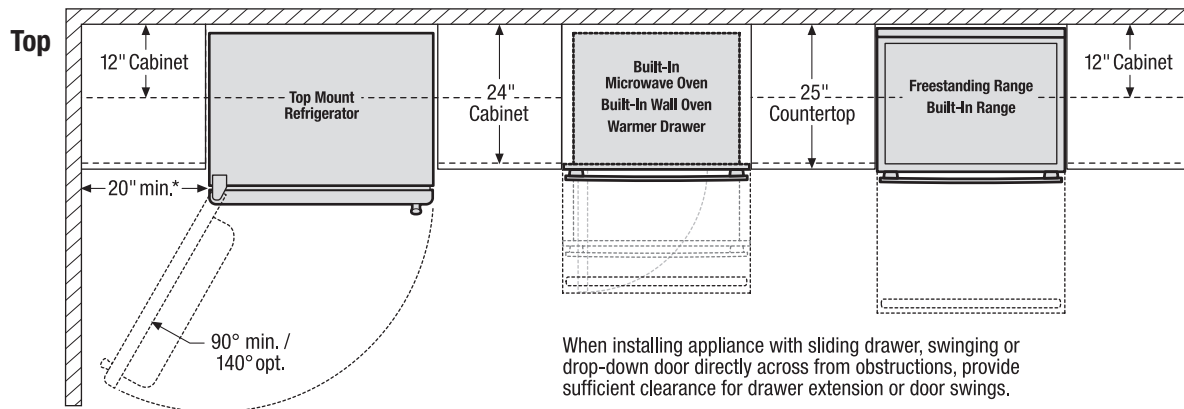
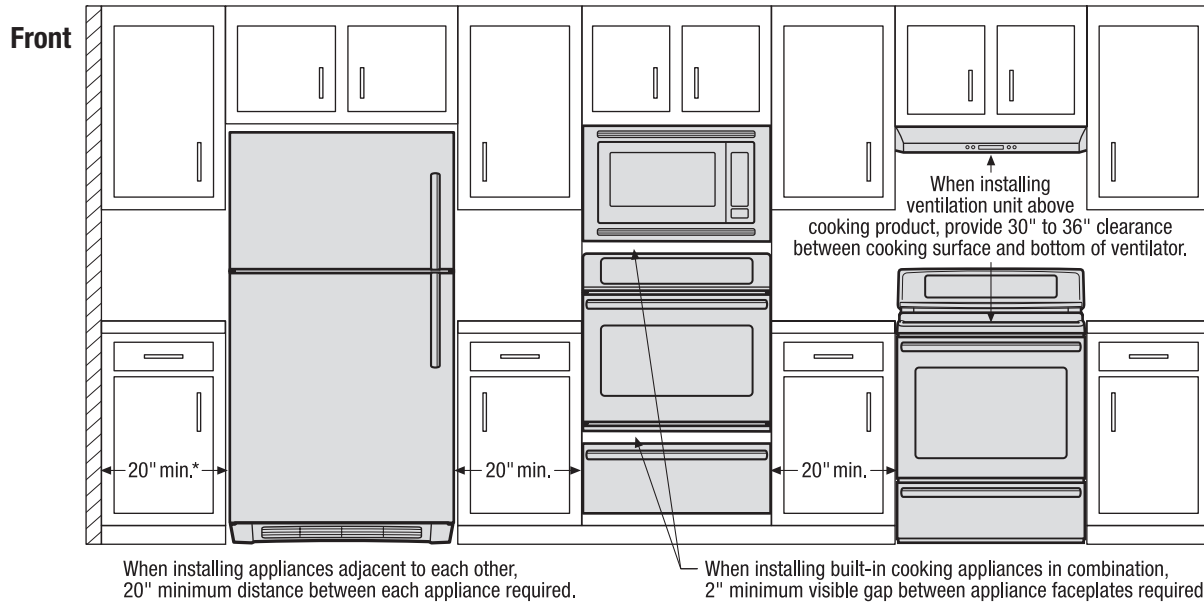

*When installing refrigerator adjacent to wall, cabinet or other appliance that extends beyond front edge of unit, 20" minimum clearance recommended to allow for optimum 140° door swing, providing complete crisper access and removal. (Absolute 3" minimum clearance will ONLY allow for 90° door swing which will provide limited crisper access with restricted removal.)

