

30" COMBINATION MICROWAVE/WALL OVENS

JMW3430D, JMW2430D – 30" x 43³/₄" x 25⁵/₁₆"

PRODUCT DIMENSIONS

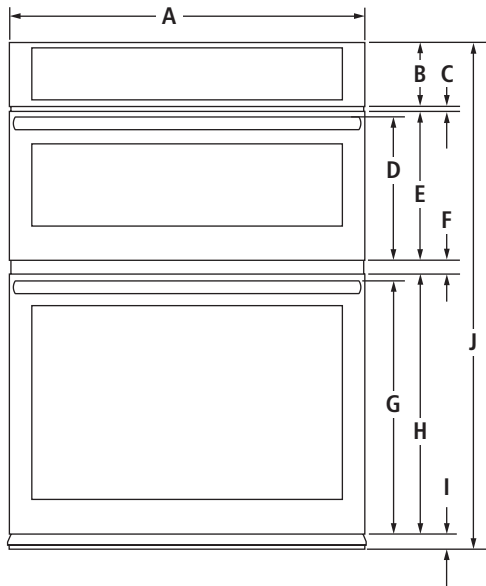

FRONT VIEW

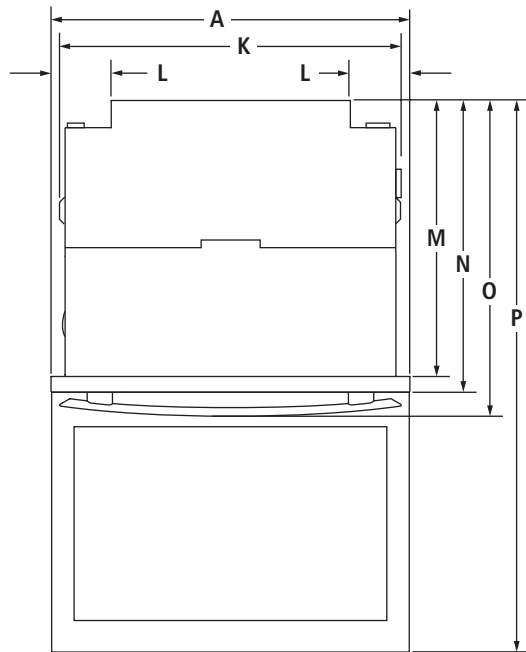

TOP VIEW

| MODEL # | | JMW3430D | |
|---------|--|----------------------------------|-------|
| | | in | cm |
| A | Overall width | | |
| | Pro-Style® Stainless or Euro-Style Stainless | 30 | 76.2 |
| | Floating Glass | 29 ¹⁵ / ₁₆ | 76.1 |
| B | Height of control panel | 5 ¹ / ₂ | 14 |
| C | Space between control panel and door | ¹ / ₂ | 1.2 |
| D | Height to top of microwave oven handle | | |
| | Pro-Style® Stainless | 12 ³ / ₁₆ | 31.0 |
| | Euro-Style (color-coordinating) | 12 ³ / ₁₆ | 31.0 |
| E | Height of microwave oven door | 12 ¹¹ / ₁₆ | 32.3 |
| F | Space between doors | ¹ / ₈ | 2.9 |
| G | Height to top of oven handle | | |
| | Pro-Style® Stainless | 21 ⁵ / ₈ | 55.0 |
| | Euro-Style (color-coordinating) | 21 ⁷ / ₁₆ | 54.4 |
| H | Height of oven door | 22 ¹ / ₈ | 56.2 |
| I | Height of trim | 1 ¹¹ / ₁₆ | 4.3 |
| J | Overall height | 43 ³ / ₄ | 111.1 |
| K | Width of recessed oven | 28 ⁷ / ₁₆ | 72.2 |
| L | Width of conduit channel | 4 ¹⁵ / ₁₆ | 12.5 |
| M | Depth of recessed oven | 23 ¹ / ₄ | 59.0 |
| N | Depth with doors | 24 ³ / ₈ | 61.9 |
| O | Depth with handles | | |
| | Pro-Style® Stainless | 26 ³ / ₈ | 67.0 |
| | Euro-Style (color-coordinating) | 25 ⁵ / ₁₆ | 64.3 |
| P | Depth with door fully open | 45 ³ / ₈ | 115.3 |

IMPORTANT: Dimensional specifications are provided for planning purposes only. Do not make any cutouts based on this information. Refer to the Installation Guide before selecting cabinetry, verifying electrical/gas connections, making cutouts or beginning installation. All Jenn-Air® appliances are appropriately UL, CUL or CSA approved.

30" COMBINATION MICROWAVE/WALL OVENS

JMW3430D, JMW2430D – 30" x 43¾" x 25⅝"

DIMENSIONS AS INSTALLED

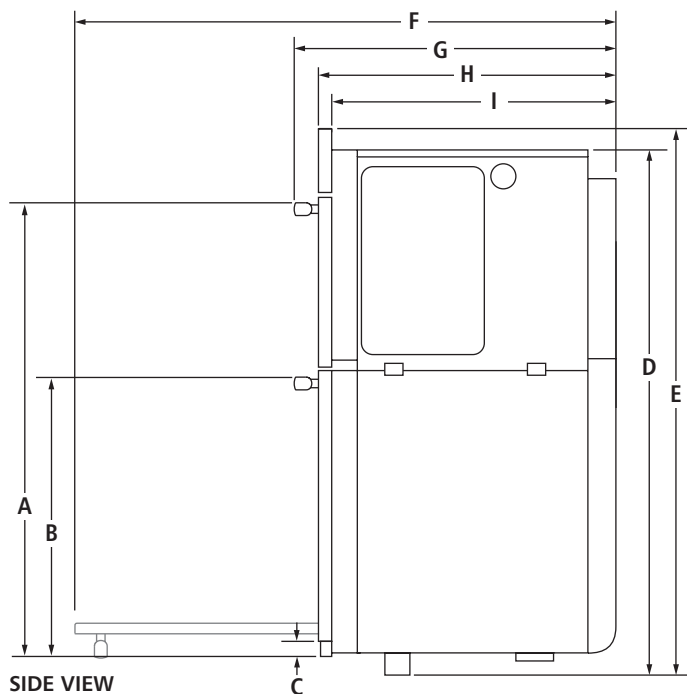

| MODEL # | | JMW3430D | |
|---------|---|----------|-------|
| | | JMW2430D | |
| | | in | cm |
| A | Height to top of upper handle Pro-Style® Stainless | 36½ | 92.7 |
| | Euro-Style (color-coordinating) | 36½ | 92.7 |
| B | Height to top of lower handle Pro-Style® Stainless | 23⅜ | 59.3 |
| | Euro-Style (color-coordinating) | 23⅜ | 58.7 |
| C | Height of trim extending below cutout | 1⅞ | 4.3 |
| D | Height of recessed oven | 41 | 104.2 |
| E | Height to top of control panel | 43¾ | 111.1 |
| F | Depth with door fully open | 45⅝ | 115.3 |
| G | Depth with handles Pro-Style® Stainless | 26⅜ | 67.0 |
| | Euro-Style (color-coordinating) | 25⅝ | 64.3 |
| H | Depth with doors | 24⅜ | 61.9 |
| I | Depth of recessed oven | 23¼ | 59.0 |

IMPORTANT: Dimensional specifications are provided for planning purposes only. Do not make any cutouts based on this information. Refer to the Installation Guide before selecting cabinetry, verifying electrical/gas connections, making cutouts or beginning installation. All Jenn-Air® appliances are appropriately UL, CUL or CSA approved.

30" COMBINATION MICROWAVE/WALL OVENS

JMW3430D, JMW2430D – 30" x 43³/₄" x 25⁵/₁₆"

OPENING/CLEARANCE DIMENSIONS

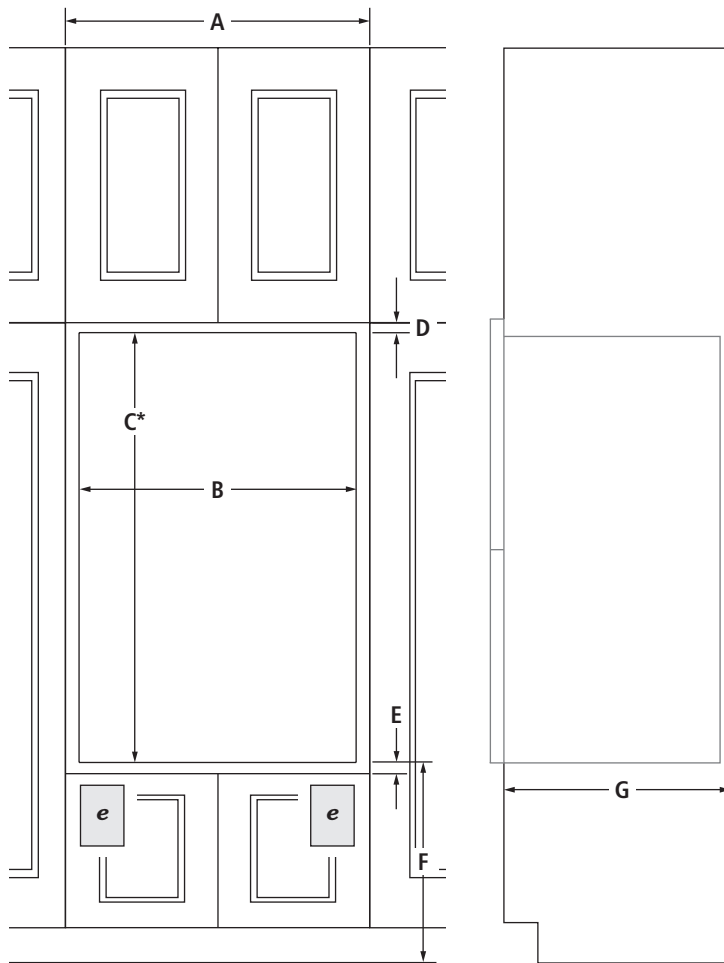

FRONT VIEW

SIDE VIEW

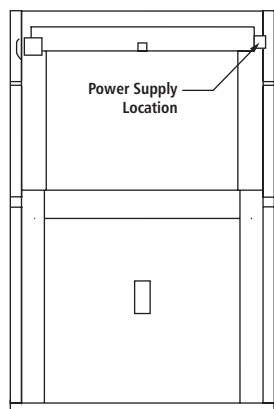

BACK VIEW

| MODEL # | | JMW3430D | |
|---------|--|---------------------------------|-----------|
| | | JMW2430D | |
| | | in | cm |
| A | Width of cabinet (min.) | 30 | 76.2 |
| B | Width of cutout | 28½ | 72.4 |
| C* | Height of cutout (recommended) | 41 ⁵ / ₁₆ | 104.9 |
| D | Top of cutout to bottom of upper cabinet door (min.) | 2¼ | 5.7 |
| E | Bottom of cutout to top of lower cabinet door (min.) | 1½ | 3.8 |
| F | Bottom of cutout to floor | 4-19¼ | 10.2-48.9 |
| G | Depth of cutout (min.) | 24 | 61.0 |
| e | Recommended junction box location | | |

* Will fit cutout height from 41" (104.1 cm) to 41½" (105.4 cm).

ELECTRICAL REQUIREMENTS

240 volt, 40-amp fused, grounded circuit is required. A dedicated circuit is required.

The length of conduit provided is for serviceability. Do not cut the conduit. The junction box should be located 3" (7.6 cm) maximum below the support surface. Drill a 1" (2.5 cm) minimum diameter hole in the right rear or left rear corner of the support surface for access to the junction box.

IMPORTANT: Dimensional specifications are provided for planning purposes only. Do not make any cutouts based on this information. Refer to the Installation Guide before selecting cabinetry, verifying electrical/gas connections, making cutouts or beginning installation. All Jenn-Air® appliances are appropriately UL, CUL or CSA approved.

30" COMBINATION MICROWAVE/WALL OVENS – FLUSH INSTALLATION

JMW3430D, JMW2430D – 30" x 43¾" x 24⅜" (depth without handles)

OPENING/CLEARANCE DIMENSIONS

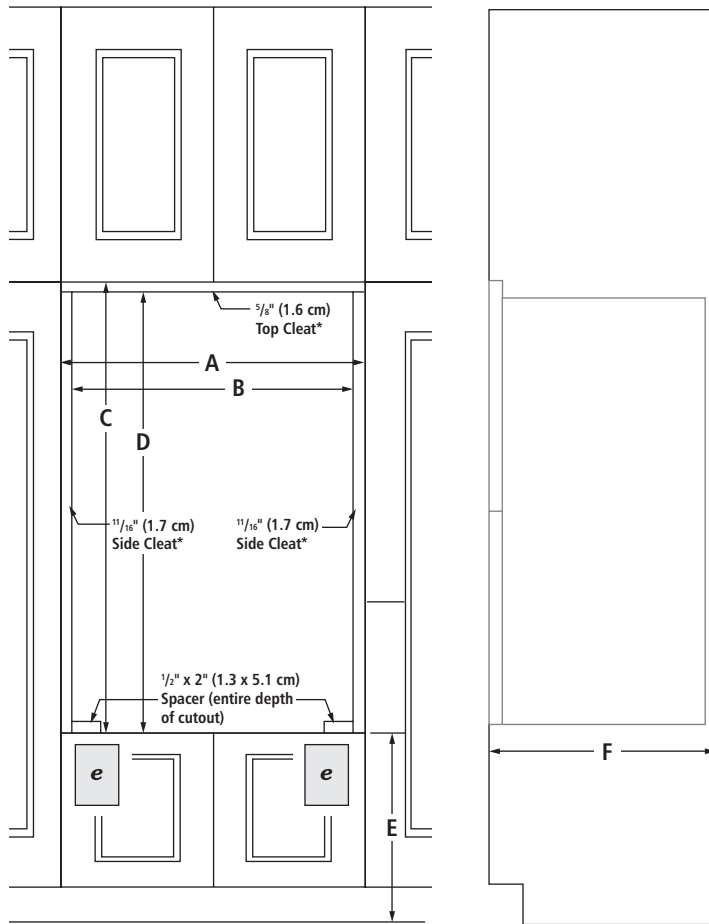

FRONT VIEW

SIDE VIEW

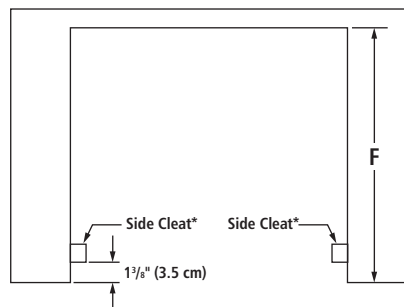

TOP VIEW

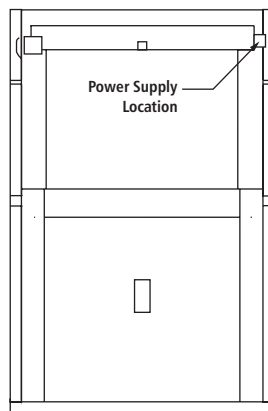

BACK VIEW

* Cleats and spacers must be recessed 1⅜" (3.5 cm) from the front of the cabinet.

| MODEL # | | JMW3430D | |
|---------|-------------------------------------|----------|-----------|
| | | JMW2430D | |
| | | in | cm |
| A | Width of flush inset cutout (min.) | 30¼ | 76.8 |
| B | Width of opening (min.) | 28⅞ | 73.3 |
| C | Height of flush inset cutout (min.) | 44⅝ | 112.5 |
| D | Height of opening (min.) | 43⅞ | 110.9 |
| E | Bottom of cutout to floor | 4⅞-19¼ | 11.7-48.9 |
| F | Depth of cutout (min.) | 25⅞ | 64.4 |
| e | Recommended junction box location | | |

ELECTRICAL REQUIREMENTS

240 volt, 40-amp fused, grounded circuit is required. A dedicated circuit is required.

The length of conduit provided is for serviceability. Do not cut the conduit. The junction box should be located 3" (7.6 cm) maximum below the support surface. Drill a 1" (2.5 cm) minimum diameter hole in the right rear or left rear corner of the support surface for access to the junction box.

FLUSH INSTALLATION REQUIREMENTS

A 25⅞" (64.4 cm) minimum cutout depth is required.

These dimensions will result in a ¼" (0.6 cm) reveal on the top, a ¼" (0.6 cm) reveal on the sides and a ⅛" (0.3 cm) reveal on the bottom of the wall oven.

The front face of the cleats and spacers will be visible and should be treated as a finished surface.

IMPORTANT: Dimensional specifications are provided for planning purposes only. Do not make any cutouts based on this information. Refer to the Installation Guide before selecting cabinetry, verifying electrical/gas connections, making cutouts or beginning installation. All Jenn-Air® appliances are appropriately UL, CUL or CSA approved.