

1000 WATT 5 DISC HOME THEATER SYSTEM

LHT764



- 1000 Watts Total Power
- Made for iPod
- 5 Disc Changer
- 1080i Up-Conversion HDMI™ Output
- USB Media Plus
- XM Satellite Radio Ready
- LG SimLink
- Touch Panel Controls

1000W TOTAL POWER

Powerful sound with 1000 watts of total output power.

MADE FOR IPOD

Connect, control and play directly from your iPod.

5-DISC CHANGER

5 disc DVD changer holds your favorite movies and music.

1080i UP-CONVERSION

Superior image quality and convenience with 1080i upconversion via HDMI™ output.

USB MEDIA PLUS

Experience your digital music, photo and video library with USB Media Plus.

DIGITAL CABLE/SATELLITE BOX CONTROLLER

Easy scheduled recording from most digital cable/digital satellite boxes with a Set-Top Box Controller.

XM READY

Enjoy hundreds of channels of XM satellite radio with an optional XM Mini-Tuner Antenna.

LG SIMPLINK

Allows for convenient control of other LG SimLink products using the existing HDMI™ connection.

TOUCH PANEL CONTROLS

Stylish and simple to use touch panel volume control.



1000 WATT 5 DISC HOME THEATER SYSTEM

LHT764

AMPLIFIER/SPEAKER

Output Power - Front	155W x 2*
Output Power - Center	155W*
Output Power - Rear	155W x 2*
Output Power - Subwoofer	225W**
Front Speaker Type	Satellite
Center Speaker Type	Horizontal Standing
Rear Speaker Type	Satellite
Subwoofer Speaker Type	Standard (7 Inch)

AUDIO/VIDEO PLAYBACK FORMATS

Disc Capacity	5
DVD (PAL)	•
DVD (NTSC)	•
DVD-R	•
DVD-RW	•
DVD+R	•
DVD+RW	•
CD-R/RW	•
MP3 Audio	•
WMA Audio	•
DVD-Audio	•
JPEG Photo	•
DivX Video	•
MPEG4 Video	•
Music Photo Album	•

GRAPHIC USER INTERFACE

Initial Menu Language	English
-----------------------	---------

VIDEO CAPABILITIES

Video Output Resolutions	480i/720p/1080i
Progressive Scan	•
Maximum HDMI™ Up-Convert	1080i

AUDIO CAPABILITIES

XPS Pro (eXtreme True Sound Pro)	•
VSM (Virtual Sound Matrix)	•
Dolby Digital 5.1 Channel Decoding	•
Dolby Prologic II	•

DVD PLAYBACK FEATURES

Parental Lock	•
Chapter Skip (Rew/Fwd)	•
Search/Slow/Step Skip for Rew and Fwd	•

CD PLAYBACK FEATURES

Programmable Play	•
Repeat Play	•
Number of Programmable Tracks	20
JPEG Preview	•
MP3 ID3 Tag Support	•
PBC On/Off	•

USB MEDIA HOST/PLUS PLAYBACK

JPEG	•
MPEG1	•
MPEG2	•
MPEG4	•
WMA	•
DivX®	•
MP3	•
MP3 VBR	•

TUNER

Audio Tuner Band	FM/AM
FM Tuner Range (100kHz)	87.50-108.00MHz(50kHz)
AM Tuner Range (10kHz)	530-1720kHz
Radio Tuner Presets	50
Digital Satellite Radio Tuner	XM-Ready

FRONT PANEL INPUTS/OUTPUTS

USB (A) Port (USB Media Plus)	•
Mini Stereo Jack Input (3.5mm) for Portable Audio	•

REAR PANEL INPUTS/OUTPUTS

HDMI™ Out	•
Component Video Out	•
Composite Video Out	•
FM Antenna Input	•
AM Antenna Input	•

REAR PANEL INPUTS/OUTPUTS (CONTINUED)

Satellite Radio Antenna Input	•
Speaker Output Type/Number	Push-in/5
Subwoofer Output Type/Number	Push-in/1
LG Made for iPod Connector Port	•

SUPPLIED ACCESSORIES

Remote Control Type	Universal
A/V Cable (RCA Type)	•
LG Made for iPod Connector Cable	•
Battery (Size)	AA
User Manual	•
Warranty Card	•
Customer Registration Card	•
FM Antenna	•
AM Antenna	•

SPECIAL FEATURES

Initial Logo	•
--------------	---

SPECIFICATIONS

Front Panel Display	Flourescent
Cabinet Color	Glossy Black/Silver
Main Unit Dimensions (W x H x D)	16.9" x 3.7" x 13.8"
Front Speaker Dimensions (W x H x D)	6.7" x 8.3" x 4.4"
Center Speaker Dimensions (W x H x D)	19.7" x 6.3" x 6.1"
Rear Speaker Dimensions (W x H x D)	6.7" x 8.3" x 4.4"
Subwoofer Dimensions (W x H x D)	9.3" x 17.1" x 0.0"
Main Unit Weight	NA lbs
Front Speaker Weight (Each)	NA lbs
Center Speaker Weight	NA lbs
Rear Speaker Weight (Each)	NA lbs
Subwoofer Weight	NA lbs
Dimensions w/Packaging (W x H x D)	NA
Weight In Package	NA lbs.
UPC	719192171268
Warranty	1 Year Parts/90 Days Labor

*Rated at 1kHz into 4 ohms, 10% THD

**Rated at 30Hz into 3 ohms, 10% THD

REMOTE

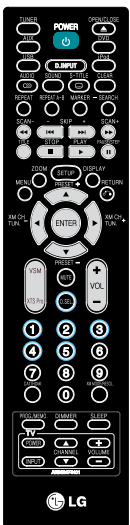

REAR AUDIO/VIDEO INPUTS/OUTPUTS

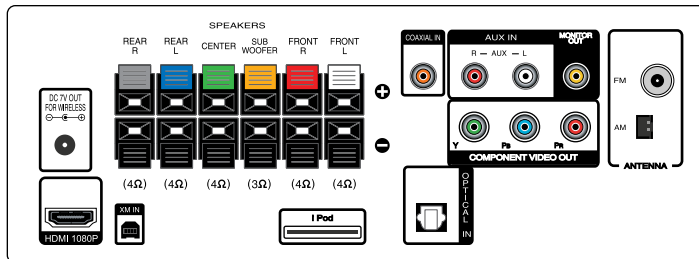

FRONT

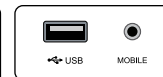

LG Electronics U.S.A., Inc. 1000 Sylvan Avenue, Englewood Cliffs, NJ 07632 (800)243-0000

© 2007 LG Electronics U.S.A., Inc., Englewood Cliffs, NJ. LG Design and Life's Good are trademarks of LG Electronics, Inc. All other trademarks are the property of their respective owners. Design and specifications subject to change without notice. 03/29/07

www.LGusa.com