

# Installation requirements and pointers

DMT800/610/400/350 Series, DW80F800/DW80F600 Series

English

These are not complete instructions. For complete installation instructions, see the "Installation Guide".

## 1. Check the enclosure size.

This dishwasher is designed to be enclosed on the top and on both sides by a standard residential kitchen cabinet unit.

The enclosure must be at least 24 inches wide, 24 inches deep, and 34 1/8 inches high.

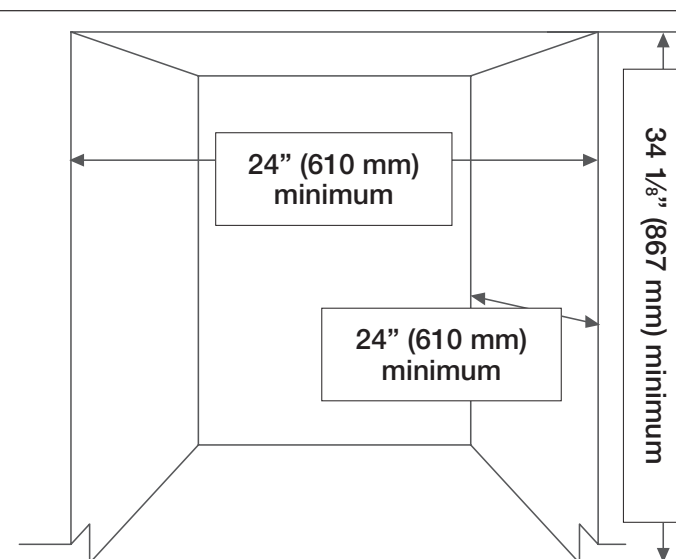

## 2. Check requirements.

### Hot water requirements

- You must attach your dishwasher to a hot water supply line.
- The hot water supply line pressure must be between 20–120 psi (140–830 kPa).
- The hot water must be between 120 °F (49 °C) –149 °F (65 °C).

### Electrical requirements

- The electrical supply in your home must provide the voltage and amperage displayed on the rating plate of the dishwasher: 15 amps, 120 volts, 60Hz AC.
- The power cable must not extend more than 4 ft (1.2 m) from the side of the dishwasher.
- No other appliance can be connected to the same power outlet or power line as the dishwasher.

### Drainage requirements

- For the drain to operate properly, the dishwasher should be installed within 9.8 ft (3 m) of the sink.

## 3. Prepare the cabinet.

If this is a new installation, cut a hole into the side of the cabinet that holds the sink using a 2 1/2 inch hole saw. If the base inside the sink cabinet is raised above the kitchen floor and is higher than the connections on the dishwasher, make a hole in the base inside the cabinet and in the cabinet side below the inside base.

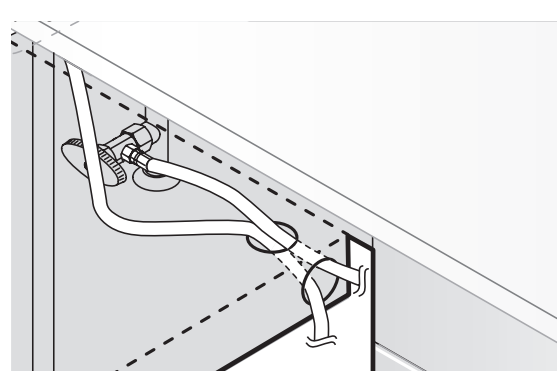

## 4. Check the parts and tools.



2 installation brackets



2 flat head screws (for the installation bracket)

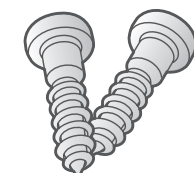

2 screws (for the side walls)

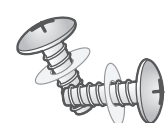

2 screws (for the kick plate)

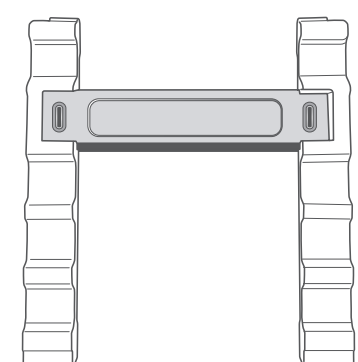

Kick plate is attached to packing parts

After unboxing the dishwasher, make sure you have found the included parts listed above. Also make sure you have the tools listed on pages 5 and 6 in the Installation Guide.

## 5. Inspect the dishwasher.

- Check the hot water connection on the front left-side of the base of the dishwasher. The mounting plate should be secured to the front of the base, the threads inside the connection should be smooth and shiny, and the area should be clean and free of any debris.
- Confirm the junction box cover is secured to the junction box on the front right-side of the base of the dishwasher. Confirm the electrical box was not damaged during shipping and that it is secured to the base of the dishwasher.
- Check the door latch, the operation of the hinges, and confirm the door is properly secured to the dishwasher.
- Confirm there are no dents or scratches anywhere on the dishwasher.

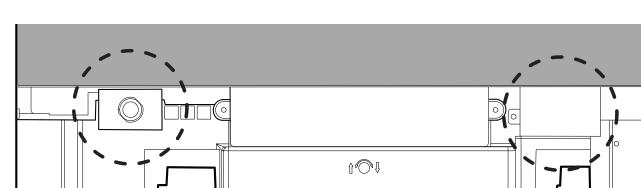

Front bottom of dishwasher

## 6. Prepare the dishwasher.

Turn off the circuit breaker and water supply valve before proceeding.

Wrap Teflon tape around the threads of the 90° elbow, and then attach the elbow to the Inlet valve. Tighten until the elbow is tight and pointing towards the water hose channel in the base of the dishwasher (about 4 o'clock).

Remove the junction box cover located at the bottom front right of the dishwasher using a screwdriver, and then install the strain relief.

Keep the junction box. You will need it later. If the countertop is made of wood or a material that is not damaged by drilling, attach the two (2) Installation brackets that were supplied with the dishwasher to the dishwasher using the supplied screws. Cut the strings securing the drain hose to the back of the dishwasher. Roll-out the hose. Make sure there are no kinks and that the hose is not bent at any extreme angles that could constrict the flow of water.

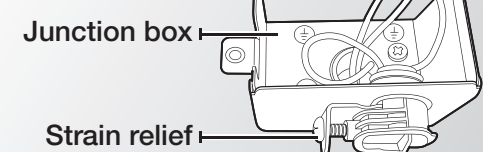
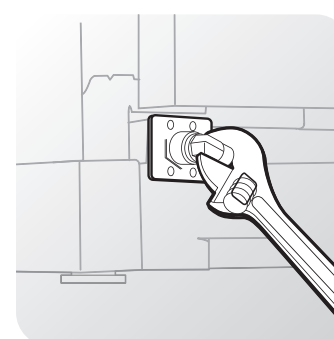

Junction box  
Strain relief

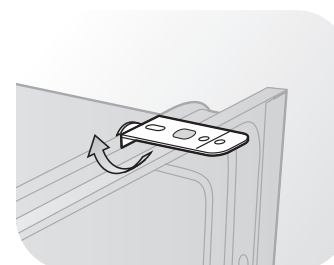

## 7. Place the dishwasher.

Place the dishwasher so that the water supply line is in the left channel and the power cable is in the right channel of the base of the dishwasher. Use standard duct tape or cable ties to secure the water line and electrical cable to their adjacent channels in the base. This can prevent the water line and electrical cable from being squeezed when you push the dishwasher into place.

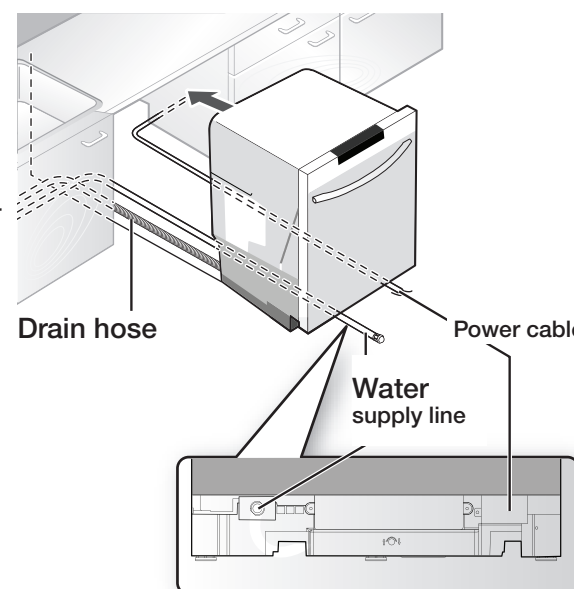

Drain hose  
Power cable  
Water supply line

## 8. Attach the water line.

Make sure the water supply line is not twisted, and then connect the water supply line to the elbow joint.

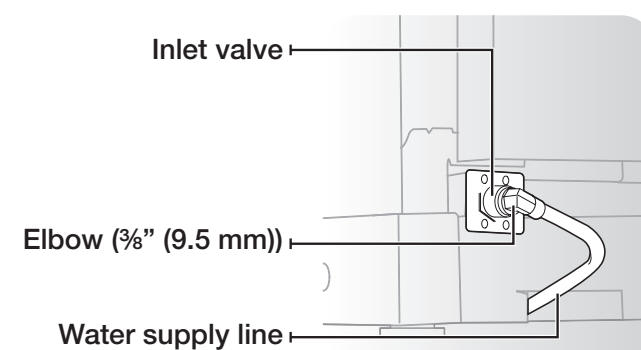

Inlet valve  
Elbow (3/8" (9.5 mm))  
Water supply line

# Installation requirements and pointers

DMT800/610/400/350 Series, DW80F800/DW80F600 Series

English

These are not complete instructions. For complete installation instructions, see the "Installation Guide".

## 9. Use the carton bands.

Use the carton bands (minimum of 4 feet long) to pull the water line, drain hose, and power cables through the holes in the cabinets as shown below.

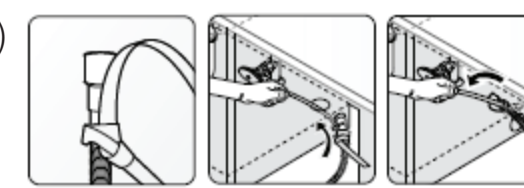

## 10. Slide into the enclosure.

Slide the dishwasher carefully into the installation space. If possible, gently pull any excess lengths of water supply line, drain hose, or electrical cable back as you move the dishwasher. Get a second or third person to help you do this if necessary. Make sure you leave at least ten inches of the electrical cable protruding beyond the bottom of the dishwasher. You will connect the electrical cable later.

Make sure that the dishwasher does not rest on the water supply line, drain hose, or electrical cable. Also make sure that the water supply line, drain hose, or electrical cable are not kinked, folded, or twisted.

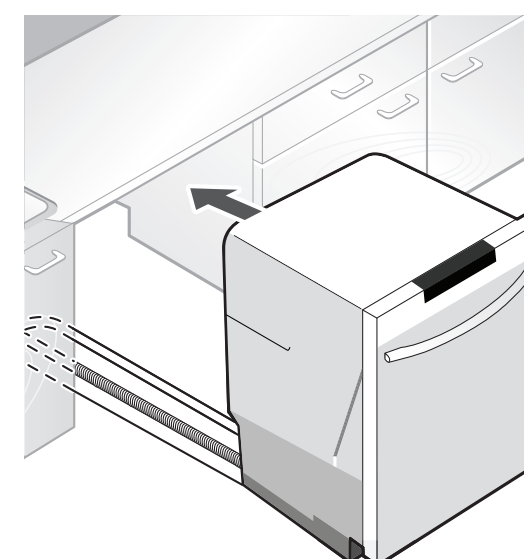

## 11. Level the dishwasher.

Using a level, check if the dishwasher is level side to side and front to back.

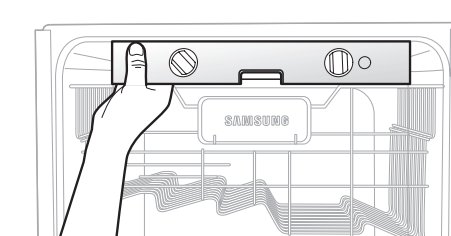

Side to side

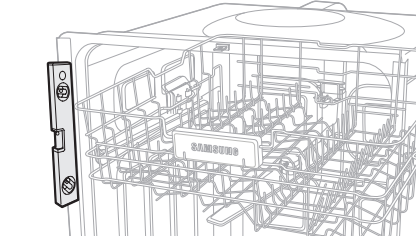

Front to back

If the dishwasher is not level side to side, rotate the leveling legs on the bottom front of the dishwasher until the dishwasher is level. Turn clockwise to lower and counterclockwise to raise. If the dishwasher is not level front to back, adjust the height of the rear leg by turning the hex bolt (at the front of the base). Turn to the left to raise the back of the dishwasher and the right to lower. Use a hex L-wrench or similar tool to turn the hex bolt.

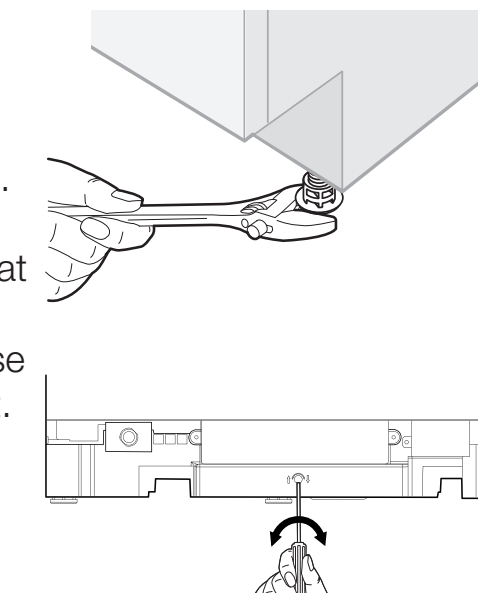

## 12. Secure the dishwasher.

If the counter top is made of wood or another material that will not be damaged by drilling, secure the dishwasher to the bottom of the counter top by carefully passing a drill bit through the holes in the installation brackets and then drilling a screw hole. Then, insert the screws provided and tighten.

**Note:** If the installation brackets on the front of the dishwasher extend beyond the bottom of the counter top, cut them down using a nipper before you drill the holes. If the counter top is made of granite, marble, or any other material that can be damaged by drilling, secure the dishwasher by removing the tub spacer caps, carefully passing a drill bit through the holes that are revealed and drilling a screw hole. Then, insert a provided screw into each hole and tighten. Replace the tub spacer caps.

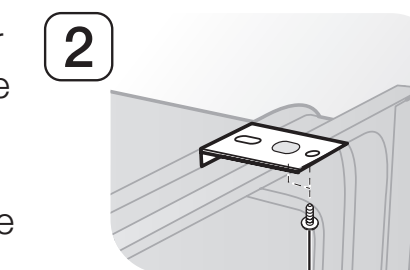
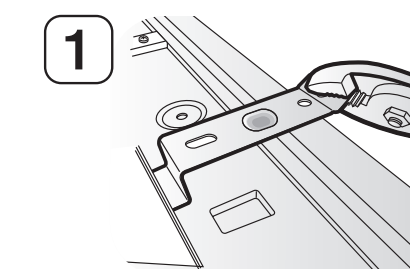

Screw to countertop

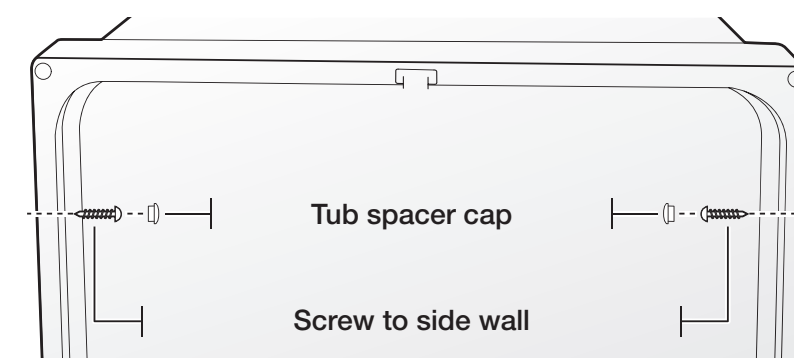

Tub spacer cap  
Screw to side wall

## 13. Connect the drain hose.

How you connect the drain hose depends on whether or not you have a disposal and whether or not you have an air gap. The primary connections methods are illustrated below.

### Without a disposal

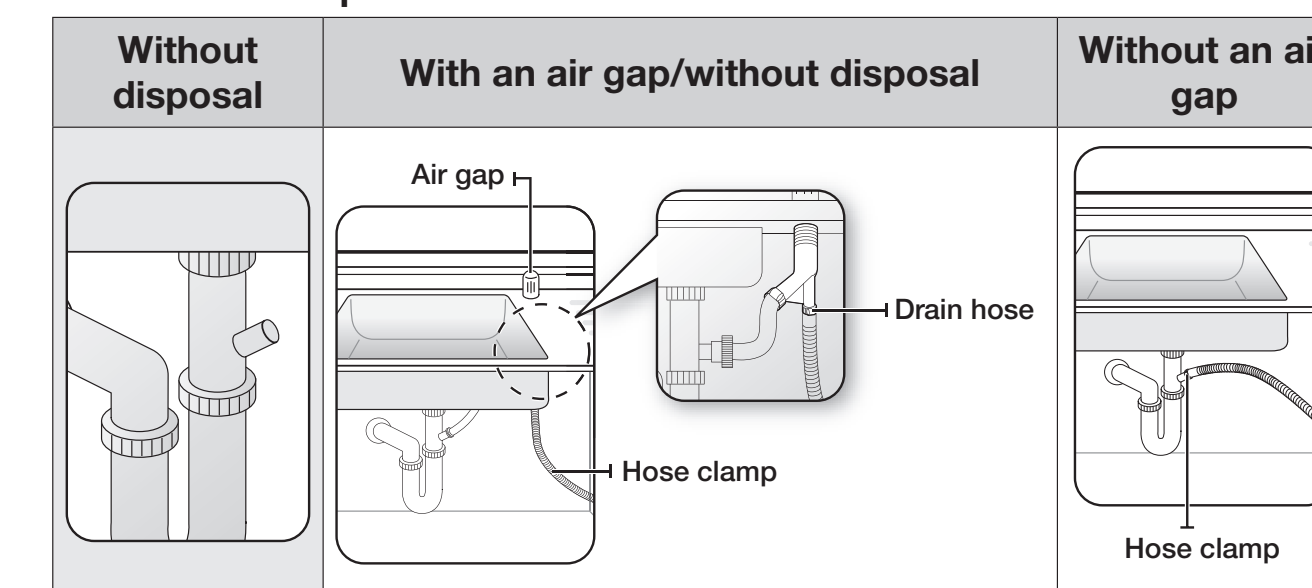

### With a disposal

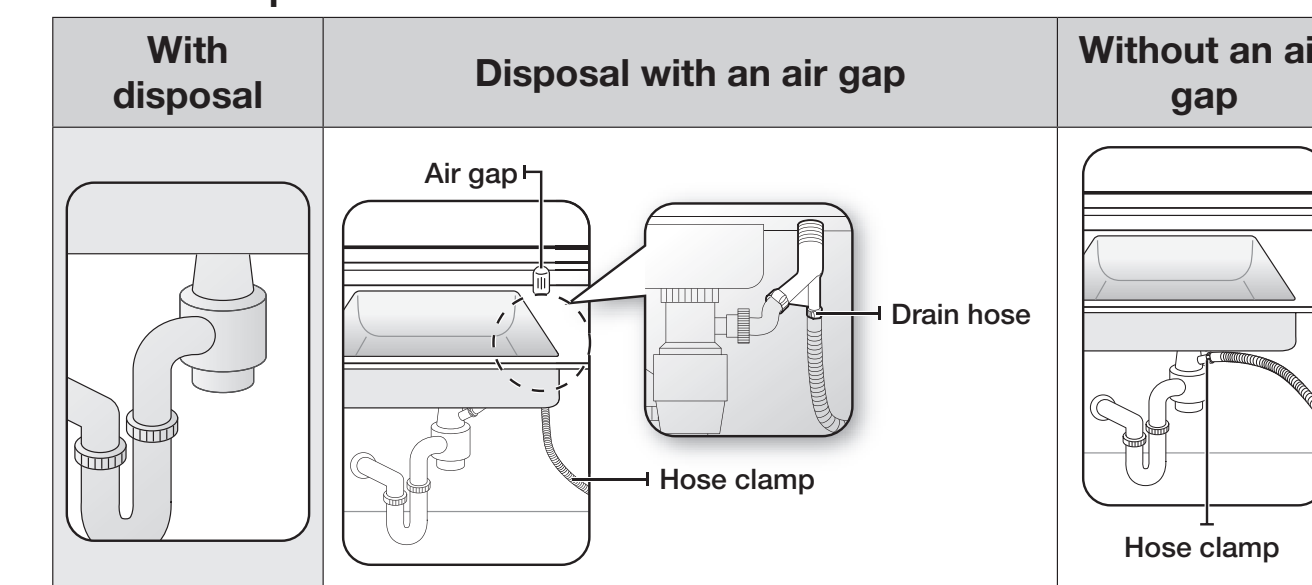

## 14. Connect the wiring.

- Before connecting the power cable to the dishwasher, make sure the circuit breaker is off.
- In the junction box located at the front bottom right of the dishwasher, find the three power wires from the dishwasher including the grounding line.
- Pass the power cable through the strain relief, and then into the junction box.
- Connect the black wire of the dishwasher to the black wire of the power cable by inserting both into a wire nut and then rotating the wire connector. Connect the white wire to the white wire and the green to the green in the same manner.

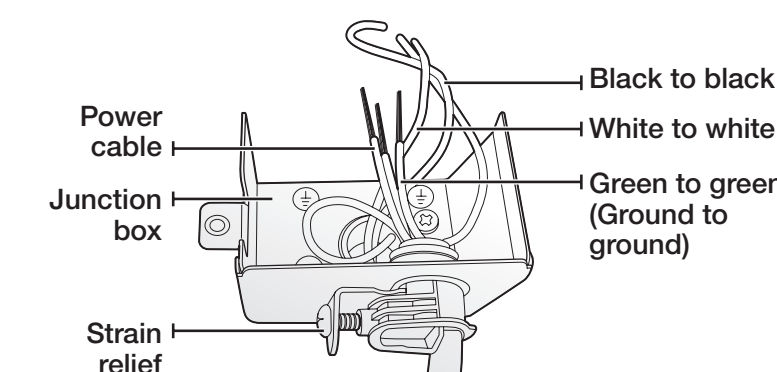

Black to black  
White to white  
Green to green (Ground to ground)

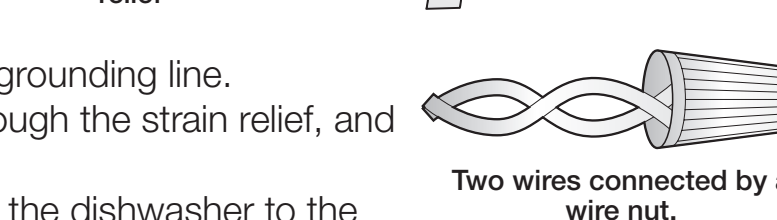

Two wires connected by a wire nut.

## 15. Test the dishwasher.

- Replace the junction box cover.
- Open the dishwasher door and remove all foam, paper packaging, and unnecessary parts.
- Turn on the circuit breaker you turned off before you began the installation.
- Open the water supply valve to supply water to the dishwasher.
- Turn on the dishwasher, and then select and run a cycle.
- Make sure the power comes on correctly and check for leaks. Check for water leakage on both ends of the water supply line and drain hose connector.

## 16. Attach the kick plate.

Confirm that the kick plate gasket is on the bottom of the kick plate. To install the kick plate, use the screws provided and refer to the figure below.

