

11. Install locally supplied countertop.

Viking outdoor cabinets are designed for a minimum countertop thickness of 1 1/8" (2.9 cm) such as you would find with granite or quartz material. If a countertop material thicker than 1 1/2" (3.8 cm) is used, the appliances should be shimmed to the proper height. In instances where Viking grills are installed in Viking cabinets against a non combustible surface (such as a house wall), they should be installed with a 3 1/2" (8.9 cm) countertop overhang from the wall to the back of the deepest cabinet. (Refer to grill specifications). If a finished side panel is desired, a SP33 (refer to chart below) should be installed to cover the 3 1/2" (8.9 cm) space that would result behind the deepest cabinet in the cabinet run.

The refrigerator back panel accessory (FBP) is used to provide a solid attachment surface for a side panel, (SP24, SP30, or SP33), and a strong frame for attaching a countertop. If a 15" W. or 24" W. refrigerated beverage center, wine cellar, or ice machine is desired at the end of the cabinet run where any side panel is used, the FBP accessory back panel needs to be used. These panels can be adjusted from 15" to 24" widths simply by unscrewing the four (4) middle screws, sliding the panel in or out and reinstalling the screws. The FBP is attached to the end cabinet at the rear by using 1 1/4" (3.2 cm) self-tapping coarse threaded screws, (provided by installer), into the connection extrusions. The side panel is then attached to the connection extrusions on the other end of the FBP in the same manner. The appliance is placed in front of the connection extrusions at the desired location matching the front of the cabinets. The countertop is then installed.

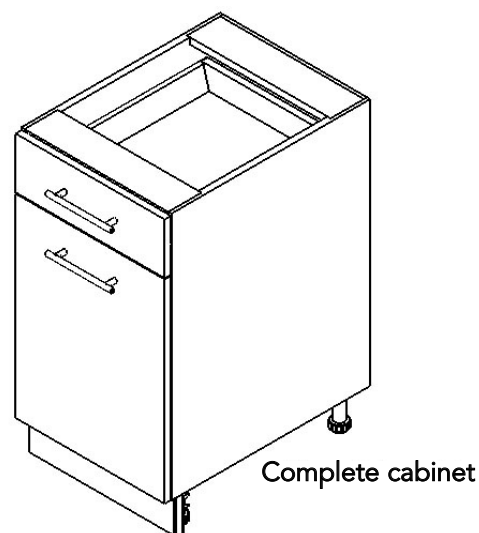

12. Install Viking appliances per each appliance's installation instructions.

## BASIC SPECIFICATIONS

	OVERALL WIDTH	OVERALL HEIGHT	OVERALL DEPTH
VOBB1601	15 5/8" (39.7 cm)	34 1/2" (87.6 cm)	29 7/8" (75.9 cm)
VOBC1811, including doors	18" (45.7 cm)	34 1/2" (87.6 cm)	24 3/4" (62.9 cm)
VOTP1810, including doors	18" (45.7 cm)	34 1/2" (87.6 cm)	24 3/4" (62.9 cm)
VOBC1830, including doors	18" (45.7 cm)	34 1/2" (87.6 cm)	24 3/4" (62.9 cm)
VOSB2402, including doors	24" (61.0 cm)	34 1/2" (87.6 cm)	24 3/4" (62.9 cm)
VOSB3602, including doors	36" (91.4 cm)	34 1/2" (87.6 cm)	24 3/4" (62.9 cm)
VOKB2601	26 3/8" (67.0 cm)	34 1/2" (87.6 cm)	29 7/8" (75.9 cm)
VOQB3021, VOQW3010	30 1/4" (76.8 cm)	34 1/2" (87.6 cm)	29 7/8" (75.9 cm)
VOQB4121, VOQW4120	41 7/8" (106.4 cm)	34 1/2" (87.6 cm)	29 7/8" (75.9 cm)
VOQB5322, VOQW5311	53 7/8" (136.8 cm)	34 1/2" (87.6 cm)	29 7/8" (75.9 cm)
VOER3000	30" (76.2 cm)	68" (172.7 cm)	29 7/8" (75.9 cm)
VOET3002	30" (76.2 cm)	68" (172.7 cm)	29 7/8" (75.9 cm)
SP24	24 7/8" (63.2 cm)	34 1/2" (87.6 cm)	3/4" (1.9 cm) thickness
SP30	29 7/8" (75.9 cm)	34 1/2" (87.6 cm)	3/4" (1.9 cm) thickness
SP33	33 3/8" (84.8 cm)	34 1/2" (87.6 cm)	3/4" (1.9 cm) thickness
TP30	30 1/8" (76.5 cm)	3/4" (1.9 cm)	29 7/8" (75.9 cm)
FBP	15" (37.1 cm) min. 24" (61.0 cm) max.	29 3/4" (75.6 cm)	4 1/4" (10.8 cm)

NOTE: The CF90 and CF135 (corner fillers) are 3" (7.6 cm) on each side and are to be mounted flush with the doors, not the cabinet face. The FILL3 (filler strip with toe kick) is 3" (7.6 cm) wide and is to be mounted flush with the doors, not the cabinet face.