

ZSL-E42AS ZSL-E48AS

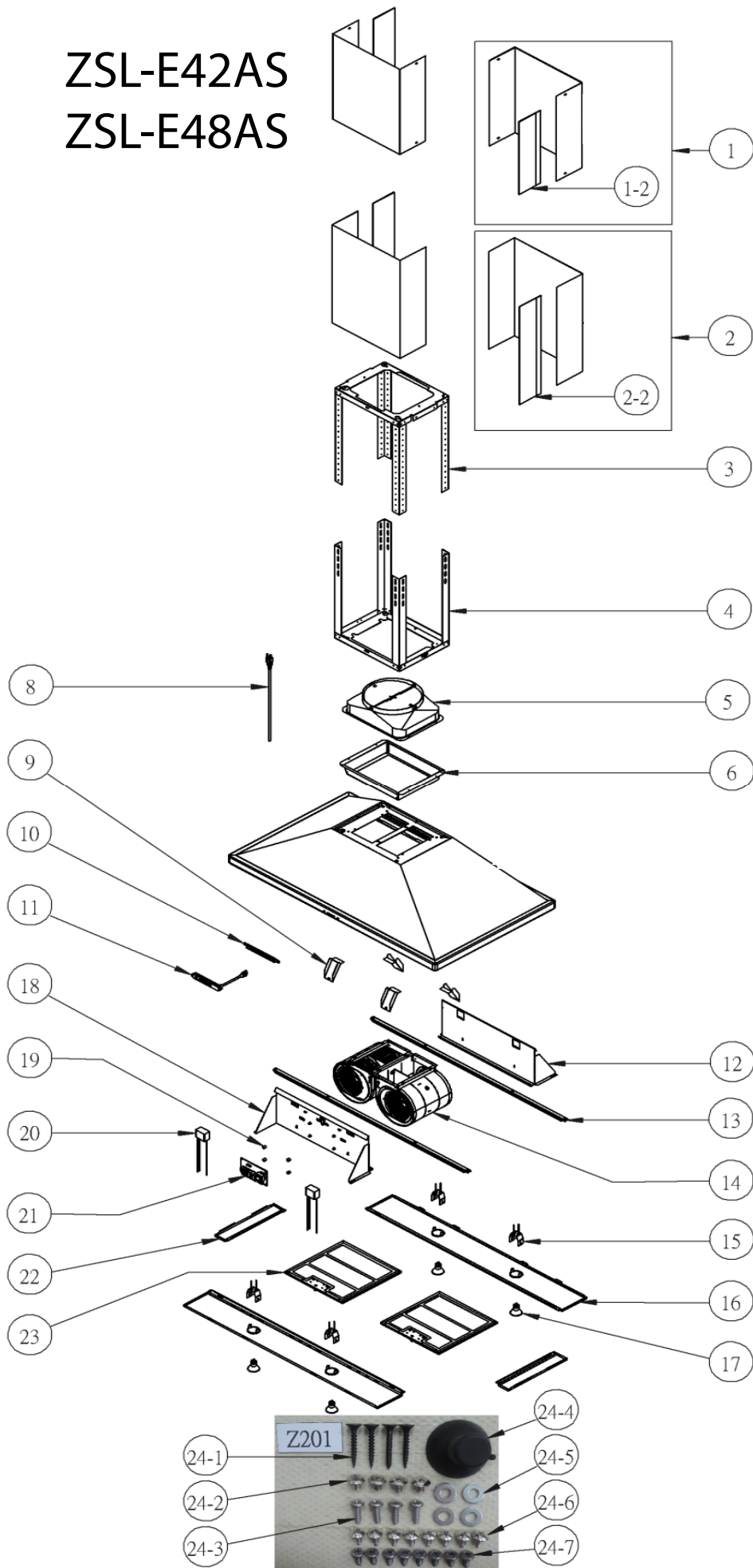



Siena Pro Island

ZSL-E42AS, ZSL-E48AS

| Ref # | Part # | Description | Qty. |
|-------|----------|---------------------------|------|
| 1 | 50050160 | Duct Cover, Upper | 2 |
| 1-2 | 54220005 | Magnet, Upper Duct Cover | 2 |
| 2 | 50050161 | Duct Cover, Lower | 2 |
| 2-2 | 54220006 | Magnet, Lower Duct Cover | 2 |
| 3 | 54110098 | Support Frame, Upper | 1 |
| 4 | 54110099 | Support Frame, Lower | 1 |
| 5 | 54050081 | Collar, 10" Round | 1 |
| 6 | 54050082 | Adaptor, 10" Collar | 1 |
| 8 | 11030081 | Power Cord | 1 |
| 9 | 52110021 | Cover, Power Cord | 4 |
| 10 | 54140154 | Bracket, Switch | 1 |
| 11 | 11000084 | Switch Assembly | 1 |
| 12 | 52110022 | Cover, Rear Internal | 1 |
| 13 | 54140186 | Support Bar (ZSL-E42AS) | 2 |
| 13 | 54140187 | Support Bar (ZSL-E48AS) | 2 |
| 14 | 12120075 | Motor | 2 |
| 15 | 50500140 | Light Socket Assembly | 4 |
| 16 | 50110155 | Panel, Light (ZSL-E42AS) | 2 |
| 16 | 50110156 | Panel, Light (ZSL-E48AS) | 2 |
| 17 | Z0B-0020 | Bulb, Halogen, GU-10, 50W | 4 |
| 18 | 52110023 | Cover, Front Internal | 1 |
| 19 | 56240022 | Spacer | 4 |
| 20 | 12050028 | Capacitor | 2 |
| 21 | 11010060 | Control Board | 1 |
| 22 | 50120086 | Panel, Side (ZSL-E42AS) | 2 |

| | | | |
|------|----------|--------------------------------|---|
| 22 | 50120068 | Panel, Side (ZSL-E48AS) | 2 |
| 23 | 50210025 | Filter, Baffle (ZSL-E48AS x 3) | 2 |
| 24 | 05000111 | Hardware Packet | 1 |
| 24-1 | 01090001 | Screw, M6 x 1" | 4 |
| 24-2 | 01020011 | Screw, 3/16 x 1/4 | 4 |
| 24-3 | 01070021 | Screw, M4 x 12mm | 4 |
| 24-4 | 15000004 | Suction Cup | 1 |
| 24-5 | 02170001 | Washer | 4 |
| 24-6 | 01070022 | Screw, M4 x 8mm | 8 |
| 24-7 | 01070010 | Screw, M4 x 8mm | 8 |

APR15.0101