

Exterior Blowers

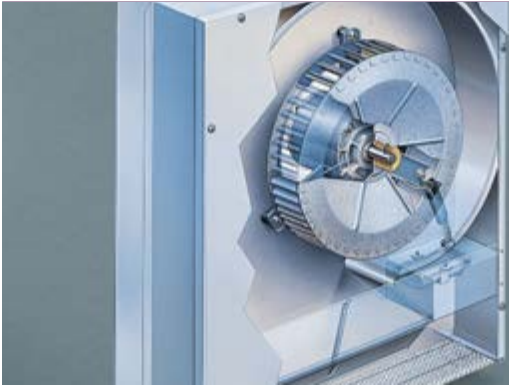

BEST® Exterior blowers provide exceptional performance and minimal sound levels by moving the blower to an exterior wall or the roof. Exterior blowers will handle the rigorous needs of professional-style cook tops and ranges. Durable, sealed blower housings are crafted from weather-resistant aluminum and can be painted to match the roof or wall color scheme. The table below will help you select an exterior blower matched to the heat output of your range hood. See page 70 for more information on selecting the right blower for your range or cooking style.

| Series | EB6 | EB9 | EB12 | EB15 |
|---------------------------------|--|--|--|--|
| Type | Exterior | Exterior | Exterior | Exterior |
| Vertical CFM/Sones | 600 / NA | 900 / NA | 1200 / NA | 1500 / NA |
| Horizontal CFM/Sones | NA* | NA* | NA* | NA* |
| Duct Size ¹ | 10" Round | 10" Round | 10" Round | 10" Round |
| Duct Direction | Vertical* | Vertical* | Vertical* | Vertical* |
| Backdraft Damper ² | Yes | Yes | Yes | Yes |
| Amps at 120V | 2.4 | 5.7 | 3 | 4.3 |
| Motor Type ³ | Single Speed | Single Speed | Single Speed | Single Speed |
| Hood Compatibility ¹ | IP29, UP26M, UP27M, WP28M, WP29M, PIK, All EX & E models | IP29, UP26M, UP27M, WP28M, WP29M, PIK, All EX & E models | IP29, UP26M, UP27M, WP28M, WP29M, PIK, WPD39M, All EX & E models | IP29, UP26M, UP27M, WP28M, WP29M, PIK, WPD39M, All EX & E models |

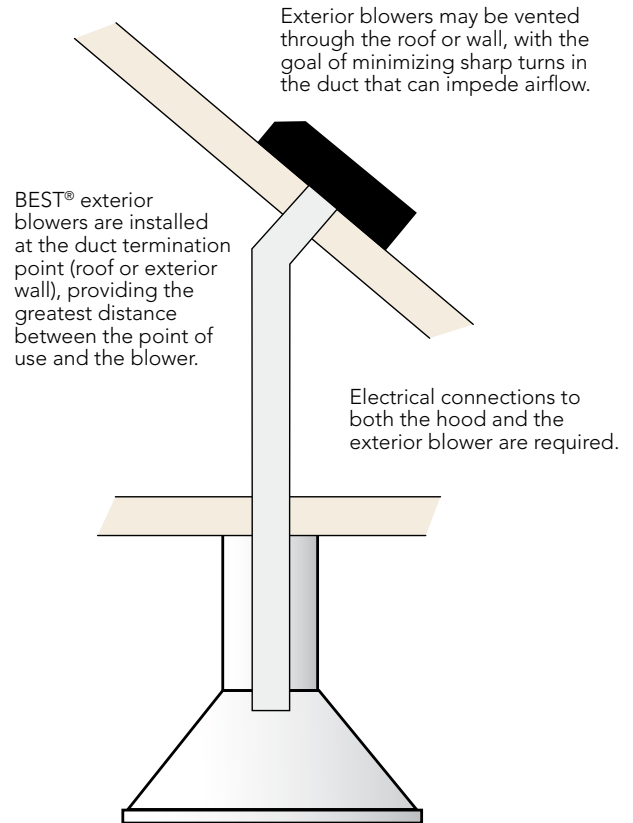

¹ Most "EX" & "E" models require a transition (model 414) from 8" to 10" for use with External Blowers. BEST® blowers are designed and UL Certified for use with BEST® products only.

² In cold climates, a separate In-line damper (model 421) is recommended.

³ All BEST® blower motors are thermal overload protected.

* Exterior Blower duct connection can be attached to the back (horizontal) of the WP29M.

EB6 and EB9

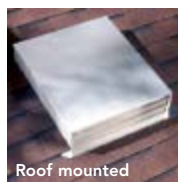
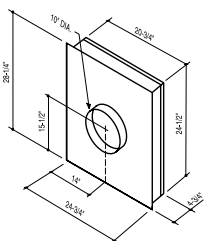

EB12 and EB15

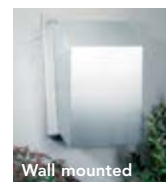
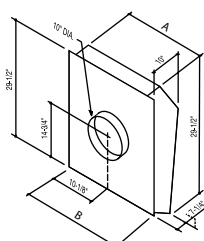

| Model | Width "A" | Width "B" |
|-------|-----------|-----------|
| EB12 | 22" | 18" |
| EB15 | 25" | 21" |