

BOSCH

YOUR LIFE. OUR INSPIRATION.

DISHWASHER USE AND CARE MANUAL

MODEL: SHE44C / SHE46C / SHE47C / SHE56C / SHU43C / SHX46A / SHX46L / SHX43E
SHV46C / SHE43F / SHE43M / SHX43M / SHE45M / SHV45M / SHX45M / SHE55M





GUIDE D'ENTRETIEN ET D'UTILISATION DU LAVE-VAISSELLE

MODÈLE: SHE44C / SHE46C / SHE47C / SHE56C / SHU43C / SHX46A / SHX46L / SHX43E
SHV46C / SHE43F / SHE43M / SHX43M / SHE45M / SHV45M / SHX45M / SHE55M

MANUAL DE USO Y CUIDADO PARA LAVADORA DE PLATOS

MODELOS: SHE44C / SHE46C / SHE47C / SHE56C / SHU43C / SHX46A / SHX46L / SHX43E
SHV46C / SHE43F / SHE43M / SHX43M / SHE45M / SHV45M / SHX45M / SHE55M



Model Number	SHE44C	SHE46C	SHE47C	SHE56C	SHU43C	SHX43E	SHX46A	SHX46L	SHV46C	SHE43M	SHX43M	SHE45M	SHV45M	SHX45M	SHE55M	SHE43F
Control Panel Design	Exposed Front Control	Exposed Front Control	Exposed Front Control	Exposed Front Control	Exposed Front Control	Exposed Front Control	Exposed Front Control	Exposed Front Control	Exposed Front Control	Exposed Front Control	Hidden Top Control	Exposed Front Control	Hidden Top Control	Hidden Top Control	Exposed Front Control	Exposed Front Control
Audible Cycle Completion Signal	no	no	no	no	no	yes	yes	yes	yes	no	yes	yes	yes	no	yes	no
Clean Light	no	no	no	no	no	no	yes	no	yes	no	no	no	yes	yes	no	no
Countdown Display	yes	yes	yes	yes	yes	no	no	yes	no	yes	yes	yes	yes	yes	yes	yes
Refill Rinse Agent Indicator Light	yes	yes	Shown on Display as *	yes	yes	yes	yes	Shown on Display as *	yes	yes	Shown on Display as *	yes	Shown on Display as *	Shown on Display as *	yes	yes
Sanitized Indicator Light	yes	yes	Shown on Display as 	yes	yes	yes	yes	Shown on Display as 	yes	yes	Shown on Display as 	yes	Shown on Display as 	Shown on Display as 	yes	yes
Delay Start	no	19 hours	24 hours	19 hours	no	no	no	19 hours	no	19 hours	19 hours	19 hours	19 hours	19 hours	19 hours	no
Child Safety Latch	no	no	yes	no	no	no	no	no	no	no	no	no	no	no	no	no
Child Lock (control)	no	no	no	no	no	no	no	no	no	yes	no	yes	no	no	yes	no
Upper Rack Flip Tines	yes	yes	yes	yes	yes	yes	yes	yes	yes	yes	yes	yes	yes	yes	yes	yes
Lower Rack Flip Tines	no	yes	yes	yes	no	yes	yes	yes	yes	no	no	yes	yes	yes	yes	no
Silverware Basket	Standard	Premium Flexible	Premium Flexible	Premium Flexible	Standard	Premium Flexible	Premium Flexible	Premium Flexible	Premium Flexible	Standard	Standard	Premium Flexible	Premium Flexible	Premium Flexible	Premium Flexible	Standard
Top Rack Only or Half Load	no	yes	yes	no	no	no	yes	yes	yes	no	no	yes	yes	yes	yes	no
Extra Dry Heat	yes	yes	yes	yes	yes	no	no	yes	no	no	no	yes	yes	yes	yes	yes
OPTIDRY™	yes	yes	yes	yes	no	no	no	yes	no	no	no	yes	yes	yes	yes	no
Info Light	no	no	no	no	no	no	no	no	no	no	no	yes	yes	yes	yes	no
ECO	no	no	no	no	no	no	no	no	no	no	no	no	no	no	yes	no

resume the cycle, press the On/Off button and shut the dishwasher door.

Canceling or Changing a Cycle

To cancel or change a cycle, open the dishwasher door far enough to expose the control buttons then press and hold for three seconds the two buttons labeled "Cancel Drain" as shown in Figure 21.

Close the door and wait until the dishwasher completes the cycle (approximately 1 minute). Open the door and press the ON/OFF button.

You may now begin a new cycle.

Child Safety Latch (select models)

Your dishwasher is shipped from the factory with the Child Safety Latch disengaged and in the normal operating mode. Pull on the door handle to open the door. The Child Safety latch activation lever is located in the recess for the door handle. You must look up into the recess to find the Child Safety Latch activation lever (see Figure 22).

To activate the Child Safety Latch insert a matchstick or other non-metal object into the opening as shown in Figure 22. The activation lever will release and move toward the left.

You have now activated the Child Safety Latch. Each time you open the dishwasher door you will need to **slide the activation lever to the right** to release the door locking mechanism, you can then pull the door open (See Figure 23). After you open the door you should release the Child Safety Latch Activation lever and let it slide back toward the left.

To deactivate the Child Safety Latch insert a matchstick or other non-metal object into the opening as shown in Figure 24. Slide the activation lever to the right and hold. Remove the matchstick and release the lever. The feature has now been deactivated and you can open the door by pulling the handle.

Child Lock (select models)

The Child Lock feature allows you to disable the dishwasher control panel to prevent accidental activation. To activate this feature press and hold the button labeled "Child Lock" for 4 seconds and the "Child lock" indicator light will illuminate. To disable the feature, press and hold the "Child Lock" button for 4 seconds.

Dishware Drying

At the end of the cycle the dishwasher will stop and a period of condensation drying will follow. After drying, the cycle is complete and:

- the "Clean" light will illuminate (select models).
- the completion signal will sound (select models).
- the "Sanitized" light may appear. See section on Sanitization for more information.
- the countdown display will show "0" (select models).

NOTE: If your household water supply is too hot, your dishwasher's heating time may be reduced and the "Sanitized" light may not illuminate. Your Dishwasher Installation Manual has information on the recommended temperature for your household hot water supply.

NOTE: To accelerate and enhance drying, open the dishwasher door, pull the top rack a few inches out of the dishwasher, and prop the dishwasher door against the top rack.

Sanitized Light

When the Sanitized light appears, it means that the dishware and kitchenware that was just washed has been sanitized according to the requirements of the National Sanitation Foundation (NSF). For more information on NSF certification, refer to the Wash Cycle Information section of this manual.

Unloading the Dishwasher

Unload the bottom rack first.

Unload the silverware basket(s). They are easily removed for unloading.

Unload the top rack.

If the Extra Tall Item Sprinkler was installed, return the dishwasher to its normal condition (see the Loading Extra Tall Items instructions in the "Loading the Dishwasher" section of this manual).

Figure 21

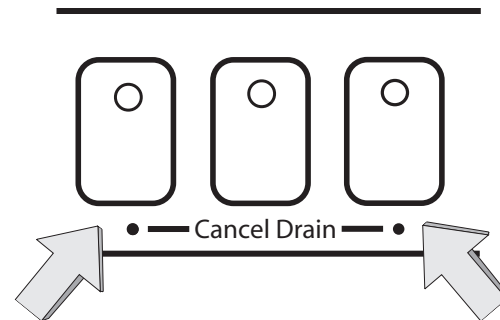

Figure 22

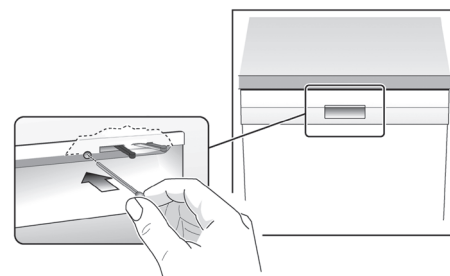

Figure 23

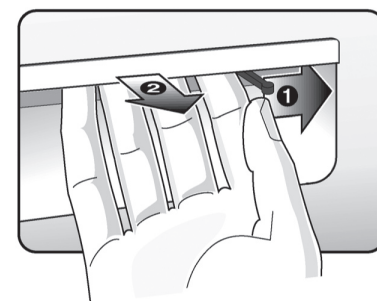

Figure 24

