



## 30" WARMING DRAWER PRO HANDLE

HWD30PS



### AVAILABLE MODELS

HWD30PS      30" Warming Drawer Pro Handle, Silver Stainless

#### GENERAL PROPERTIES

FINISH

SILVER STAINLESS STEEL

#### TECHNICAL INFORMATION

ELECTRICAL REQUIREMENTS

120V/60HZ

TOTAL CONNECTED LOAD

120V/60HZ/15A

TOTAL AMPS

4 AMPS

UTILITY LOCATIONS

RIGHT REAR ADJACENT  
CABINET OR BELOW  
INSTALLATION AREA

#### PRODUCT DIMENSIONS

APPLIANCE DIMENSIONS (W X H X D) (IN.)

30" X 10 1/8" X 24 29/64"

CUT OUT DIMENSIONS (W X D) (IN.)

28 1/2" X 24" DEPTH MINIMUM

DRAWER CAPACITY

1.73 CU. FT.



Electronic Control Panel

### FEATURES & BENEFITS

- Electronic Control Panel.
- Four Temperature Levels—Proof, Low, Medium and High (100-200°). Temperature will automatically set to the last temperature setting used when the drawer is turned on.
- Four Timer Settings—1, 2, 3 & 4 hours plus an infinite time mode which keeps the warming drawer on until you turn it off.
- The Infinite mode is very useful when you need the warming drawer on for extended periods of time like during parties and events or for use during the Sabbath.
- Blue LED Indicator lights.
- Large Capacity.
- 50 pound weight limit.
- Quick to heat with 500 watt heating element.
- Approved for installation under Dacor wall ovens, microwaves, cooktops and in under counter applications.

dacor

30" WARMING DRAWER PRO HANDLE

UNITS DIMENSIONS			
MODEL	A Drawer Face Width	B Chassis Face Width	C Chassis Width
HWD30PS	30" (76.2 CM)	29 5/8" (75.2 CM)	28 1/4" (71.8 CM)

CUTOUT DIMENSIONS					
MODEL	A	B	C	D	CUT OUT MIN.
HWD30PS	28 1/2"	30 1/4"	9 1/8"	1 1/4"	24"

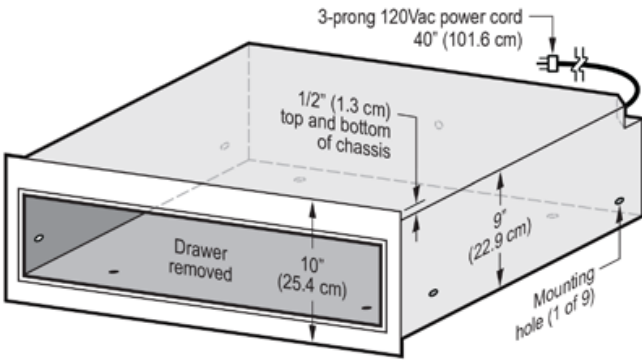
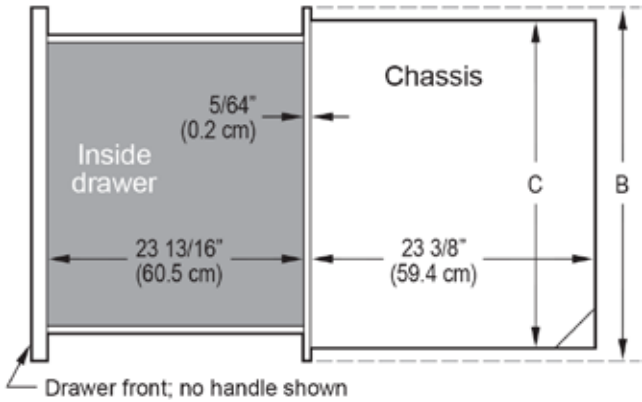

CUTOUT DIMENSIONS

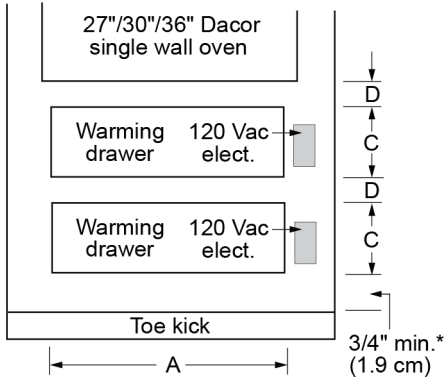
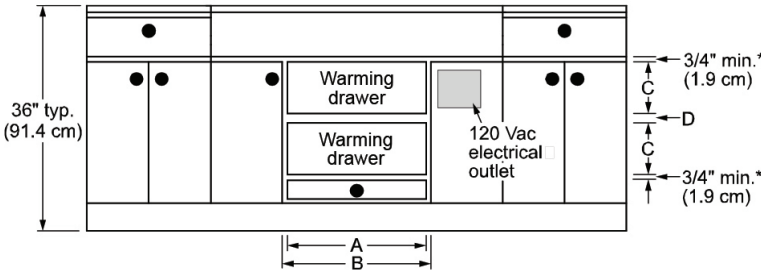

HANDLE DIMENSIONS

