

TIMELESS, COMFORTABLE, VERSATILE

The simplicity that makes you love it and the ease of use that improves everyday life, with the certainty of constant and enduring reliability.

Levante range hoods are also easy to clean and that satisfies all practical requirements while being remarkably effective in neutralizing fumes, vapors, and odors in the kitchen, making the environment even more comfortable.



AVAILABLE MODELS

Model #	Size / Color	Motor Class (CFM)
LEVE24SS200	24" Stainless Steel	200 CFM
LEVE24WH200	24" White	200 CFM
LEVE30SS200	30" Stainless Steel	200 CFM
LEVE20WH200	30" White	200 CFM

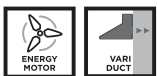

FOR INCREASED INSTALLATION OPTIONS AND BETTER ENERGY EFFICIENCY, **VARI-DUCT** ALLOWS AIR TO BE VENTED THROUGH THE TOP OR BACK OF THE RANGE HOOD.

LEVANTE E

UNDER CABINET HOOD



MODEL	SIZE/MATERIAL	MOTOR CLASS
LEVE24SS200	24" Stainless Steel	200 CFM
LEVE24WH200	24" White	200 CFM
LEVE30SS200	30" Stainless Steel	200 CFM
LEVE30WH200	30" White	200 CFM

FEATURES		PERFORMANCE		ACCESSORIES
Dimensions		Motor		FILTER8 Charcoal Filter Replacement
Canopy Depth-Height	21" D x 5 1/2" H	No. of Fan Speeds	2	
Ducting		Motor Class		
Type	Ducted/Ductless Charcoal Kit Included	Energy-Efficient Motor	200	
Top Vent	Vari-Duct 7" Round,	Display		
Rear Vent	3 1/4" x 10" Rectangle	Controls	Rocker Switch	
Lighting		Other		
Type	Incandescent	ADA Compliant	With Separate Wall Switch	
# of Bulbs	One - 40 Watt - 1 Level	Fixed Wiring Box	Yes	
Grease Filters				
Filter Type	Mesh			
Charcoal Filter	One Included			
Dishwasher Safe	Yes			

DIMENSIONAL DRAWINGS

FRONT

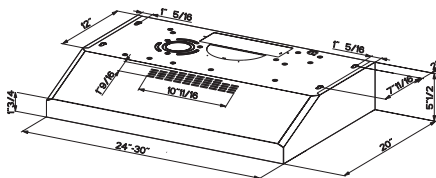

TOP VIEW

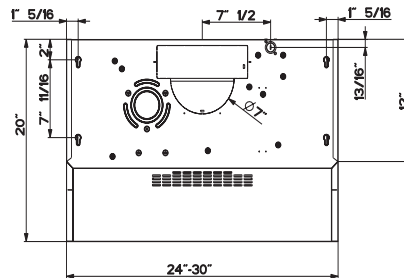

Rev1 522