

UPPER DUCT COVER MOUNTING TEMPLATE

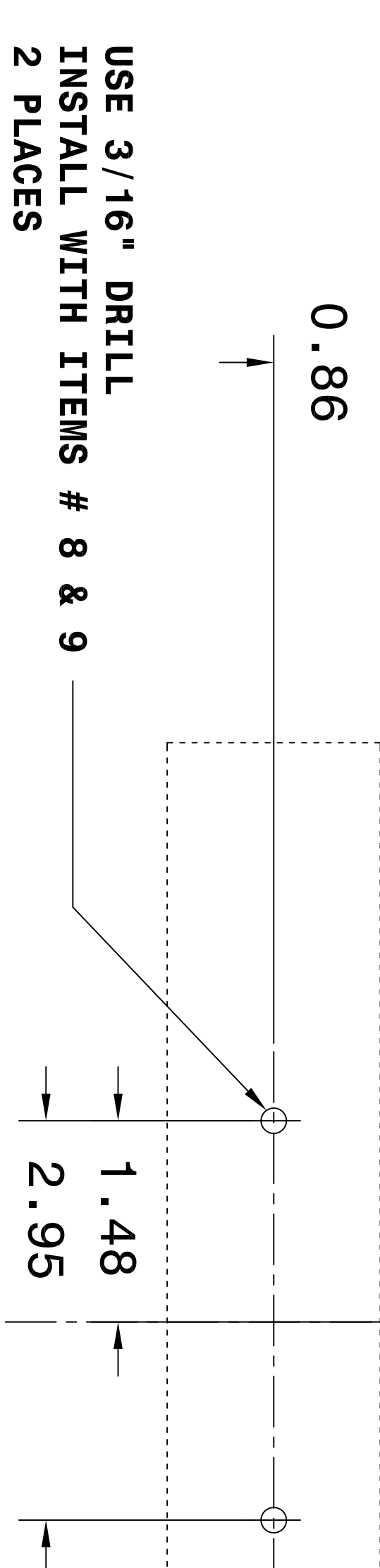

CUT ALONG THIS LINE

CEILING
 (cut on this line to locate templates at ceiling location.)
UPPER MOUNTING BRACKET - ITEM # 3
 Note: Place this template in ceiling corner to mount upper bracket for chimney cover.

USE 3/16" DRILL
 INSTALL WITH ITEMS # 8 & 9
 2 PLACES

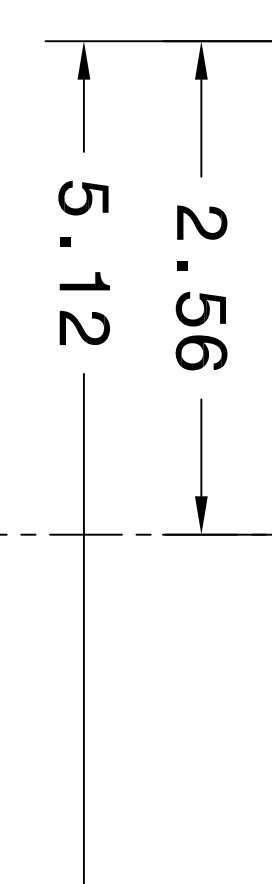

MOUNT BRACKET WITH NOTCH UP
LOWER DUCT COVER MOUNTING BRACKET - ITEM # 4

15.67

- RANGE HOOD LOCATION INSTRUCTIONS:**
- LOCATE CENTER OF COOKTOP
 - DRAW VERTICAL LINE ON WALL TO CEILING
 - FROM INSTALLATION GUIDE CHART - DETERMINE DESIRED VENT HOOD HEIGHT
 - DRAW HORIZONTAL LINE AT THIS HEIGHT
 - LOCATE AND TAPE TEMPLATE TO THE WALL FOR PROPER INSTALLATION
 - REFER TO INSTALLATION MANUAL FOR PROPER ASSEMBLY
- NOTE: LOWER AND UPPER MOUNTING HOLES ON RANGE HOOD BODY SHOULD BE ATTACHED TO WOOD STRUCTURE TO SUPPORT 150 LBS. REFER TO INSTALLATION GUIDE FOR DETAILS**



UPPER MOUNTING HOLES
 USE 1/8" DRILL
 INSTALL WITH ITEM # 11
 2 PLACES

8.27

UPPER MOUNTING HOLES
 USE 1/8" DRILL
 INSTALL WITH ITEM # 11
 2 PLACES

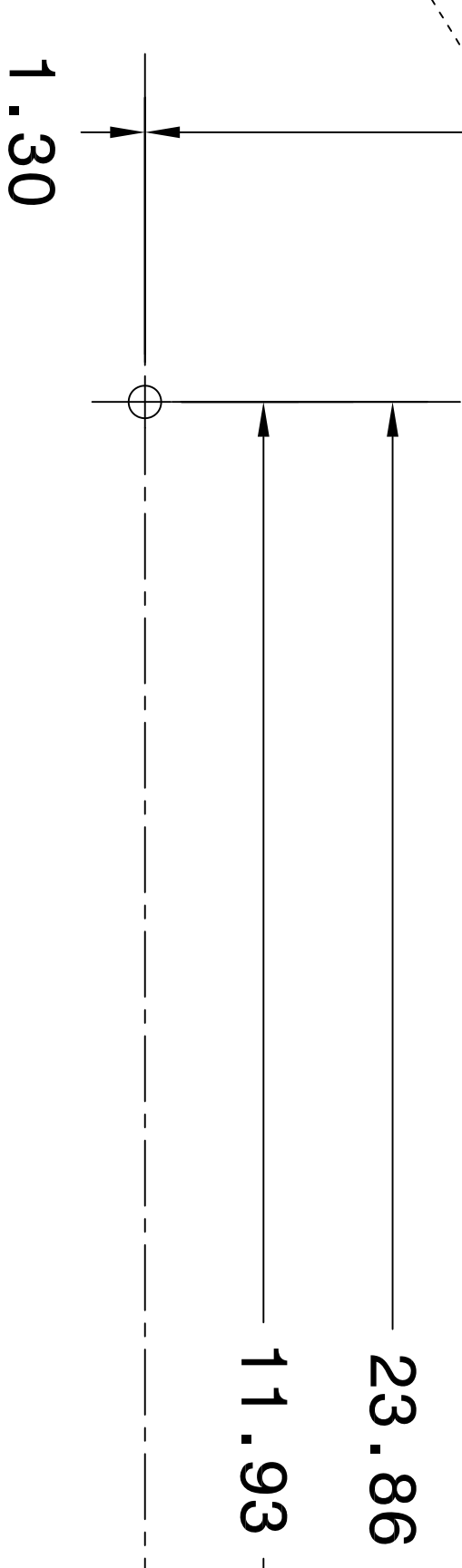

BOTTOM OF RANGE HOOD
 (cut on this line to locate templates at correct installation height.)

CENTERLINE OF PRODUCT LOCATION SHOULD MATCH CENTER OF COOKTOP

RANGE HOOD MOUNTING TEMPLATE FOR: FHMWC3655LS

PN: 316902459

39.00