

### ✓ INSTALLATION CHECKOFF LIST

#### Doors

- Handles are secure and tight
- Door seals completely to cabinet on all sides
- Freezer door is level across the top

#### Leveling

- Refrigerator is level, side to side and tilted 1/4" (6mm) front to back
- Toe grille is properly attached to refrigerator
- Cabinet is setting solid on all corners

#### Electrical Power

- House power turned on
- Refrigerator plugged in

#### Ice Maker

- House water supply connected to refrigerator
- No water leaks present at all connections - recheck in 24 hours
- Ice Maker is turned ON.

#### Final Checks

- Shipping material removed
- Fresh Food and Freezer controls set
- Crisper Humidity controls set
- Registration Card sent in

#### Tools Necessary:

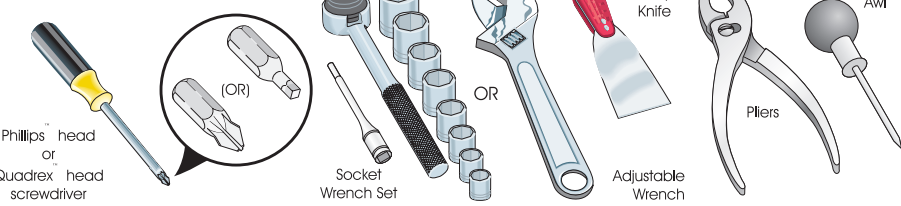

### 1 HAND TRUCKING

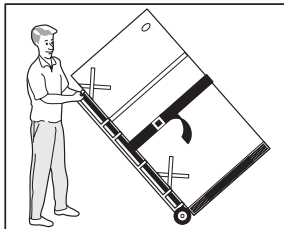

- Load refrigerator from side of cabinet only.
- Do not run retaining straps over handles.
- Do not over-tighten retaining straps.
- Never use refrigerator handles to move the refrigerator.
- Remove tape from doors only after unit is in place.

### 2 SHIPPING MATERIAL

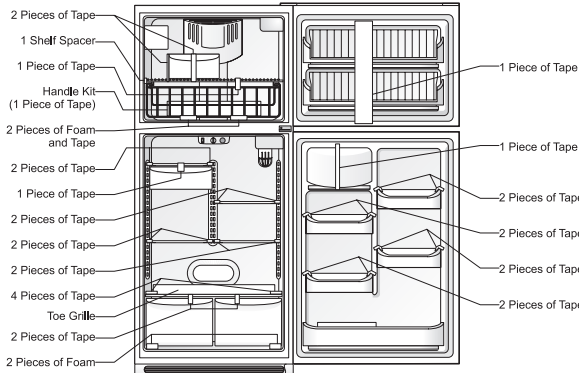

Remove Shipping material. (Features may vary per model.)

### 3 WATER SUPPLY

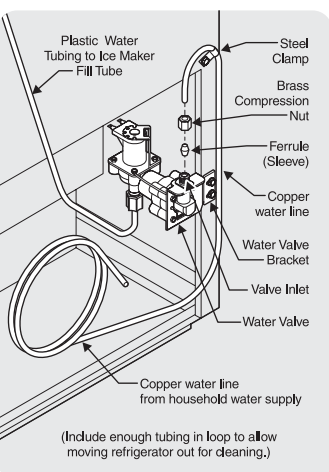

Connect water supply - check for water leaks. **Turn icemaker OFF if water supply is not connected immediately. Connecting to a reverse osmosis system is not recommended.**

The water valve on the back of the refrigerator will Click/Buzz if the water valve is closed.

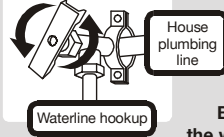

Be certain the water valve is open and there are no leaks.

### 4 INSTALLATION CLEARANCES

Allow the following clearances for ease of installation, proper air circulation, and plumbing and electrical connections:

- Sides & Top.....3/8"
- Back.....1"

#### NOTE

If you are installing your refrigerator beside a wall, leave 1/2" minimum between hinges and wall to allow for the door to swing open.

Refer to your *Owner's Use and Care Manual* for additional information about your refrigerator.

### 5 LEVELING AND ADJUSTING

All four corners of your refrigerator must rest firmly on a solid floor. Your refrigerator is equipped with adjustable front rollers or front leveling screws to help level your unit.

#### To level cabinet or change door height:

1. Remove toe grille.
2. Use flat-blade screwdriver or 3/8" socket wrench to adjust front rollers. Use adjustable wrench to adjust leveling screws.

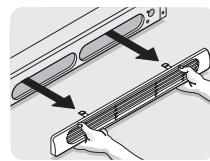

Toe Grille

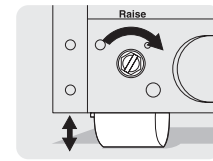

Adjustable Front Roller (some models)

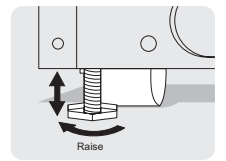

Stationary Front Roller with Leveling Screw (some models)

#### NOTE

Raise the front of the refrigerator enough so the doors close freely when opened halfway. The refrigerator should slope 1/4" to 1/2" from front to back. Then level the refrigerator from side to side.

### 6 CONTROLS

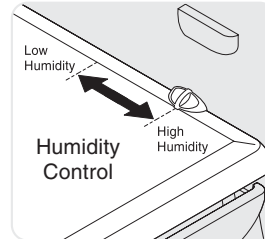

#### CONTROLS

When changing controls, wait 24 hours before making additional adjustments.

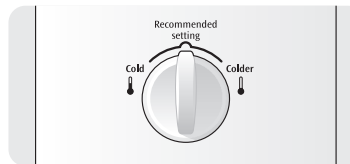
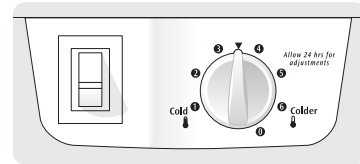
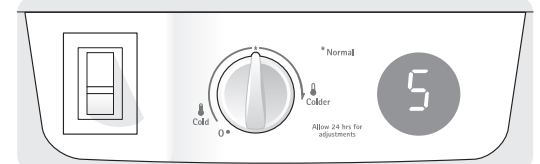
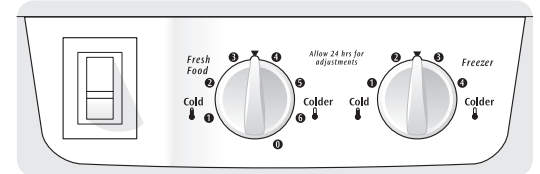

### 7 ICEMAKER

Ensure icemaker is turned ON.

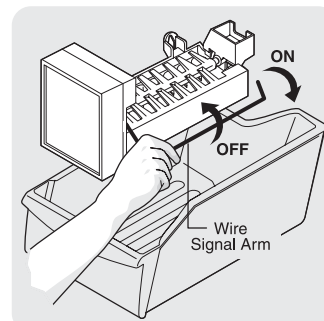

### 8 DOOR REMOVAL (IF NECESSARY)

If you need to remove the doors to get your refrigerator into the house please see "Door Removal and Reversal Instructions" in your *Use & Care Manual*.

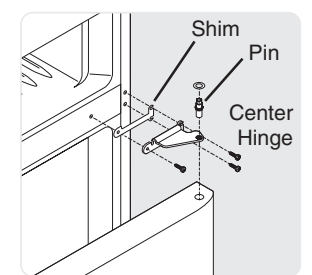
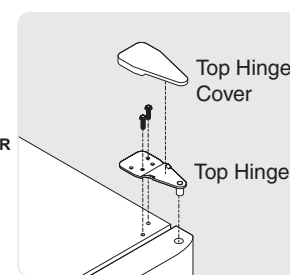
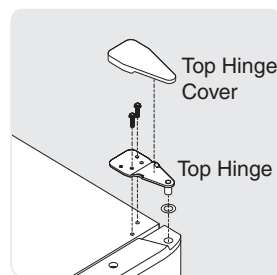
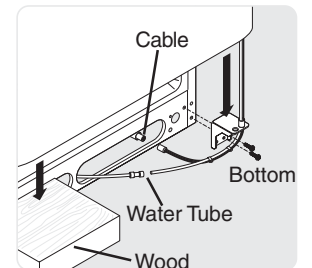

### 9

- ✓ See "Normal Operating Sights & Sounds" in the *Use & Care Manual* so you understand the sounds you may hear once your refrigerator is running.
- ✓ Please read entire *Use & Care Manual* to become aware of important safety instructions and to become familiar with your new refrigerator.
- ✓ Send in Registration card to register your refrigerator.
- ✓ Congratulations! You are ready to enjoy your new refrigerator.

**IF YOU ARE DISSATISFIED WITH THE INSTALLATION, PLEASE CALL THE STORE YOU PURCHASED IT FROM.**

