

GTS22KBP

GE® 21.7 Cu. Ft. Top-Freezer Refrigerator

Dimensions and Installation Information

Overall Dimensions	Height to top of hinge (in.) A	67-1/2
	Height to top of case (in.) B	66-7/8
	Height to mid-freezer (in.)	54-1/2
	Case depth without door (in.) C	27-5/8
	Case depth less door handle (in.) D	31-5/8
	Case depth with door handle (in.) E	33-5/8
	Depth with fresh food door open 90° (in.) F	63
	Width (in.) G	32-7/8
	Width with door open 90° with door handle (in.) H	35
Air Clearances	Each side (in.)	1/8
	Top (in.)	1
	Back (in.)	2

Note: All Top-Freezer No-Frost Right-Hand Refrigerator Doors:

As you face the front of the refrigerator, the handle is on your left and the hinges are on your right.

All Top-Freezer No-Frost Left-Hand Refrigerator Doors:

As you face the front of the refrigerator, the handle is on your right and the hinges are on your left.

Front View

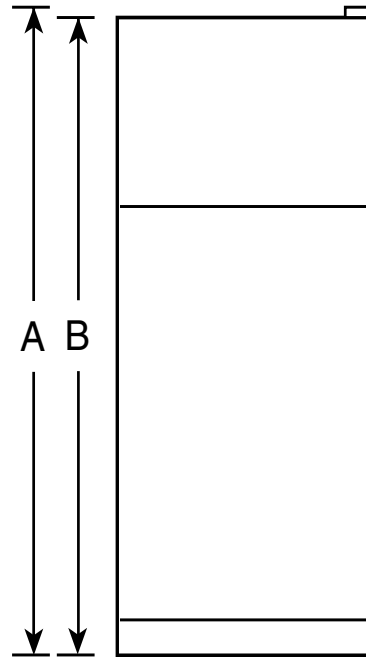

Top View

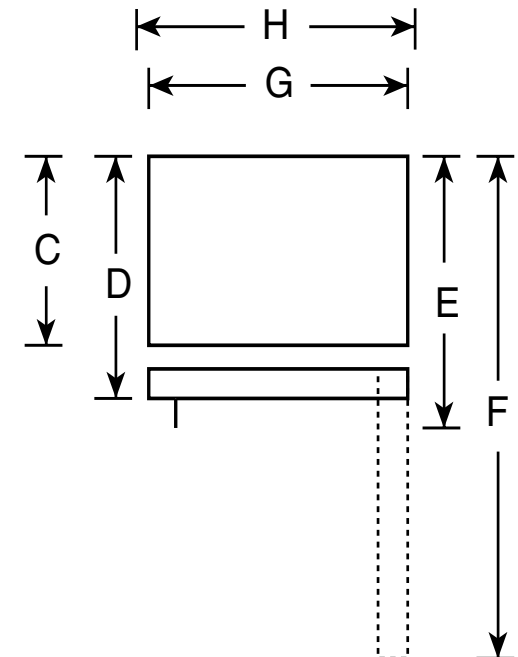

For answers to your Monogram,® GE Profile™ or GE® appliance questions, visit our website at ge.com or call GE Answer Center® service, 800.626.2000.

Dimension and installation information are shown in inches.



imagination at work



Total volume and shelf area are calculated by the Association of Home Appliance Manufacturers' standards.



Listed by Underwriters Laboratories



Specification Revised 4/13

310378

GTS22KBP

GE® 21.7 Cu. Ft. Top-Freezer Refrigerator

Features and Benefits

- GE® 21.7 Cu. Ft. Top-Freezer Refrigerator
- Adjustable spillproof glass shelves - Raised edges keep small spills from becoming big messes
- Upfront illuminated temperature controls - Easy-to-reach controls regulate interior temperatures
- Adjustable-humidity crisper drawers - Adjustable humidity controls keep fresh produce fresh
- Adjustable gallon door bins - Offers ideal space for storing gallon containers in the door
- Never Clean condenser - Sealed compartment keeps coils clean and simplifies maintenance
- Model GTS22KBPWW - White
- Model GTS22KBPBB - Black

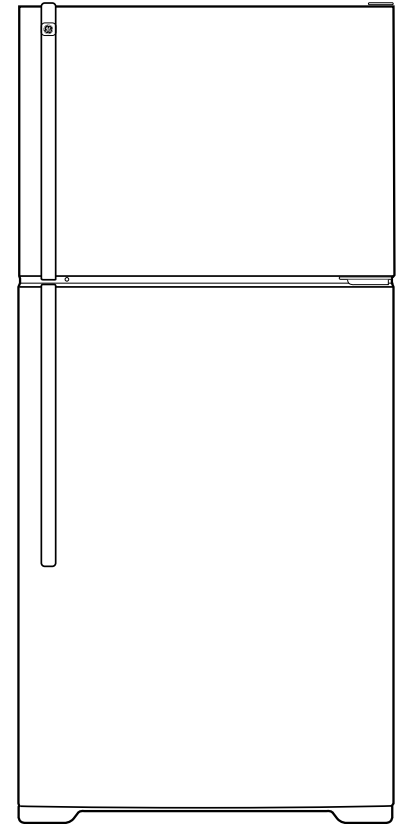

imagination at work

Specification Revised 4/13

310378