

# GTK181BX

## GE® 18.0 Cu. Ft. Stainless Top-Freezer Refrigerator

### Dimensions and Installation Information (in inches)

Overall Dimensions	Height to top of hinge (in.) <b>A</b>	66-5/8
	Height to top of case (in.) <b>B</b>	66-1/8*
	Case depth without door (in.) <b>C</b>	27-1/2
	Case depth less door handle (in.) <b>D</b>	30-1/4
	Case depth with door handle (in.) <b>E</b>	32-1/8
	Depth with fresh food door open 90° (in.) <b>F</b>	58-1/8
	Width (in.) <b>G</b>	29-1/2
	Width with door open 90° inc. door handle (in.) <b>H</b>	32
Air Clearances	Each side (in.)	1/8
	Top (in.)	1
	Back (in.)	1

\*Height to mid-freezer (in.): 53-15/16

Front View

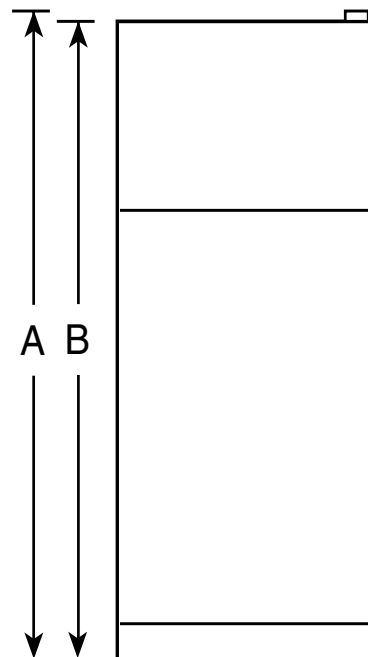

Top View

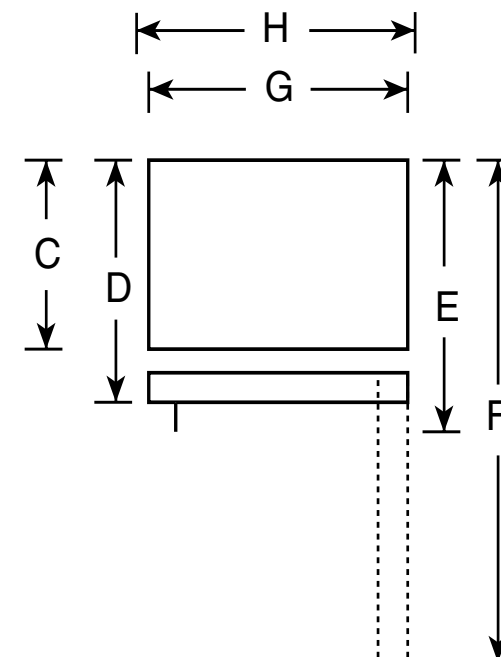

For answers to your Monogram®, GE Profile™ or GE® appliance questions, visit our website at [ge.com](http://ge.com) or call GE Answer Center® service, 800.626.2000.



Specification Created 8/08

310329

# GTK181BX

## GE® 18.0 Cu. Ft. Stainless Top-Freezer Refrigerator

### Features and Benefits

- CleanSteel™ Exterior - Offers a premium stainless look that resists fingerprints, smudges, and smears
- Adjustable Glass Shelves - Provides configuration options for ideal food storage
- Upfront Temperature Controls - Features easy-to-reach, easy-to-read temperature controls
- Vegetable/Fruit Crispers - For easy storage of your fruits and vegetables
- Gallon Door Storage - Makes room for gallon-size containers
- Snack Pan - Conveniently stores re-wrapped meats, cheeses and other snacks
- Freezer Step Shelf - Creates an extra space for stacking frozen foods and can be easily removed for tall items
- Model GTK181BXBS - CleanSteel™

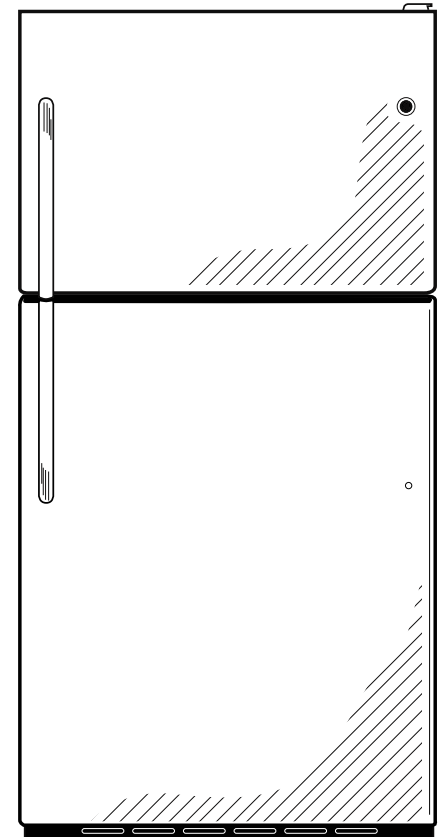

imagination at work

Specification Created 8/08

310329