

27" DOUBLE WALL OVENS

JJW2827W, JJW2727W, JJW2527W – 26¾" x 52¼" x 26¾"

PRODUCT DIMENSIONS

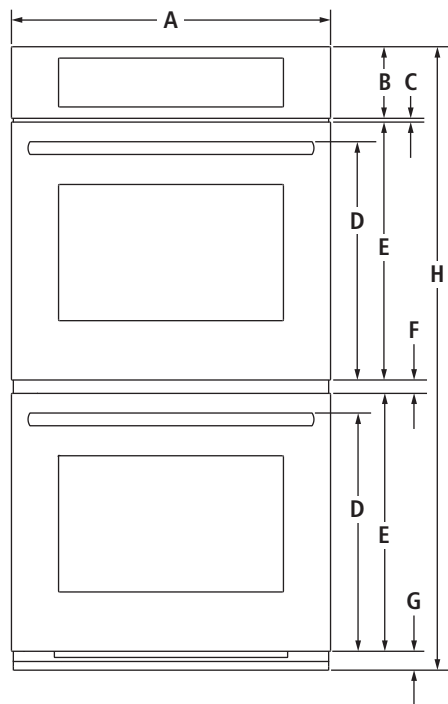

FRONT VIEW

MODEL #		JJW2827W JJW2727W JJW2527W	
		in	cm
A	Overall width Euro-Style Stainless	26¾	67.9
	Floating Glass	26⅝	67.6
B	Height of control panel	6	15.2
C	Space between control panel and door	⅜	0.9
D	Height to top of handle	20	50.7
E	Height of door	21⅝	54.9
F	Space between doors	1⅛	2.9
G	Height of trim	1½	4.0
H	Overall height	52¼	132.8
I	Width of recessed oven	25¼	64.1
J	Width of conduit channel	1⅝	4.1
K	Depth of recessed oven	23⅞	60.5
L	Depth with doors	24¾	62.8
M	Depth with handles	26¾	68.0
N	Depth with door fully open	45⅜	115.2

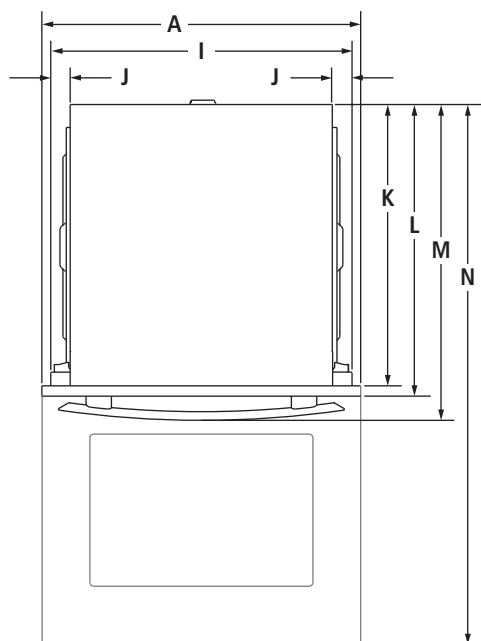

TOP VIEW

27" DOUBLE WALL OVENS

JJW2827W, JJW2727W, JJW2527W – 26³/₄" x 52¹/₄" x 26³/₄"

DIMENSIONS AS INSTALLED

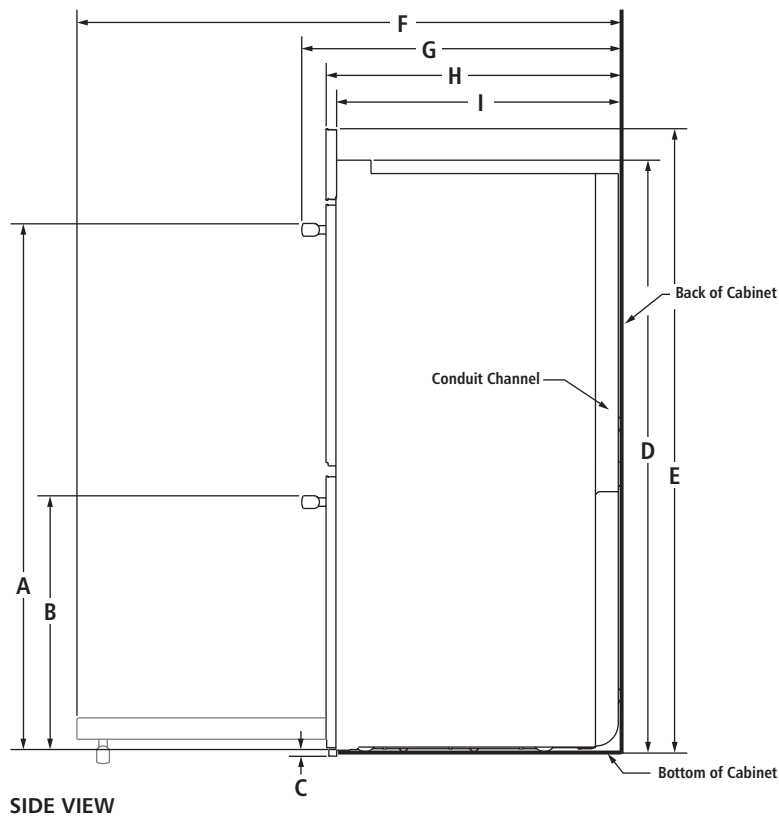

MODEL #		JJW2827W	
		JJW2727W	JJW2527W
		in	cm
A	Height to top of upper handle	44 ¹ / ₄	112.2
B	Height to top of lower handle	21 ³ / ₈	54.4
C	Height of trim extending below cutout	1/4	0.6
D	Height of recessed oven	49 ¹ / ₂	125.8
E	Height to top of control panel	52 ¹ / ₈	132.5
F	Depth with door fully open	45 ⁵ / ₈	115.2
G	Depth with handles	26 ³ / ₄	68.0
H	Depth with doors	24 ³ / ₄	62.8
I	Depth of recessed oven	23 ⁷ / ₈	60.5

27" DOUBLE WALL OVENS

JJW2827W, JJW2727W, JJW2527W – 26¾" x 52¼" x 26¾"

OPENING/CLEARANCE DIMENSIONS

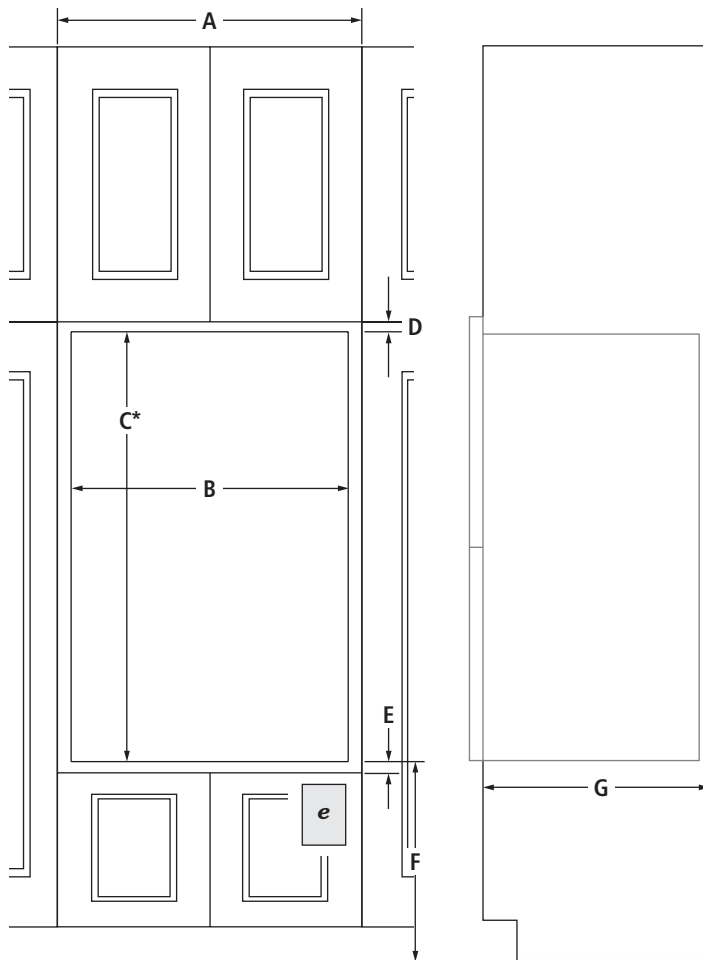

FRONT VIEW

SIDE VIEW

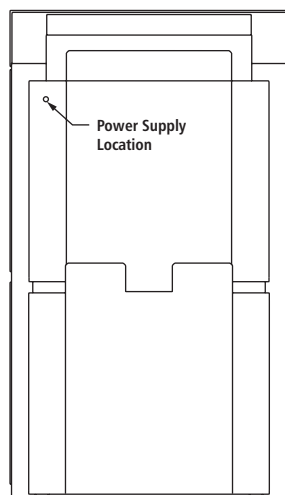

BACK VIEW

MODEL #

		JJW2827W JJW2727W JJW2527W	
		in	cm
A	Width of cabinet (min.)	27	68.6
B	Width of cutout	25½	64.8
C*	Height of cutout (recommended)	49¾	126.4
D	Top of cutout to bottom of upper cabinet door (min.)	2¾	7.0
E	Bottom of cutout to top of lower cabinet door (min.)	1½	3.8
F	Bottom of cutout to floor	4⅝- 14¾	11.7- 37.5
G	Depth of cutout (min.)	24	61.0
e	Recommended junction box location		

*Will fit cutout height from 49¾" (126.4 cm) to 51⅝" (131.9 cm).

ELECTRICAL REQUIREMENTS

240 volt, 40-amp fused, grounded circuit is required. A dedicated circuit is recommended.

The length of conduit provided is for serviceability. Do not cut the conduit. The junction box should be located 3" (7.6 cm) maximum below the support surface. Drill a 1¼" (3.4 cm) minimum diameter hole in the right rear corner of the support surface for access to the junction box.

If the junction box is on the rear wall behind the oven, it must be recessed and located in any corner of the cabinet.

27" DOUBLE WALL OVENS – FLUSH INSTALLATION

JJW2827W, JJW2727W, JJW2527W – 26¾" x 52¼" x 24¾" (depth without handles)

OPENING/CLEARANCE DIMENSIONS

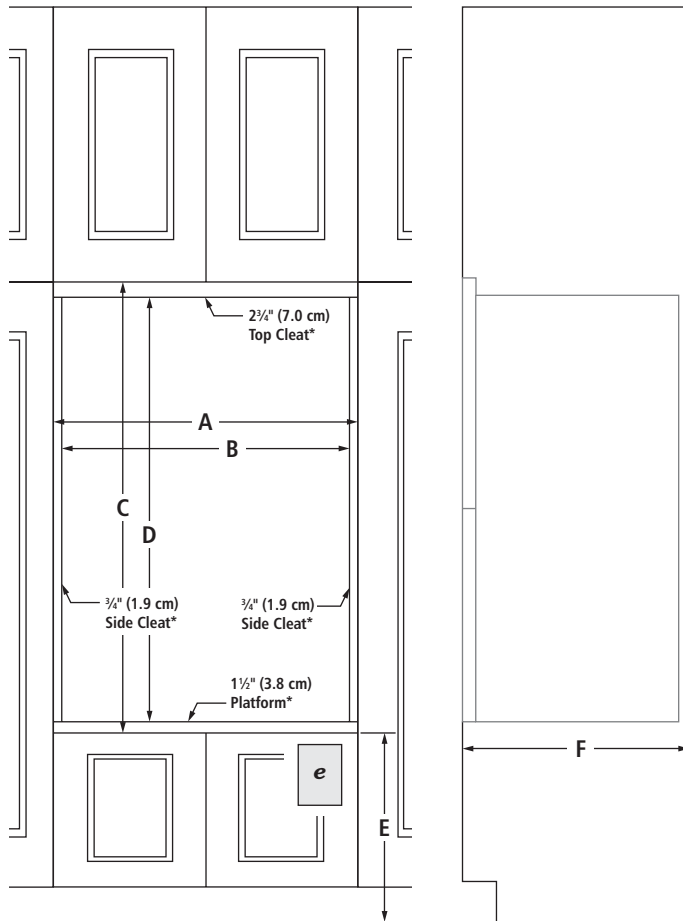

FRONT VIEW

SIDE VIEW

MODEL #		JJW2827W	
		in	cm
A	Width of flush inset cutout (min.)	27	68.6
B	Width of opening (min.)	25½	64.8
C	Height of flush inset cutout (min.)	54	137.2
D	Height of opening (min.)	49¾	126.4
E	Bottom of cutout to floor	4⅝- 14¾	11.7- 37.5
F	Depth of cutout (min.)	25	63.5
e	Recommended junction box location		

ELECTRICAL REQUIREMENTS

240 volt, 40-amp fused, grounded circuit is required. A dedicated circuit is recommended.

The length of conduit provided is for serviceability. Do not cut the conduit. The junction box should be located 3" (7.6 cm) maximum below the support surface. Drill a 1¼" (3.4 cm) minimum diameter hole in the right rear corner of the support surface for access to the junction box.

If the junction box is on the rear wall behind the oven, it must be recessed and located in any corner of the cabinet.

FLUSH INSTALLATION REQUIREMENTS

A 25" (63.5 cm) minimum cutout depth is required.

These dimensions will result in a ⅜" (1.0 cm) reveal on the top, a ⅛" (0.3 cm) reveal on the sides and a 1⅜" (3.5 cm) reveal on the bottom of the wall oven.

The front face of the cleats and platform will be visible and should be treated as a finished surface.

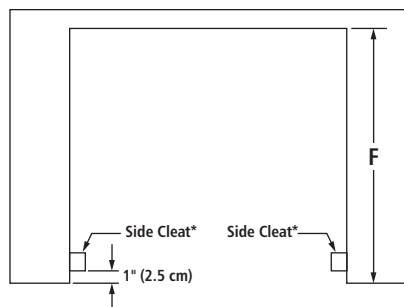

TOP VIEW

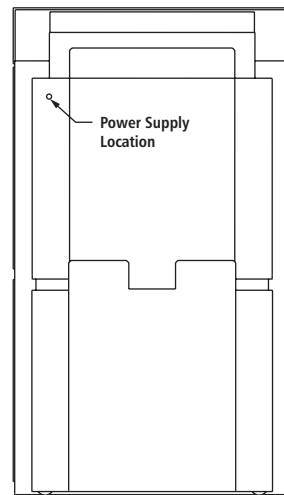

BACK VIEW

*Cleats and platform must be recessed 1" (2.5 cm) from the front of the cabinet.