

30" DOUBLE WALL OVENS

JJW3830W, JJW2830W, JJW2730W, JJW2530W – 29¾" x 52¼" x 26¾"

PRODUCT DIMENSIONS

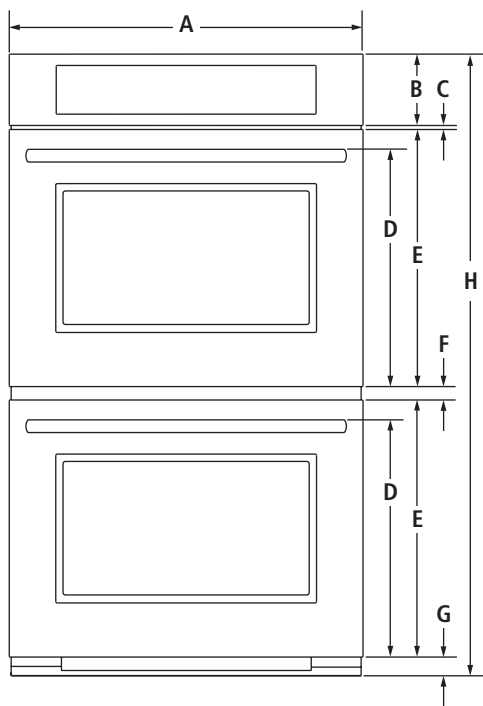

FRONT VIEW

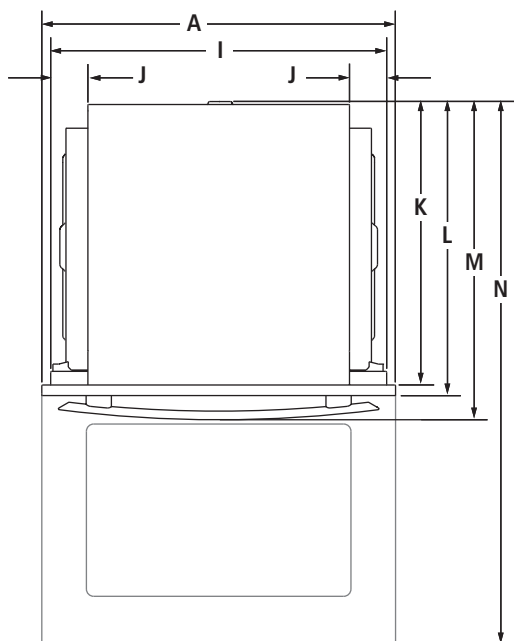

TOP VIEW

MODEL #	JJW3830W JJW2830W JJW2730W JJW2530W	
	in	cm
A	Overall width Pro-Style® Stainless, Euro-Style Stainless or Oiled Bronze	29¾ 75.6
	Floating Glass	29⅝ 75.3
B	Height of control panel	6 15.2
C	Space between control panel and door	⅜ 0.9
D	Height to top of handle Pro-Style® Stainless	20¼ 51.4
	Euro-Style (color-coordinating)	20 50.7
E	Height of door	21⅝ 54.9
F	Space between doors	1⅛ 2.9
G	Height of trim	1½ 4.0
H	Overall height	52¼ 132.8
I	Width of recessed oven	28¼ 71.8
J	Width of conduit channel	3⅛ 7.9
K	Depth of recessed oven	23⅞ 60.5
L	Depth with doors	24¾ 62.8
M	Depth with handles Pro-Style® Stainless	27¼ 69.2
	Euro-Style (color-coordinating)	26¾ 68.0
N	Depth with door fully open	45⅝ 115.2

30" DOUBLE WALL OVENS

JJW3830W, JJW2830W, JJW2730W, JJW2530W – 29³/₄" x 52¹/₄" x 26³/₄"

DIMENSIONS AS INSTALLED

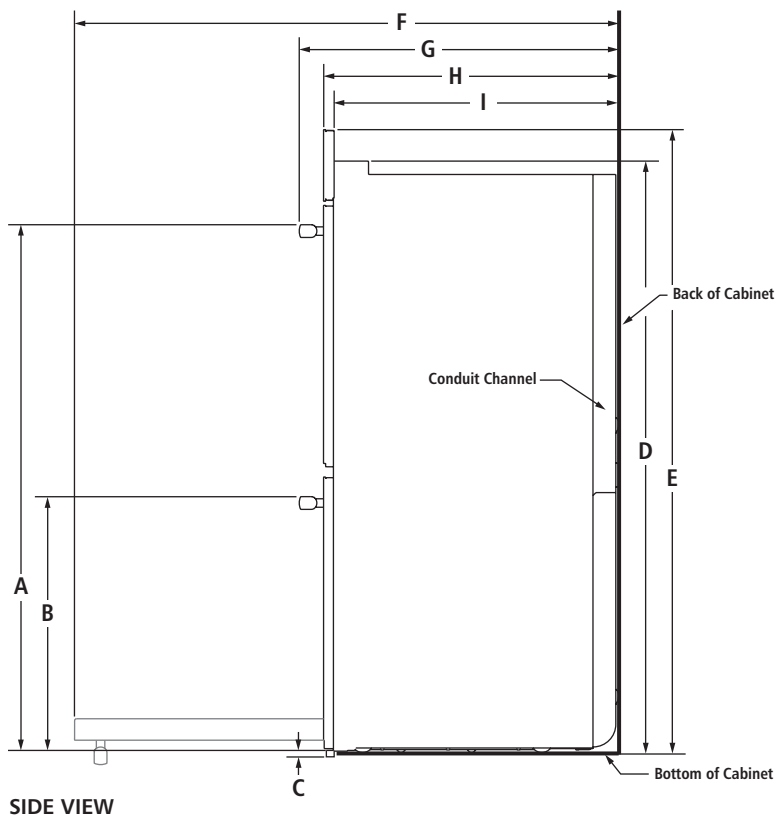

SIDE VIEW

MODEL #		JJW3830W JJW2830W JJW2730W JJW2530W	
		in	cm
A	Height to top of upper handle Pro-Style® Stainless	44½	112.9
	Euro-Style (color-coordinating)	44¼	112.2
B	Height to top of lower handle Pro-Style® Stainless	21½	55.1
	Euro-Style (color-coordinating)	21¾	54.4
C	Height of trim extending below cutout	¼	0.6
D	Height of recessed oven	49½	125.8
E	Height to top of control panel	52⅞	132.5
F	Depth with door fully open	45¾	115.2
G	Depth with handles Pro-Style® Stainless	27¼	69.2
	Euro-Style (color-coordinating)	26¾	68.0
H	Depth with doors	24¾	62.8
I	Depth of recessed oven	23¾	60.5

30" DOUBLE WALL OVENS

JJW3830W, JJW2830W, JJW2730W, JJW2530W – 29¾" x 52¼" x 26¾"

OPENING/CLEARANCE DIMENSIONS

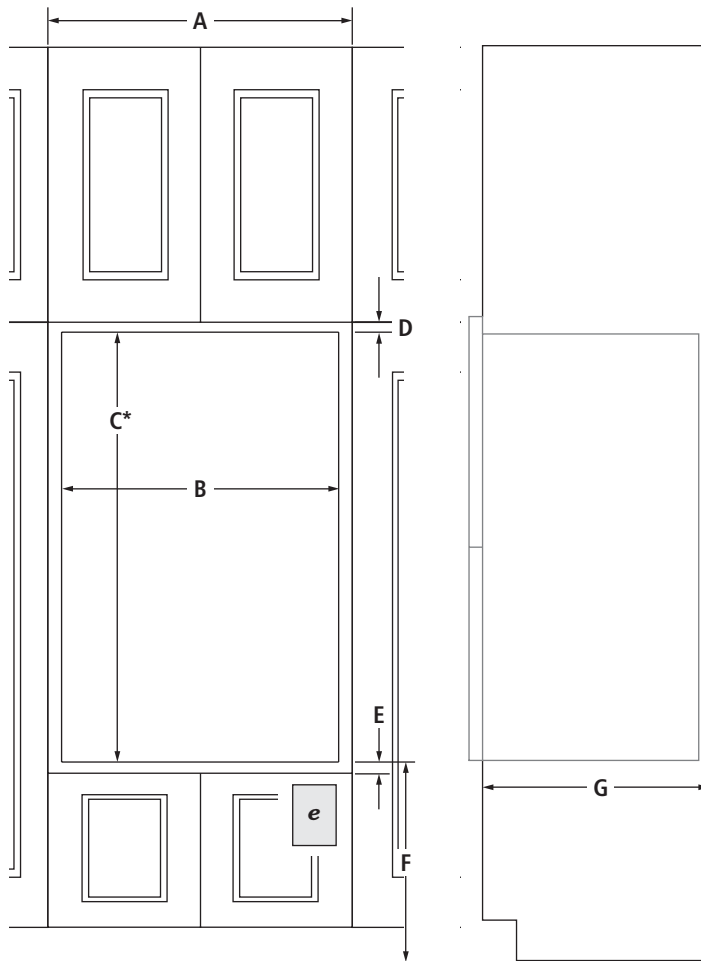

FRONT VIEW

SIDE VIEW

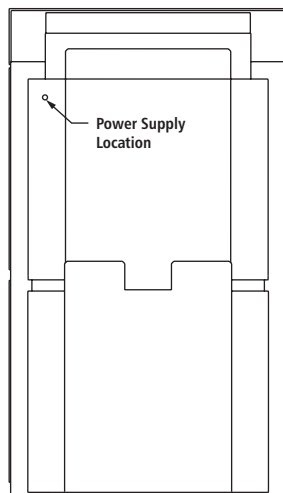

BACK VIEW

MODEL #

		JJW3830W JJW2830W JJW2730W JJW2530W	
		in	cm
A	Width of cabinet (min.)	30	76.2
B	Width of cutout	28½	72.4
C*	Height of cutout (recommended)	49¾	126.4
D	Top of cutout to bottom of upper cabinet door (min.)	2¾	7.0
E	Bottom of cutout to top of lower cabinet door (min.)	1½	3.8
F	Bottom of cutout to floor	4⅝- 14¾	11.7- 37.5
G	Depth of cutout (min.)	24	61.0
e	Recommended junction box location		

*Will fit cutout height from 49¾" (126.4 cm) to 51⅝" (131.9 cm).

ELECTRICAL REQUIREMENTS

240 volt, 40-amp fused, grounded circuit is required. A dedicated circuit is recommended.

The length of conduit provided is for serviceability. Do not cut the conduit. The junction box should be located 3" (7.6 cm) maximum below the support surface. Drill a 1¼" (3.4 cm) minimum diameter hole in the right rear corner of the support surface for access to the junction box.

If the junction box is on the rear wall behind the oven, it must be recessed and located in any corner of the cabinet.

30" DOUBLE WALL OVENS – FLUSH INSTALLATION

JJW3830W, JJW2830W, JJW2730W, JJW2530W – 29¾" x 52¼" x 24¾" (depth without handles)

OPENING/CLEARANCE DIMENSIONS

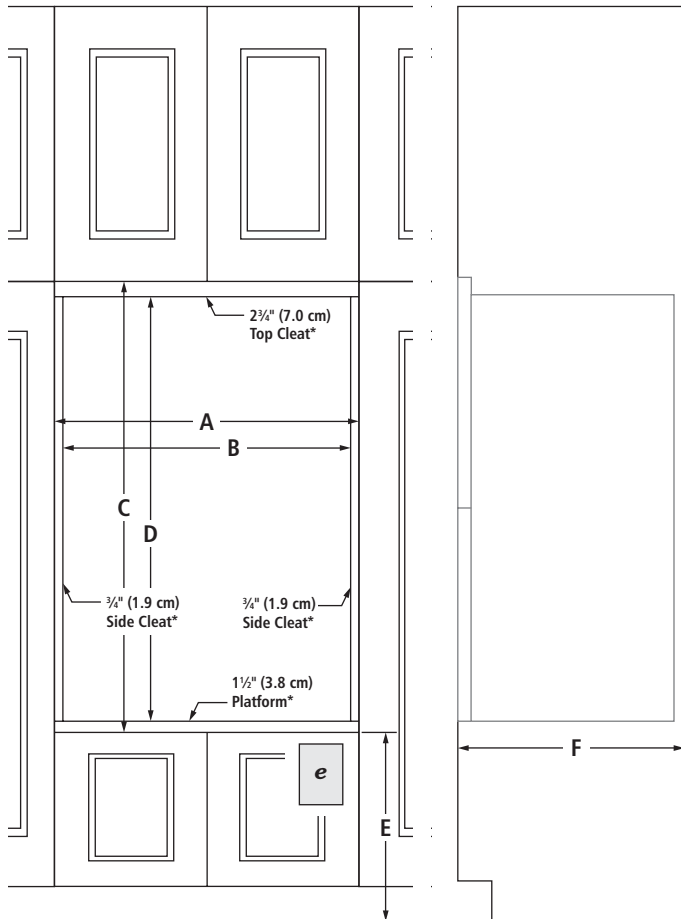

FRONT VIEW

SIDE VIEW

MODEL #		JJW3830W JJW2830W JJW2730W JJW2530W	
		in	cm
A	Width of flush inset cutout (min.)	30	76.2
B	Width of opening (min.)	28½	72.4
C	Height of flush inset cutout (min.)	54	137.2
D	Height of opening (min.)	49¾	126.4
E	Bottom of cutout to floor	4⅝- 14¾	11.7- 37.5
F	Depth of cutout (min.)	25	63.5
e	Recommended junction box location		

ELECTRICAL REQUIREMENTS

240 volt, 40-amp fused, grounded circuit is required. A dedicated circuit is recommended.

The length of conduit provided is for serviceability. Do not cut the conduit. The junction box should be located 3" (7.6 cm) maximum below the support surface. Drill a 1¼" (3.4 cm) minimum diameter hole in the right rear corner of the support surface for access to the junction box.

If the junction box is on the rear wall behind the oven, it must be recessed and located in any corner of the cabinet.

FLUSH INSTALLATION REQUIREMENTS

A 25" (63.5 cm) minimum cutout depth is required.

These dimensions will result in a ⅜" (1.0 cm) reveal on the top, a ⅛" (0.3 cm) reveal on the sides and a 1⅜" (3.5 cm) reveal on the bottom of the wall oven.

The front face of the cleats and platform will be visible and should be treated as a finished surface.

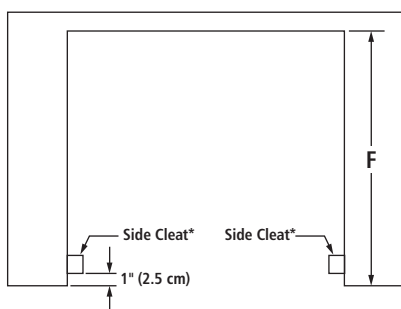

TOP VIEW

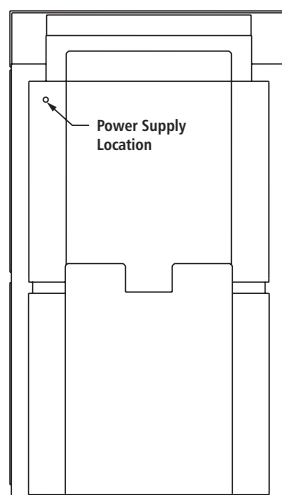

BACK VIEW

*Cleats and platform must be recessed 1" (2.5 cm) from the front of the cabinet.