

42" FULLY INTEGRATED SIDE-BY-SIDE REFRIGERATOR

(BASE UNIT REQUIRES SUITE-COORDINATING PANEL KIT OR CUSTOM PANELS AND HANDLES)

JS42NXFXDE – 41¾" x 83⅞" x 24" (without door/handles)

PRODUCT DIMENSIONS (including stainless steel door panel kit dimensions)

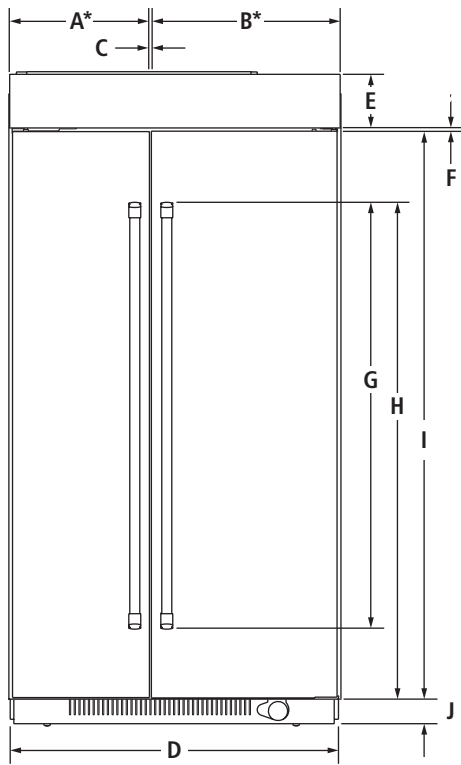

FRONT VIEW

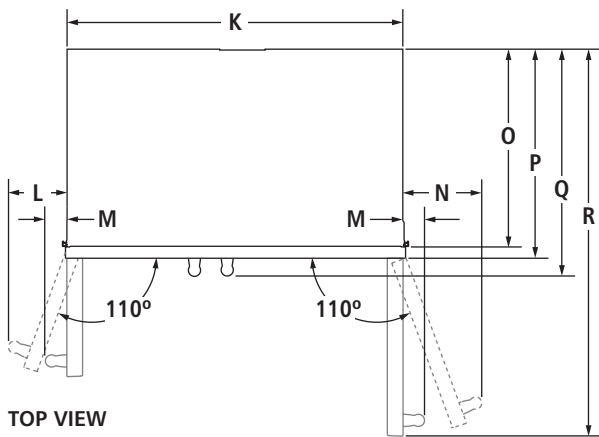

TOP VIEW

MODEL #		JS42NXFXDE	
		in	cm
A*	Width of freezer door	17⅞	44.8
B*	Width of refrigerator door	23⅝	60.0
C	Space between doors	⅛	0.3
D	Overall width (including vinyl side trim)	41¾	106.0
E	Height of top grille (including top grille filler)	6½	16.5
F	Space between doors and top grille	⅛	0.3
G	Height of door handles Pro-Style® Stainless	63	160.0
		50	127.1
H	Height to top of door handles Pro-Style® Stainless	67	170.3
		66⅝	169.1
I	Height of doors	74¼	188.6
J	Height of bottom grille	3	7.6
K	Width of recessed refrigerator	41	104.1
L	Width from side of refrigerator to freezer door handle – door fully open 110° Pro-Style® Stainless	7⅞	18.1
		6¾	17.1
M	Width from side of refrigerator to handle – doors open 90° Pro-Style® Stainless	2	5.1
		1½	3.9
N	Width from side of refrigerator to refrigerator door handle – door fully open 110° Pro-Style® Stainless	9⅝	24.4
		9⅞	23.1
O	Depth without door panel kit	24	61.0
P	Depth with doors Pro-Style® Stainless panel kit	24¾	62.9
		24¾	62.9
		24¾	62.9
Q	Depth with handles Pro-Style® Stainless	27⅝	69.5
		26⅞	68.3
R	Depth with refrigerator door open 90°	46¾	118.7

* Door width dimensions are for stainless steel panel kit only.

IMPORTANT: Dimensional specifications are provided for planning purposes only.

Do not make any cutouts based on this information. Refer to the Installation or Use & Care Guide before selecting cabinetry, verifying electrical/gas connections, making cutouts or beginning installation.

All Jenn-Air® appliances are appropriately UL, CUL or CSA approved.



42" FULLY INTEGRATED SIDE-BY-SIDE REFRIGERATOR

(BASE UNIT REQUIRES SUITE-COORDINATING PANEL KIT OR CUSTOM PANELS AND HANDLES)

JS42NXFXDE – 41¾" x 83⅞" x 24" (without door/handles)

DIMENSIONS AS INSTALLED

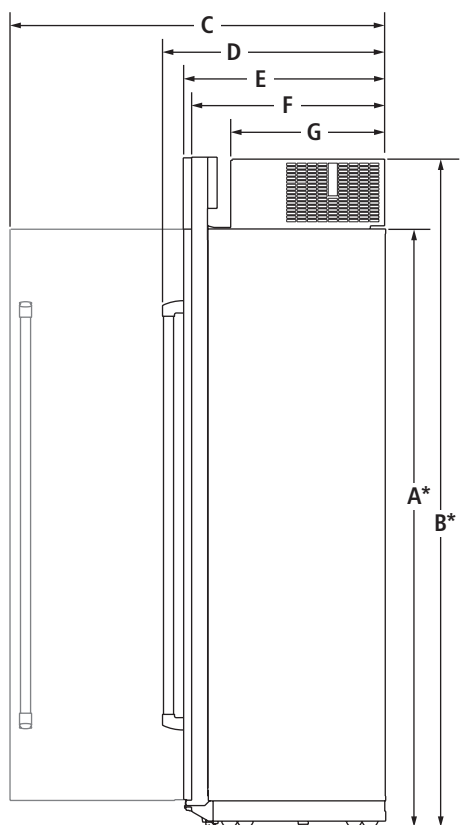

SIDE VIEW

MODEL #		JS42NXFXDE	
		in	cm
A*	Height without compressor (min.)	74¾	188.9
B*	Height of recessed refrigerator (min.)	83⅞	211.1
C	Depth with refrigerator door open 90° (min.)	47¼	120.0
D	Depth with handles (min.)		
	Pro-Style® Stainless	27¾	69.5
	Euro-Style Stainless	26¾	68.3
E	Depth with doors (min.)		
	Pro-Style® Stainless panel kit	24¾	62.9
	Euro-Style Stainless panel kit	24¾	62.9
	Custom panel (¾"/1.9 cm)	24¾	62.9
F	Depth without door panel kit (min.)	24	61.0
G	Depth of compressor (min.)	19⅞	50.5

*Add 1¼" (3.2 cm) to the height dimension when leveling legs are fully extended

IMPORTANT: Dimensional specifications are provided for planning purposes only. Do not make any cutouts based on this information. Refer to the Installation or Use & Care Guide before selecting cabinetry, verifying electrical/gas connections, making cutouts or beginning installation. All Jenn-Air® appliances are appropriately UL, CUL or CSA approved.

42" FULLY INTEGRATED SIDE-BY-SIDE REFRIGERATOR

(BASE UNIT REQUIRES SUITE-COORDINATING PANEL KIT OR CUSTOM PANELS AND HANDLES)

JS42NXFXDE – 41¾" x 83⅞" x 24" (without door/handles)

3 STYLES FOR DOOR PANEL INSTALLATION

STANDARD INTEGRATED GRILLE INSTALLATION

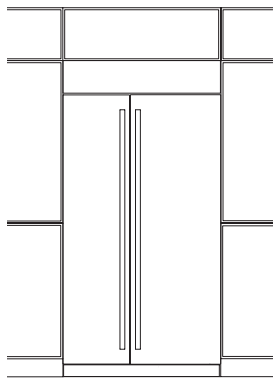

FRONT VIEW

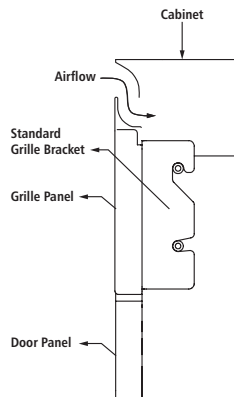

SIDE VIEW – STAINLESS STEEL PANEL KIT

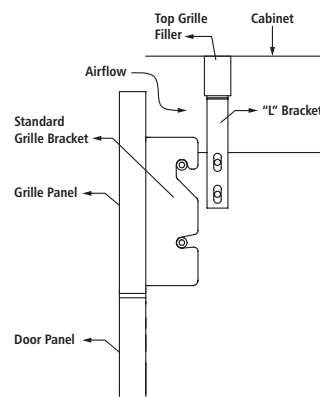

SIDE VIEW – CUSTOM PANEL

- Attach the standard custom grille with the standard grille bracket provided with the refrigerator.
- The standard grille panel height allows for an air gap critical to refrigerator performance.

FULLY INTEGRATED GRILLE INSTALLATION

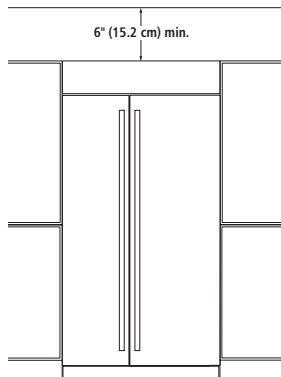

FRONT VIEW – OPEN TO CEILING (OPTION 1)

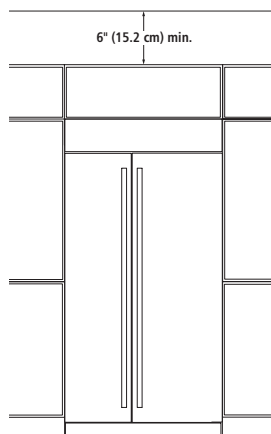

FRONT VIEW – FALSE FRONT (OPTION 2)

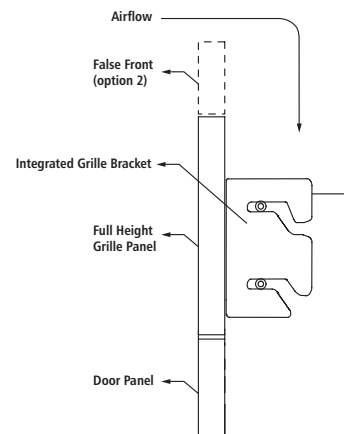

SIDE VIEW – CUSTOM PANEL

- Attach the full-height grille with the integrated grille bracket provided with the refrigerator.
- Requires a minimum of 6" (15.2 cm) of open space above the refrigerator, which must not be blocked in any way, including soffits.

ARMOIRE-STYLE INSTALLATION*

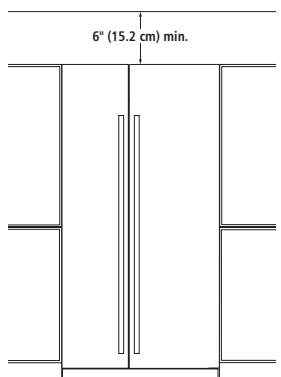

FRONT VIEW – OPEN TO CEILING (OPTION 1)

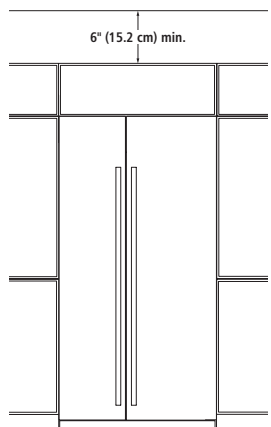

FRONT VIEW – FALSE FRONT (OPTION 2)

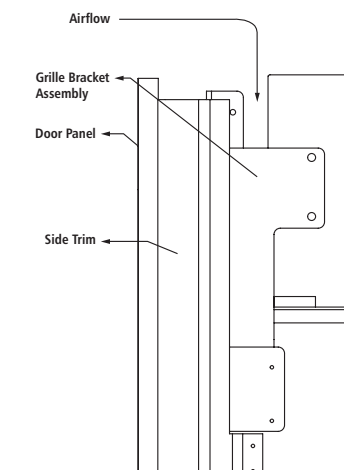

SIDE VIEW – CUSTOM PANEL

- Attach the grille bracket assembly and grille panel provided in the armoire-style panel kit.
- Requires a minimum of 6" (15.2 cm) of open space above the refrigerator, which must not be blocked in any way, including soffits.

* Refer to the Armoire Kit installation instructions for additional dimensions and installation details.

IMPORTANT: Dimensional specifications are provided for planning purposes only. Do not make any cutouts based on this information. Refer to the Installation or Use & Care Guide before selecting cabinetry, verifying electrical/gas connections, making cutouts or beginning installation. All Jenn-Air® appliances are appropriately UL, CUL or CSA approved.

42" FULLY INTEGRATED SIDE-BY-SIDE REFRIGERATOR

(BASE UNIT REQUIRES SUITE-COORDINATING PANEL KIT OR CUSTOM PANELS AND HANDLES)

JS42NXFXDE – 41¾" x 83⅝" x 24" (without door/handles)

OPENING/CLEARANCE DIMENSIONS

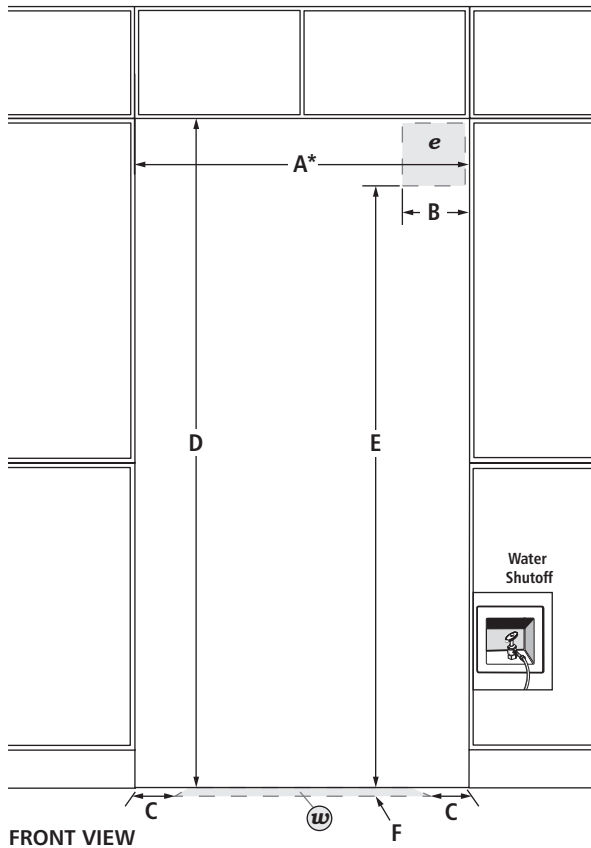

FRONT VIEW

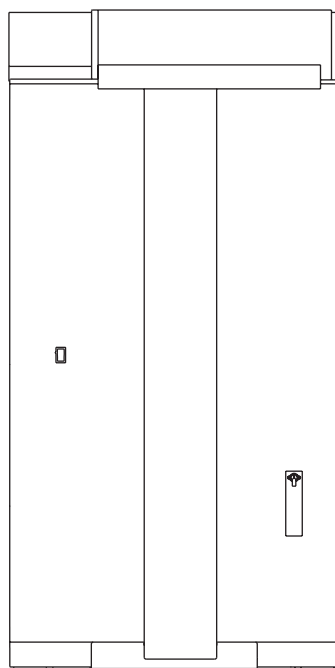

BACK VIEW

MODEL #		JS42NXFXDE	
		in	cm
A*	Width (min.)	42	106.7
B	Width of recommended electrical location	7½	19.1
C	Distance from side of cabinet to recommended water connection location	6	15.2
D	Height (min.)	84	213.4
E	Height to recommended electrical location	77	195.6
F	Depth of recommended water connection location (max.)	1	2.5
e	Recommended electrical connection location		
w	Recommended water connection location		

*Minimum width must extend behind the face of the cabinet for at least 2" (5.1 cm).

ELECTRICAL REQUIREMENTS

115 volt, 60 Hz, AC only, 15- or 20-amp fused, grounded circuit is required. A dedicated circuit is recommended. Use an outlet that cannot be turned off by a switch. Do not use an extension cord.

WATER PRESSURE REQUIREMENTS

A cold water supply with water pressure between 30 and 120 psi (207 and 827 kPa) is required to operate the ice maker. Call a licensed, qualified plumber with any questions about the water pressure.

Reverse Osmosis Water Supply

IMPORTANT: The pressure of the water coming out of a reverse osmosis system going to the water inlet valve of the refrigerator needs to be between 30 and 120 psi (207 and 827 kPa).

If a reverse osmosis water filtration system is connected to the cold water supply, the water pressure to the reverse osmosis system needs to be a minimum of 40 to 60 psi (276 to 414 kPa).

LOCATION REQUIREMENTS

Floor must be able to support refrigerator (more than 600 lb [272 kg]), door panels and contents of the refrigerator and must be at the same level as flooring in the room.

IMPORTANT: Dimensional specifications are provided for planning purposes only.

Do not make any cutouts based on this information. Refer to the Installation or Use & Care Guide before selecting cabinetry, verifying electrical/gas connections, making cutouts or beginning installation. All Jenn-Air® appliances are appropriately UL, CUL or CSA approved.

