

## Additional Information

### Specification

Power requirements	Refer to the main label.
Power consumption	Refer to the main label.
Dimensions (W x H x D)	Approx. 880 mm x 62 mm x 90 mm (34.6 inches x 2.4 inches x 3.5 inches)
Net Weight	Approx. 1.8 kg (3.9 lb)
Amplifier (Total RMS Output power)	100 W

Design and specifications are subject to change without notice.

### Remote control

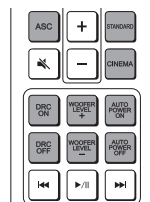

ASC/STANDARD/CINEMA : Selects sound effect.

\*ASC : Adaptive Sound Control

DRC ON/OFF : Makes comfortable sound at Dolby Digital.

WOOFER LEVEL+/- : Adjusts the volume level of subwoofer.

AUTO POWER ON/OFF : Automatically turns on by an input

source : Optical, **Bluetooth**, LG TV

### Replacement of battery

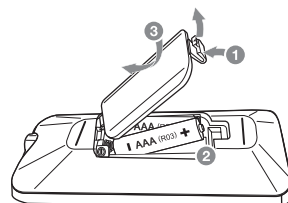

# SIMPLE MANUAL Sound Bar

Please read this manual carefully before operating your set and retain it for future reference. To view the instructions of advanced features, visit <http://www.lg.com> and then download Owner's Manual. Some of the content in this manual may differ from your unit.

MODEL  
SH2



Printed in China

[www.lg.com](http://www.lg.com)  
Copyright © 2017 LG Electronics. All Rights Reserved

**WARNING:** This product contains chemicals known to the State of California to cause cancer and birth defects or other reproductive harm. **Wash hands after handling.**

**FCC Compliance Statement**

This equipment has been tested and found to comply with the limits for a Class B digital device, pursuant to Part 15 of the FCC Rules. These limits are designed to provide reasonable protection against harmful interference in a residential installation. This equipment generates, uses, and can radiate radio frequency energy and, if not installed and used in accordance with the instructions, may cause harmful interference to radio communications. However, there is no guarantee that interference will not occur in a particular installation. If this equipment does cause harmful interference to radio or television reception, which can be determined by turning the equipment off and on, the user is encouraged to try to correct the interference by one or more of the following measures:

- Reorient or relocate the receiving antenna.
- Increase the separation between the equipment and the receiver.
- Connect the equipment to an outlet on a circuit different from that to which the receiver is connected.
- Consult the dealer or an experienced radio/TV technician for help.

This device complies with part 15 of the FCC Rules. Operation is subject to the following two conditions:  
 (1) this device may not cause harmful interference and  
 (2) this device must accept any interference received, including interference that may cause undesired operation of the device. Any changes or modifications in construction of this device which are not expressly approved by the party responsible for compliance could void the user's authority to operate the equipment.

**FCC RF Radiation Exposure Statement :** This equipment complies with FCC radiation exposure limits set forth for an uncontrolled environment. This transmitter must not be co-located or operating in conjunction with any other antenna or transmitter.

This equipment should be installed and operated with minimum distance 20 cm (7.8 inches) between the antenna and your body. Users must follow the specific operating instructions for satisfying RF exposure compliance.

**Responsible Party :**

LG Electronics USA, Inc.  
 1000 Sylvan Ave  
 Englewood Cliffs, NJ 07632  
 Tel: 1-800-243-0000



**Front Panel**

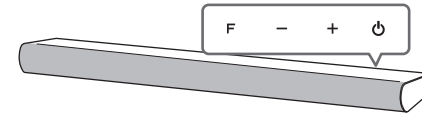

- F** ..... Selects Function
- +** ..... Adjusts Volume
- ⏻** ..... Power On/Off

**1 Subwoofer Connection**

Place the subwoofer near the sound bar and follow steps below.

- 1 Press each plastic finger pad to open subwoofer terminals on the unit.
- 2 Connect the black stripe wire to the terminal marked - (minus) and the other end to the terminal (red tube) marked + (plus).

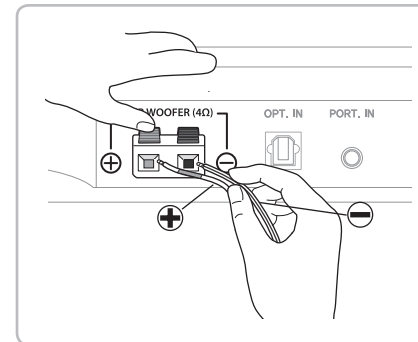

**Controller App**



Download the **Music Flow Bluetooth** App to your device.

**Rear Panel**

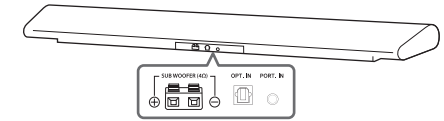

- SUB WOOFER (4Ω)** ..... Connect to a Subwoofer
- OPT. IN** ..... Connect to an Optical device
- PORT. IN** ..... Connect to a Portable device

**2 TV Connection**

- 1 Connect the sound bar to the TV using Optical cable.
- 2 Set up [External Speaker (Optical)] on your TV setting menu.

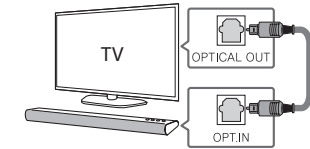

**LG Sound Sync (Wireless)**



For more information, download the online owner's manual. <http://www.lg.com>