

HELP! THE ONLY REASON I HAVE A KITCHEN IS THAT IT CAME WITH THE HOUSE.

THE INTELLIGENT HAVE PLANS BUT THE WISE HAVE DESIGN PRINCIPLES.

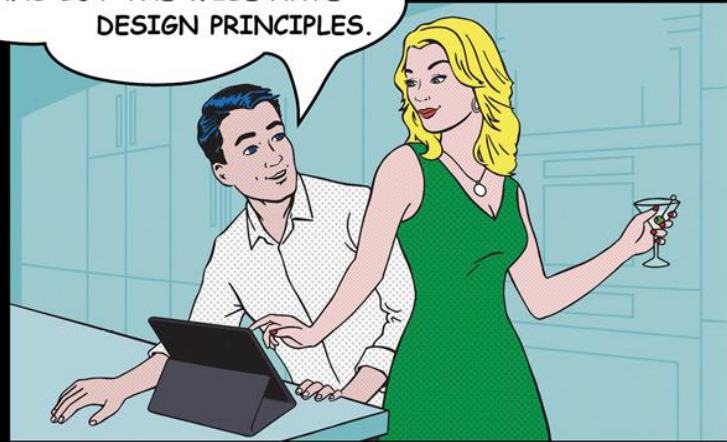

SOPS60TC
24" Built-In Stainless Steel Oven

Porter & Charles
2016 SPECIFICATION SHEET

SOPS60TC

24" Built-In Stainless Steel Oven

Let your kitchen be your showpiece! Designed to blend perfectly with all other appliances to enhance the appearance of any kitchen. A function to suit any cooking need thoughtfully designed to make cooking more enjoyable and efficient, and provide delectable results meal after meal.



OVEN ACCESSORIES

- Grill/roasting pan
- Baking sheet
- 2 chrome oven racks
- Telescopic rails
- Optional : LIE-7427640 - Silver cabinet base air ventilation grill

ELECTRICAL REQUIREMENTS

- 208/240 Volt, 60Hz, 20 amp, 3220W
- Supplied with a 5ft long electrical cable and must be hard wired

OVEN FEATURES

- 65 litre (2.29 cu. ft.) interior capacity
- 10 cooking functions including True Fan convection
- Retractable control knobs with touch control panel
- Double glazed down fold removable door with removable glass pane
- Fully automatic digital clock and timer
- Digital display with easy to use retractable control knobs
- Cooking Duration Feature and End Time cooking control
- Black enamel interior for easy cleaning
- 5 rack positions
- Child safety lock
- Bright interior light

OVEN DIMENSIONS

D: 22^{3/8}" • W: 23^{7/16}" • H: 23^{1/4}"

D: 569 mm • W: 595 mm • H: 591 mm

CUT-OUT DIMENSIONS

D: min. 22^{1/4}" x W: min. 22^{1/16}" x H: 23"

D: min 565mm x W: min.560mm x H: 585mm

SPECIFICATIONS

SOPS60TC

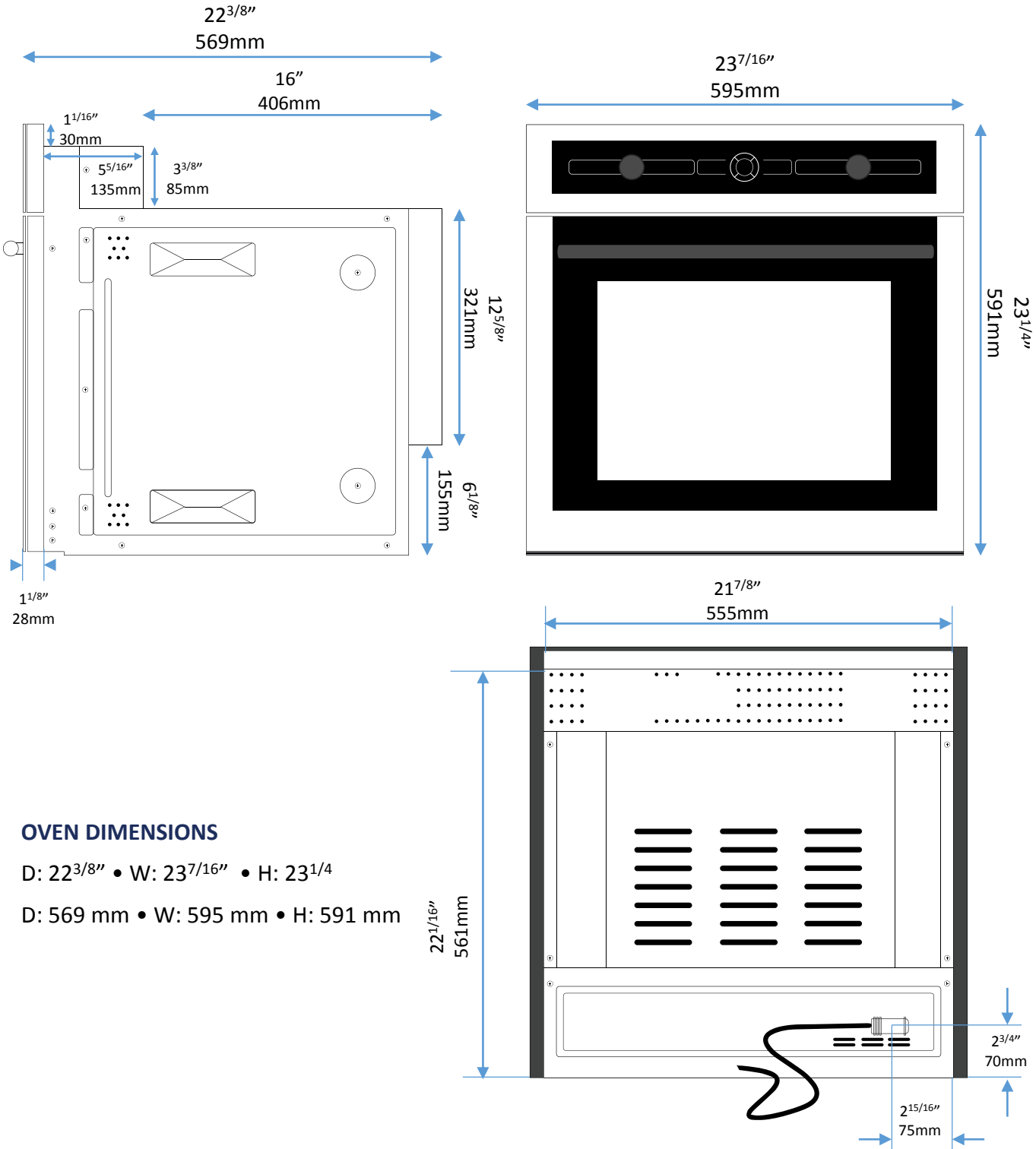

OVEN DIMENSIONS

D: $22\frac{3}{8}"$ • W: $23\frac{7}{16}"$ • H: $23\frac{1}{4}"$

D: 569 mm • W: 595 mm • H: 591 mm

SPECIFICATIONS

SOPS60TC

OVEN DIMENSIONS

- D: 22^{3/8"} x W: 23^{7/16"} x H: 23^{1/4"}
- D: 569 mm x W: 595 mm x H: 591 mm

CUT-OUT DIMENSIONS

- D: min. 22^{1/4"} x W: min. 22^{1/16"} x H: 23"
- D: min 565mm x W: min. 560mm x H: 585mm

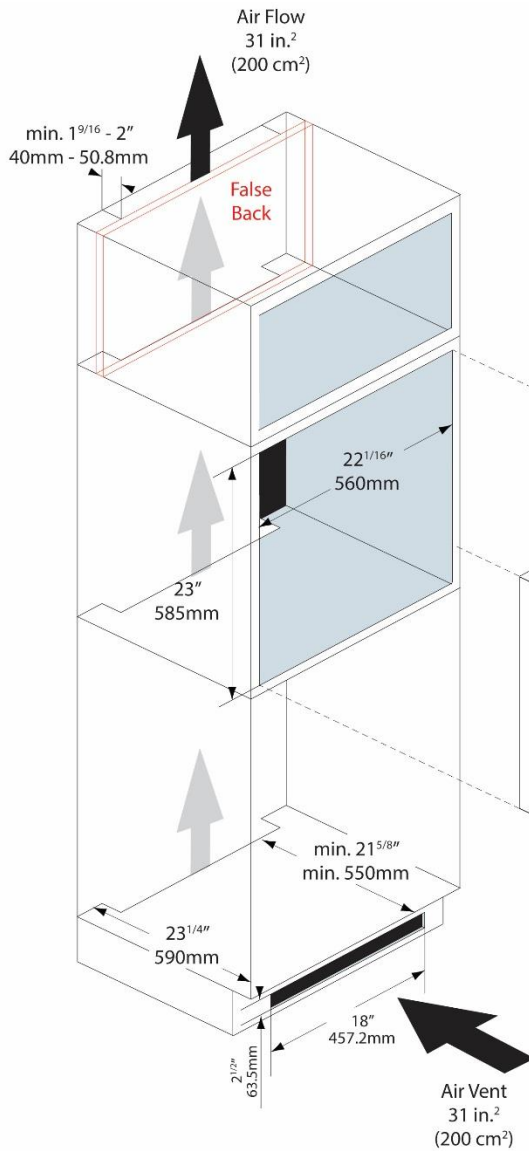

ELECTRICAL REQUIREMENTS

- 220 / 240 Volt, 60Hz, 20 AMP, 3220W

IMPORTANT

- PORTER&CHARLES ovens are supplied with a 5' long electrical cable and must be hard wired to the electrical supply
- PORTER&CHARLES ovens uses the following wires:
RED & BLACK: Live Wires
GREEN: Ground
The Neutral (White) wire is not required for the electrical installation.

FALSE BACKS

- Install false backs for storage spaces. This will prevent contents from falling through the vent space. In addition, warm air will not interfere with your stored contents

SPECIFICATIONS

SOPS60TC

AIR FLOW REQUIREMENTS

- If the oven is being placed under the counter, there must be a minimum gap of $1^{9/16}$ " (4cm) cut out of the shelf behind the oven to allow air to flow freely.
- If sufficient air flow is not provided, the life of the appliance will be shortened.
- Cut-out in the toe kick is recommended.
- Bottom vent grill (7427640) available.

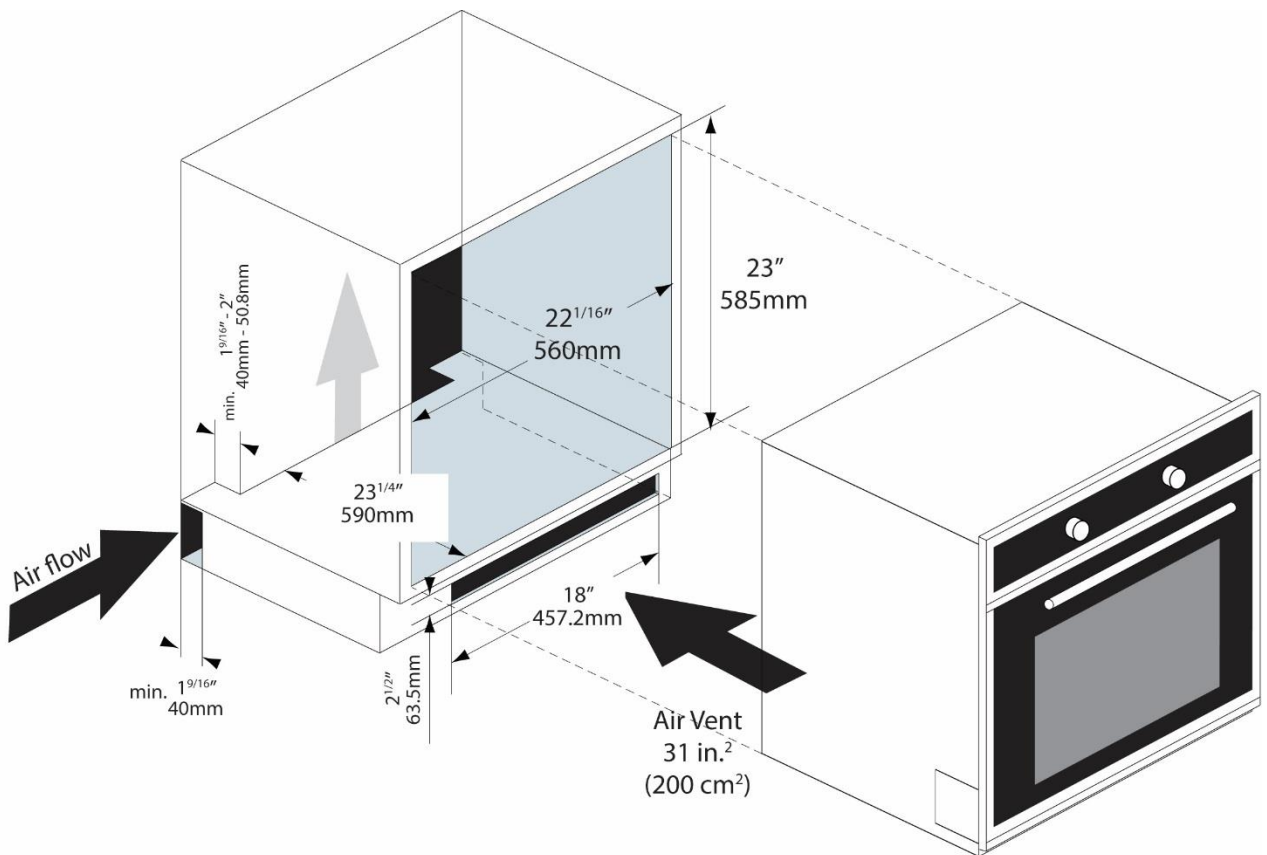

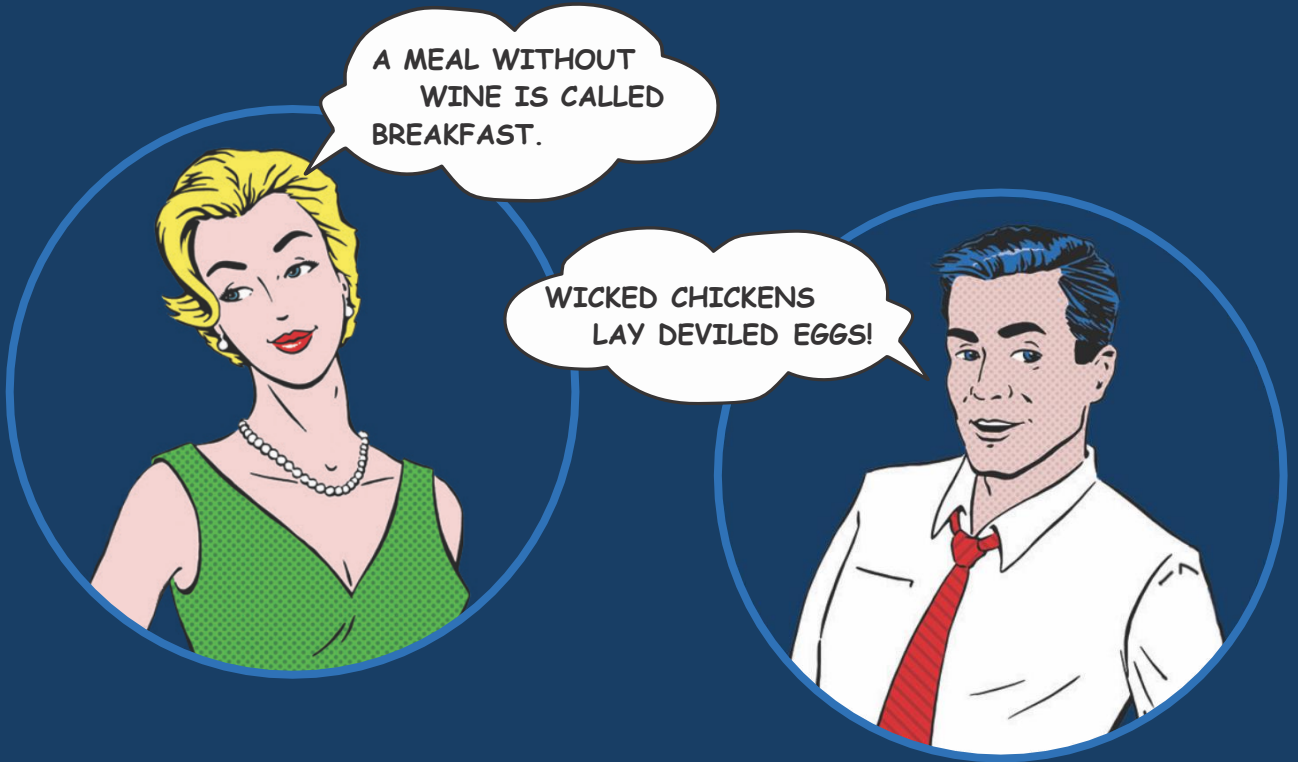

Porter & Charles Appliances are designed and manufactured to the highest standards. Each appliance is covered by a comprehensive 2-year parts and labour warranty.

Refer to product warranty policy for complete terms and conditions.

FOR PARTS AND SERVICE

Euro-Parts & Service

39822 Belgrave Road, Belgrave, ON. N0G 1E0
1 800 678 8352 (Canada) • 1 800 561 4614 (U.S.)

www.euro-parts.ca • parts@euro-parts.ca • service@euro-parts.ca

Porter & Charles appliances are imported and distributed in North America by Euro-Line Appliances Inc. For more information, please visit one of our showrooms or

www.euro-line-appliances.com / www.elawest.com

EURO-LINE APPLIANCES INC.

871 Cranberry Court
Oakville, ON L6L 6J7 Canada
905 829 3980
1 800 421 6332

marketing@euro-line-appliances.com

EURO-LINE APPLIANCES WEST INC.

2912 West 4th Avenue
Vancouver, BC V6K 1R2 Canada
604 235 3980
1 855 ELA WEST (352.9378)

info@elawest.com

