

quick guide

Call 1-800-726-7864

troubleshooting

Water usage

- The half of laundry (8 lbs) water usage is about 18 liter.
- The water usage is about 50 liter until from washing to 2 rinsing.
- According laundry type, It is different the water usage.

 Avoid using too much detergent in your washer as it can lead to over sudsing and detergent residue being left on the clothes.

When door locked or will not open.

- The door will not open when the water temperature is over 131 °F.
The door will not open when the internal water sensor detects the water level is too high. When the water level is too high. Press the **Spin** button.

 Do not try to force the door open when locked.
This could result in physical injury and, damage to the washer.







Vibration or noise.

- When washing big bulky items that occur noise/vibration or damaged laundry.
- Load is too small. Very small loads (one or two items) may become unbalanced and not spin out completely.
- Add a few towels to improve tumbling and spin performance.

When washing the blanket or sheet

- The blanket must put below 3.5 kg and one sheet in washing machine. Rolling the blanket in a round shape reduces the unbalance.
- Rugs can bring unbalance and cannot be used. But when mixed well with other laundry, the weight center can be spread and can be used.

INFORMATION CODE

CODE	POSSIBLE CAUSES	WHAT TO DO
	<ul style="list-style-type: none">• Door is unlocked when washer is running.	<ul style="list-style-type: none">• Press the Power button to turn off your washer, then restart the cycle. If the code reappears, call for service.
	<ul style="list-style-type: none">• Door is open when washer is running.	<ul style="list-style-type: none">• Close the door tightly and restart the cycle. If the code reappears, call for service.
	<ul style="list-style-type: none">• Your washer has tried to fill but was unsuccessful due to clogged water lines or closed watervalves.	<ul style="list-style-type: none">• Make sure hot and cold water valves are open all the way. Check for kinked hoses.• Check the inlet screens on the fill hoses.
	<ul style="list-style-type: none">• Your washer is not draining.• It can also mean that the unit senses a small clog or frozen hose.	<ul style="list-style-type: none">• Fill the washer drum with 10 ℓ of water at the temperature of 140 °F for about 1 hour to defrost the ice.
	<ul style="list-style-type: none">• Unbalanced load prevented your washer from spinning.• When the weight of the laundry is about 1 kg, the center of the weight gets shifted.	<ul style="list-style-type: none">• Redistribute the load, press the Start/Pause button.• Add more laundry.
	<ul style="list-style-type: none">• To many suds are detected during the washing session.• The unit is put on hold until the suds are reduced. Then, the unit will go back to the operation. When it finishes washing, "End" and "SUDS" code will blink in turn.	<ul style="list-style-type: none">• Your washer is designed to use High Efficiency (HE) detergents. For best cleaning results only use High Efficiency detergents such as Tide HE, Wisk HE, CHeer HE, or Gain HE. High Efficiency detergent contain suds suppressors that reduce or eliminatesuds. When fewer suds are produced, the wash load tumblesmore efficiently and cleaning is maximized.

Code No. : DC68-02497A-02_EN

operating detergent instructions

DETERGENT USE

- Our washer is designed to use High Efficiency (HE) detergents. For best cleaning results only use High Efficiency detergents such as Tide HE, Wisk HE, CHeer HE, or Gain HE. High Efficiency detergents contain suds suppressors that reduce or eliminate suds.
- The dispenser automatically releases at the proper time.
- Use the softener compartment **ONLY** for fabric softeners.
- Do **NOT** use the thick liquid fabric softener. It will not add fabric softener at the appropriate time.
- Never pour undiluted liquid chlorine bleach directly onto clothes or wash load into the tub.
- Do **NOT** exceed the MAX FILL line.

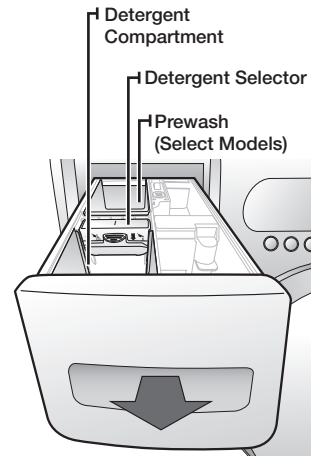
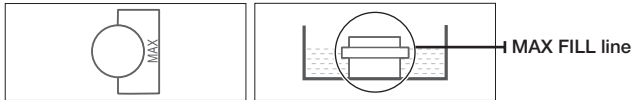

how to install

REMOVING THE SHIPPING BOLTS

Before using your washer, you must remove shipping bolts. If not, it causes excessive vibration.

1. Using wrench remove all **Four (4)** shipping bolts.
2. Install cap supplied from accessories.

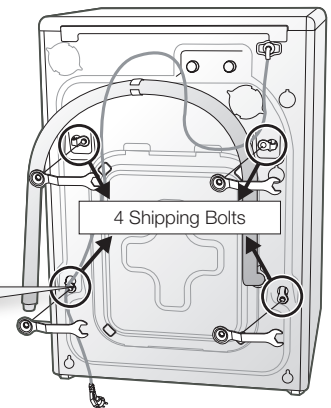
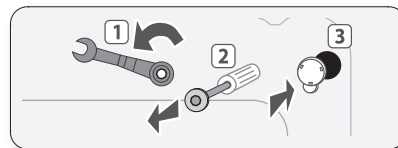

HOW TO LEVEL

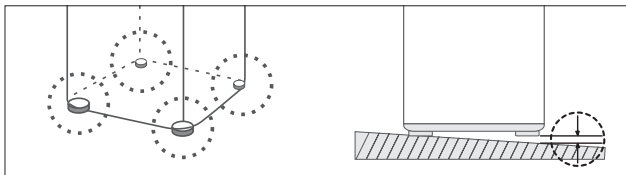

Your washer **MUST** be leveled on all four sides.

- The installation surface must be firm, dry and level.
- A carpenter's level should be used on all four corners of your washer.
- The unit should not wobble when it is pushed & pressed in all directions.

Avoid the damage of legs, do **NOT** move the washer unless the locking-nuts are fastened to the bottom of the washer.

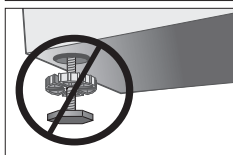
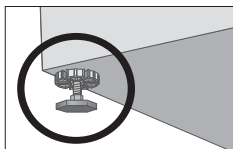

- 1 Locking nut
- 2 Leveling leg ASSY
- 3 Wrench/Spanner
- 4 Flat head screw driver

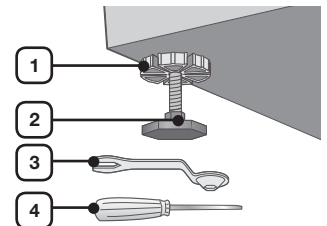

1. Level your washer by turning the leveling legs.

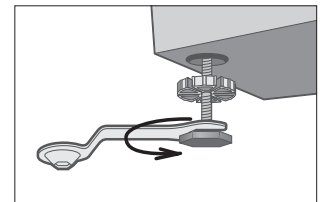

2. When your washer is level, tighten the nuts using the wrench or (-) to flat head screw driver.

