

RL1505SBASR

SAMSUNG

15 cu. ft. Counter-Depth Refrigerator



Signature Features

All-Around Cooling

- An All-Around Cooling system cools the entire fridge evenly from corner to corner. It continually checks the temperature and circulates cool air through strategically placed vents.

Counter-Depth Design

- Fits seamlessly with the surface of your kitchen for harmonious look.

Energy Star Certified

- Eco-friendly and energy-efficient.

Digital Inverter Compressor

- Automatically adjusts its speed in response to cooling demand across 7 levels. As a result, it's much quieter and uses up to 50% less power.

Available Colour



Stainless Steel



All-Around Cooling



Digital Inverter Compressor

Features

- 4 Shelves
- Counter-Depth
- Crisper
- 3 Drawer Dividers
- High Efficiency LED Lighting

Convenience

- CoolTight Door
- Door Alarm
- All-Around Cooling
- Temperature Control
- Power Freeze

Rating



ENERGY STAR® rated:
420 kWh/yr

RL1505SBASR

SAMSUNG

15 cu. ft. Counter-Depth Refrigerator

Installation Specifications

1. Measure the height, width and depth of the opening, making sure to include baseboards, molding tile, countertop overhang, etc. Check to be sure there is enough room to open the door (consider walls, islands or other obstacles when measuring).
2. Refer to illustration below to determine dimensions.
3. Allow 2" minimum clearance at rear for proper air circulation and water/electrical connections. Allow a 3/8" minimum clearance at sides and top for ease of installation.
4. Ensure each door and entryway in the home is wide enough for the refrigerator to be moved through easily.

For optimal usage and to be able to open refrigerator doors completely, do not install next to a wall.

Please note: The following dimension and cutout information is for planning purposes only. For complete installation details, consult manual packed with product, or download manual online at samsung.com.

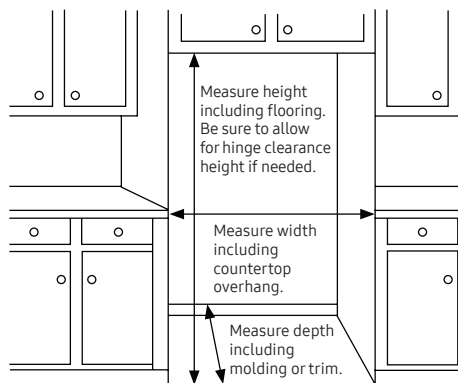

Dimensions

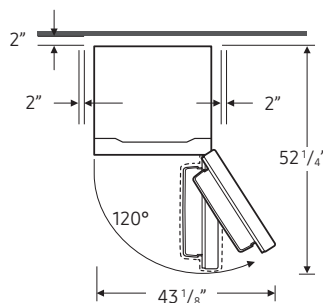
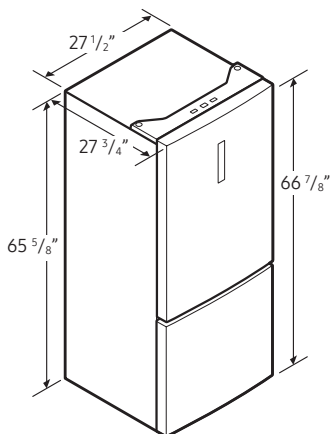

Total Capacity: 15 cu. ft.

Refrigerator: 10.6 cu. ft.

- 2 Humidity-Controlled Crispers
- 4 Tempered Glass Spill-Proof Shelves
- 4 Fixed Shelves
- 5 Door Bins
 - Right Door: 1 Gallon Bin
- High Efficiency LED Lighting

Freezer: 4.4 cu. ft.

- 3 Drawer Dividers
- High Efficiency LED Lighting

Warranty

One (1) Year Parts and Labour on Refrigerator
Ten (10) Years Parts on Digital Inverter Compressor

Product Dimensions & Weight (WxHxD)

Dimensions (WxHxD with hinges, handles and doors):

27 1/2" x 66 7/8" x 27 3/4"

Dimensions (WxHxD without hinges and door):

27 1/2" x 65 5/8" x 24 1/4"

Dimensions (WxHxD with hinge and door, no handle):

27 1/2" x 66 7/8" x 27 3/4"

Weight: 165 lbs (75 Kg)

Shipping Dimensions & Weight (WxHxD)

Dimensions: 30 5/8" x 70 7/8" x 29 3/4"

Weight: 181 lbs (82 Kg)

Colour

Stainless Steel

Model

RL1505SBASR

UPC Code

887276419862